

## Kupplungen

**Achskupplungen (starr)**  
**Werkstoff:** MS, verzinkt

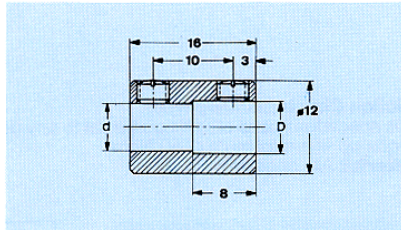
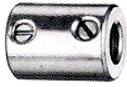

## Couplings Accouplements

**Shaft Couplings (rigid)**  
**Material:** brass, galvanized

$\varnothing D$	$\varnothing d$	Gewicht Weight	Art.-Nr.
6	6	10 gr.	720.6
4	4	12 gr.	720.4
6	4	11 gr.	720.64

## Klemm-Kupplungen

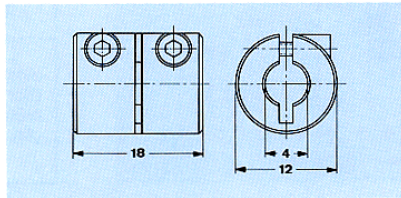
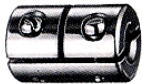

## Clamp-Type Couplings

Drehmoment Torque	Gewicht Weight	Art.-Nr.
100 Ncm	11 gr.	751.44

Werkstoff: MS vernickelt  
 Material: MS nickel-plated

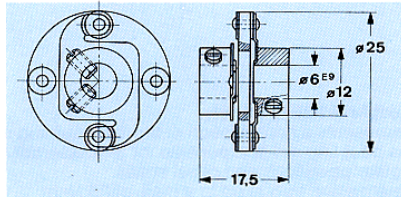

Prüfspannung: Test voltage:	Gewicht Weight	Art.-Nr.
2 KV/50 Hz	13 gr.	725

isolierendes Zwischenstück, max. Übertragungsdrehmoment 70 Ncm,  
 max. 4 °Winkelabweichung  
 insulating insert

## Verlängerungsachsen

Isolierte Ausführung aus **Hart-PVC**. In begrenztem Maße flexibel.

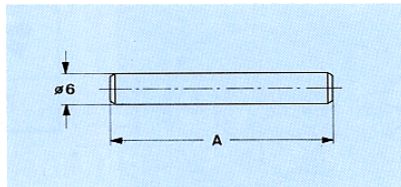

## Extension Shafts

Insulated type made of **rigid PVC**. Limited flexibility.

A	Gewicht Weight	Art.-Nr.
60	2,5 gr.	724.11
80	3,5 gr.	724.21
100	4 gr.	724.31
120	5 gr.	724.41

## Reduzierrohr

**Material:** Messing, verzinkt

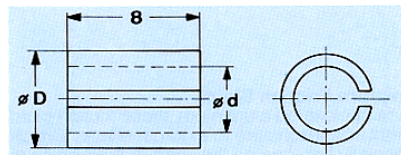

## Reducing Sleeve

**Material:** brass, galvanized

$\varnothing D$	$\varnothing d$	Gewicht Weight	Art.-Nr.
6	4	1 gr.	640
4	3	0,8 gr.	6.640.1431

## Achsdurchführung, Ms. vernickelt

Zeichnet sich durch besonders einfache Montage aus.

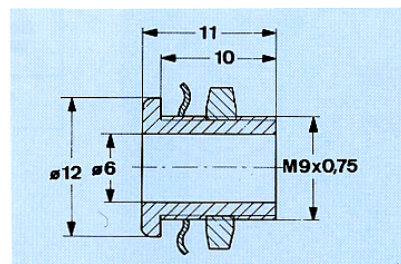

## Shaft Lead-Through, Ms. nickel-plated

Distinguished for especially simple installation.

Gewicht Weight	Art.-Nr.
5 gr.	729

Sechskantmutter SW 14  
 Hexagonal nut SW 14