

	Schnecken eingängig rechts, brüniert						
	Stahl / Steel C45						
	Modul	dk	do	ls	L	N	B
	0,5	8	7	12	16	5,5	3 H7

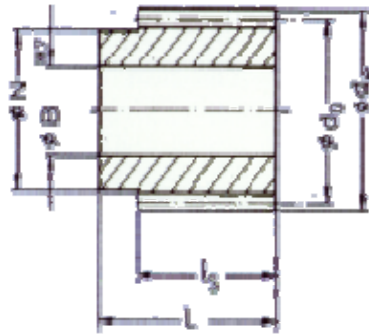

	Schneckenrad						
	Messing / Brass M 58						
	Modul	SP	OP	Z	b	L	N
275169	0,5	11,4	10	20	3	8	8
275170	0,5	21,5	20	40	3	8	8
275171	0,5	31,5	30	60	3	8	8

mit Stellschraube M3

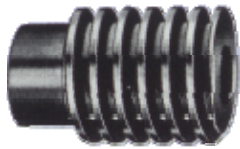
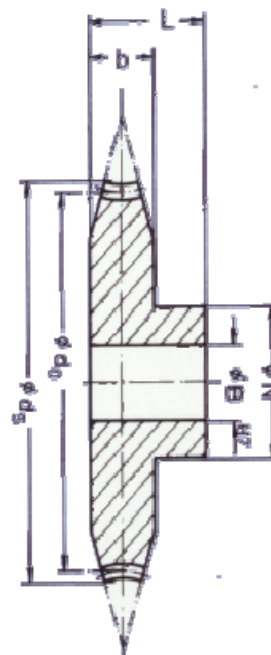
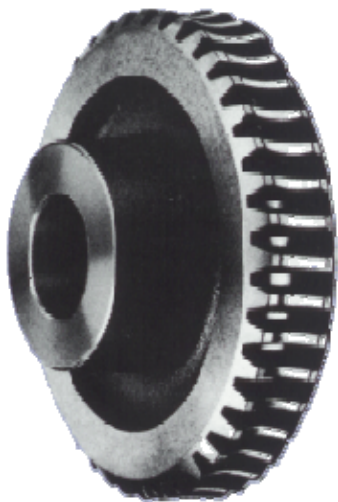

B H7	
3	
4	
4	