

## Datenblatt / Data Sheet

**CREE® XM-L RGBW auf Starplatine**  
**CREE® XM-L RGBW on Star board**

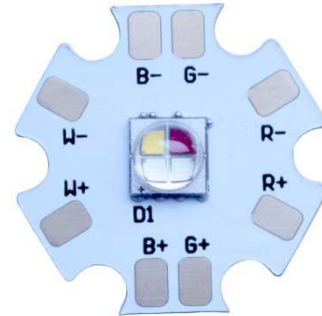

### Technische Daten / Technical data

Bezeichnung / Description	Eigenschaften / Characteristics
CE Artikelnummer / CE item no.	<b>405462</b>
Artikelnummer Hersteller / Producer item no.	<b>61002026</b>
Lichtfarbe / Light colour	rot - grün - blau - neutralweiß red - green - blue - neutral white
Min. Lichtstrom @ 350mA / Min. luminous flux @ 350mA	46lm - 87lm - 14lm - 80lm
Betriebsstrom / Operating current	350-1000mA (per die)
Typ. Vorwärtsspannung / Typ. forward voltage	2.25V - 3.3V - 3.1V - 3.1V
Max. Vorwärtsspannung / Max. forward voltage	2.6V - 3.9V - 3.7V - 3.7V
Wärmewiderstand / Thermal resistance	3.5°C/W
Max. Sperrschichttemperatur / Max. junction temperature	150°C
Abstrahlwinkel / Beam angle	130°
Abmessungen $\phi \times H$ / Dimensions $\phi \times H$	19.9 x 6.5mm
Bemerkung / Note	<b>LED muss gekühlt werden - unzureichende Kühlung führt zum Defekt!</b> <b>LED has to be cooled - insufficient cooling destroys the LED!</b>

Absolute Höchstwerte bei Ta=25° / Absolute maximum values at Ta=25°



### Abmessungen Platine / Board dimensions

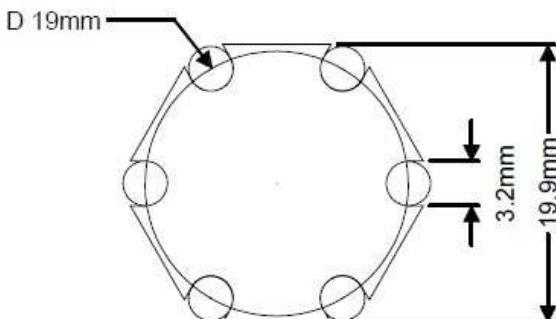

### Abmessungen CREE XM-L / Dimensions CREE XM-L

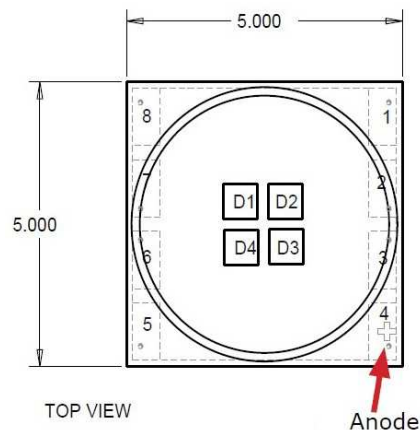

**RELATIVE SPECTRAL POWER DISTRIBUTION ( $I_F = 350 \text{ mA PER LED DIE, } 25 \text{ }^\circ\text{C}$ )**

The following graph represents typical spectral output of the XLamp XM-L Color LED with each LED die on independently.

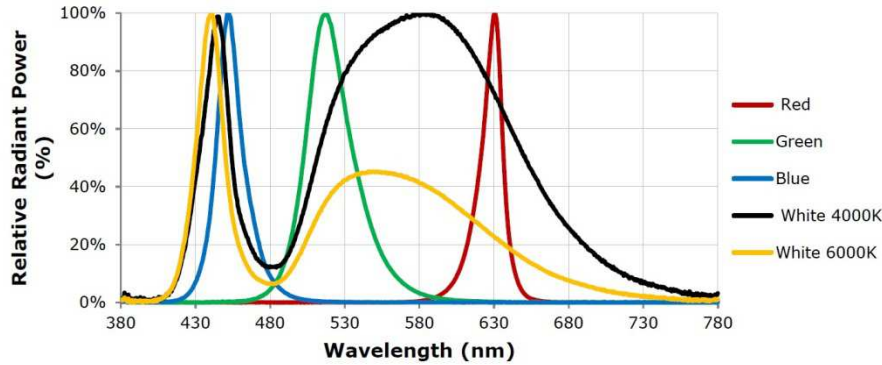

**RELATIVE FLUX VS. CURRENT ( $T_j = 25 \text{ }^\circ\text{C}$ )**

The following graph represents typical performance of each LED die in the XLamp XM-L Color LED.

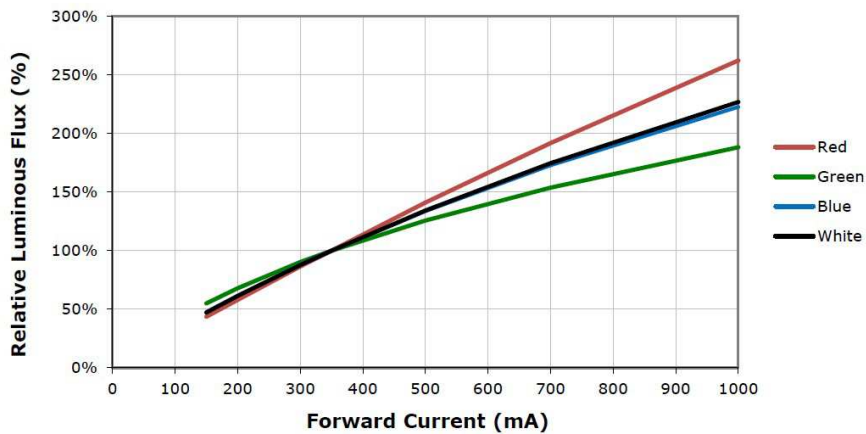

**TYPICAL SPATIAL DISTRIBUTION**

The following graph represents typical output of the XLamp XM-L Color LED with all four LEDs on simultaneously.

