

# Lötösen

# Cosses à souder

# Soldering tags

Werkstoff:

MS = Messing

Oberflächenbehandlung:

- bl = blank (0)
- ag = versilbert (1)
- au = vergoldet (2)
- ni = vernickelt (5)
- sn = verzinkt (8)

Bestellbeispiel:

Exemple de commande: 2500.61  
 Example of order: (2500 MS ag)

Matière:

MS = laiton

Traitements de surface:

- bl = brut (0)
- ag = argenté (1)
- au = doré (2)
- ni = nickelé (5)
- sn = étamé (8)

Material:

MS = brass

Surface-plating:

- bl = clean (0)
- ag = silver-plated (1)
- au = gold-plated (2)
- ni = nickel-plated (5)
- sn = tin-plated (8)

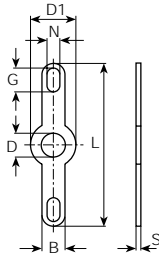

D mm	L mm	D1 mm	B mm	N mm	G mm	S mm	Werkstoff Matière Material	Stand.- Packg.	DIN 41496	Artikel-Nr. Numéro d'article Part-No.
2.2	18	4.5	3	1.7	3.2	0.4	MS	5000	A2-2	2500.6( )
2.6	18.5	5.5	3	1.4	2.5	0.3	MS	5000		2501.6( )
3.1	18.5	6	3	1.5	3	0.4	MS	5000		2521.6( )
3.2	18	5.9	3	1.5	3	0.3	MS	5000		2502.6( )
	22	6	3	1.7	3.2	0.3	MS	5000		2512.6( )
	24	5.5	3	1.7	3.2	0.5	MS	2000	A2-3	2504.6( )
	26	6.3	3	1.5	2.5	0.4	MS	2000		2506.6( )
	32.4	6	3	1.5	2.5	0.3	MS	2000		2508.6( )
3.7	22	6	3	1.7	3.2	0.3	MS	5000		2514.6( )
4.2	18	5.5	2.6	1.5	3	0.3	MS	5000		2503.6( )
4.3	22	6	3	1.7	3.2	0.3	MS	5000		2516.6( )
	24	6.5	3	1.7	3.2	0.5	MS	2000	A2-4	2505.6( )
	32.4	6	3	1.5	3	0.3	MS	2000		2509.6( )
5.3	30	10	3	1.7	3.2	0.5	MS	2000		2518.6( )
6.4	30	10	3	1.7	3.2	0.5	MS	2000		2519.6( )
7.3	30	10	3	1.7	3.2	0.5	MS	2000		2520.6( )

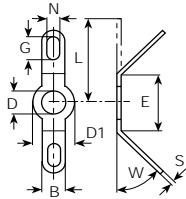

45°											
D mm	W	L mm	E mm	D1 mm	B mm	N mm	G mm	S mm	Werkstoff Matière Material	Stand.- Packg.	Artikel-Nr. Numéro d'article Part-No.
3.1	45°	9.2	5.7	6	3	1.5	3	0.4	MS	5000	252145.6( )
3.2	45°	12	7.5	5.5	3	1.7	3.2	0.5	MS	2000	250445.6( )

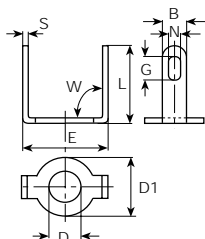

90°											
D mm	W	L mm	E mm	D1 mm	B mm	N mm	G mm	S mm	Werkstoff Matière Material	Stand.- Packg.	Artikel-Nr. Numéro d'article Part-No.
2.2	90°	6	7.2	4.5	3	1.7	3.2	0.4	MS	5000	250790.6( )
3.1	90°	6.8	6.5	6	3	1.5	3	0.4	MS	5000	252190.6( )
3.2	90°	6	7.5	5.9	3	1.7	3.2	0.3	MS	5000	250290.6( )