

## 2- und 3-polig, IP 66

### Fronteinbau 4-Loch-Befestigung



2-/3-polig



2-polig



3-polig



4-Loch (standard)

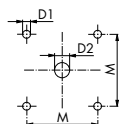

2-Loch (alternativ)  
Nicht für Frontschild 48 x 48

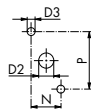

KG10A-KG64B

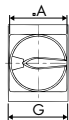
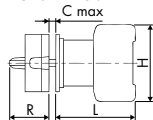

KG80-KG315

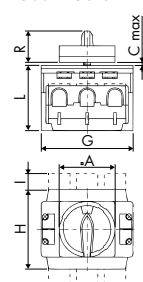

Dauerstrom (I <sub>n</sub> /I <sub>th</sub> )	Schaltleistung AC-23B (A)	Frontschild	Artikelnummer	ab Lager lieferbar
<b>2-polig 230 V</b>				
20 A	1,5 kW	48 x 48 64 x 64	KG10A T202/01 E KG10B T202/01 E	●
<b>3-polig 3 x 400 V</b>				
20 A	5,5 kW	48 x 48 64 x 64	KG10A T203/01 E KG10B T203/01 E	●
25 A	7,5 kW	48 x 48 64 x 64	KG20A T203/01 E KG20B T203/01 E	●
32 A	11 kW	48 x 48 64 x 64	KG32A T203/01 E KG32B T203/01 E	●
40 A	15 kW	48 x 48 64 x 64	KG41 T203/01 E KG41B T203/01 E	●
63 A	22 kW	48 x 48 64 x 64	KG64 T203/01 E KG64B T203/01 E	●
80 A	30 kW	64 x 64 88 x 88	KG80 T203/01 E KG80C T203/01 E	●
100 A	37 kW	64 x 64 88 x 88	KG100 T203/01 E KG100C T203/01 E	●
125 A	45 kW	88 x 88	KG125 T203/01 E	●
160 A	55 kW	88 x 88	KG160 T203/01 E	●

Dauerstrom (I <sub>n</sub> /I <sub>th</sub> )	Schaltleistung AC-23B (A)	Frontschild	Artikelnummer	ab Lager lieferbar
<b>2-polig 230 V</b>				
20 A	1,5 kW	48 x 48 64 x 64	KG10A T102/01 E KG10B T102/01 E	●
<b>3-polig 3 x 400 V</b>				
20 A	5,5 kW	48 x 48 64 x 64	KG10A T103/01 E KG10B T103/01 E	●
25 A	7,5 kW	48 x 48 64 x 64	KG20A T103/01 E KG20B T103/01 E	●
32 A	11 kW	48 x 48 64 x 64	KG32A T103/01 E KG32B T103/01 E	●
40 A	15 kW	48 x 48 64 x 64	KG41 T103/01 E KG41B T103/01 E	●
63 A	22 kW	48 x 48 64 x 64	KG64 T103/01 E KG64B T103/01 E	●
80 A	30 kW	64 x 64 88 x 88	KG80 T103/01 E KG80C T103/01 E	●
100 A	37 kW	64 x 64 88 x 88	KG100 T103/01 E KG100C T103/01 E	●
125 A	45 kW	88 x 88	KG125 T103/01 E	●
160 A	55 kW	88 x 88	KG160 T103/01 E	●

Frontschild	Bügel-Ø	Anzahl Schösser
48 x 48	4	2
64 x 64	8	1
88 x 88	10	3

	Schalter						Lochbild						
	A	C	G	H	I	L	R	M	N	P	D1	D2	D3
KG10A 2-polig	48	4	48	50		38,7	33	36	12,2	30	5	11-15	3,5
KG10A 3-polig	48	4	48	50		48,2	33	36	12,2	30	5	11-15	3,5
KG10B 2-polig	64	4	48	50		45,7	40,1	48	12,2	30	5	11-15	3,5
KG10B 3-polig	64	4	48	50		55,2	40,1	48	12,2	30	5	11-15	3,5
KG20A, KG32A	48	4	42	54		53,8	33	36	12,2	30	5	10	3,5
KG20B, KG32B	64	4	42	54		53,8	40,1	48	12,2	30	5	10	3,5
KG41, KG64	48	4	50	64		60,5	33	36			5	10	
KG41B, KG64B	64	4	50	64		60,5	40,1	48	12,2	30 <sup>2</sup>	5	10	3,5 <sup>3</sup>
KG80, KG100	64	4	70	80	26	70,6	40,1	48	14	37	5	10	4,5
KG80C, KG100C	88	4	70	80	26	70,6	49,3	68	14	37	6	10	4,5
KG125, KG160	88	5,5	112	108	22,2	96	49,3	68			6	13	

<sup>1</sup> KG64B = 14, <sup>2</sup> KG64B = 37, <sup>3</sup> KG64B = 4,5

Informationen zu KG-Schaltern mit Bolzenanschlüssen finden Sie auf Seite 37.

< Zurück zum Kapitelverzeichnis >

