

RACON 12, Typischer Systemaufbau unter Folie mit Stößel

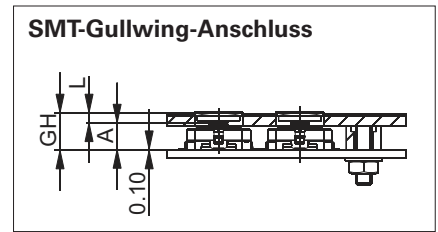

Variable	Erklärung	THT-Anschluss außenliegend	THT-Anschluss innenliegend	SMT-Anschluss
A	Tasterhöhe		A = 4,95 +/- 0,1 mm	
GH	Gesamthöhe		GH = A + L	GH = A + L + 0,1 mm
L	Stößellänge		L = GH - A	L = GH - A - 0,1 mm

RACON 12, Leiterplatten-Bilder, minimales Raster

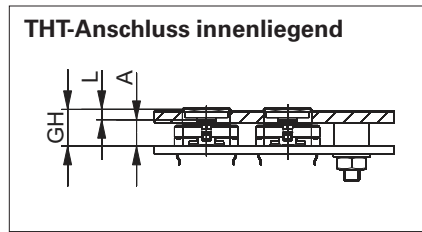
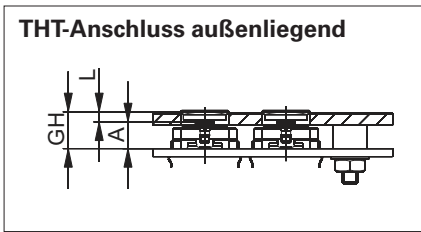
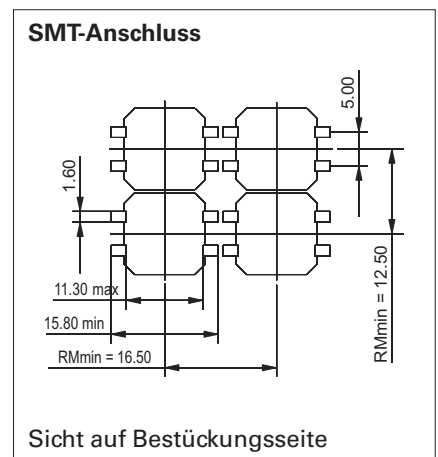
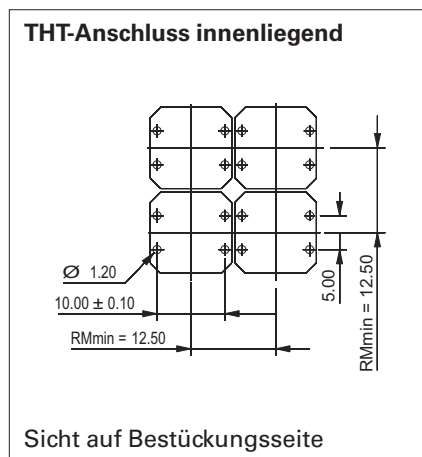
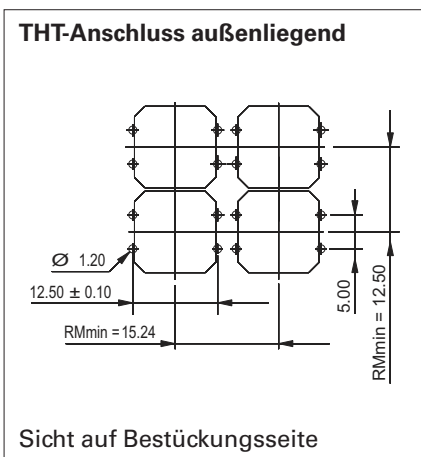

RACON 12, SMT-Anschluss, Lage im Blistergurt

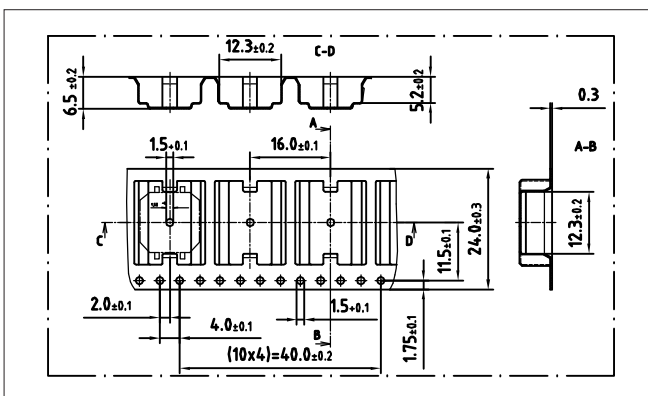

Schaltplan RACON 12

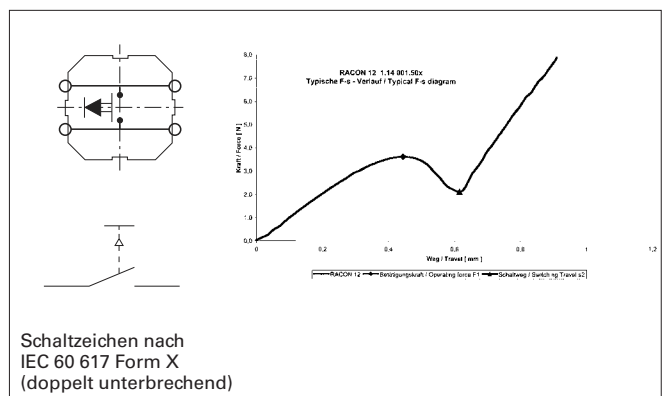

Typisches Kraft-Weg Diagramm