

2- und 3-polig, IP 66

Fronteinbau 4-Loch-Befestigung



2-/3-polig



2-polig



3-polig



4-Loch (standard)

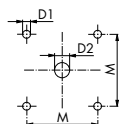

2-Loch (alternativ)
Nicht für Frontschild 48 x 48

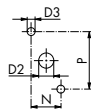

KG10A-KG64B

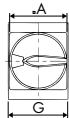
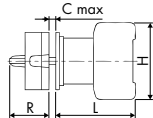

KG80-KG315

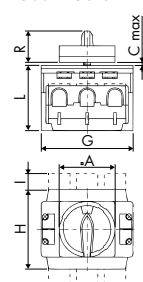

| Dauerstrom (I _n /I _{th}) | Schaltleistung AC-23B (A) | Frontschild | Artikelnummer | ab Lager lieferbar |
|---|---------------------------|--------------------|-------------------------------------|--------------------|
| 2-polig 230 V | | | | |
| 20 A | 1,5 kW | 48 x 48 64 x 64 | KG10A T202/01 E KG10B T202/01 E | ● |
| 3-polig 3 x 400 V | | | | |
| 20 A | 5,5 kW | 48 x 48 64 x 64 | KG10A T203/01 E KG10B T203/01 E | ● |
| 25 A | 7,5 kW | 48 x 48 64 x 64 | KG20A T203/01 E KG20B T203/01 E | ● |
| 32 A | 11 kW | 48 x 48 64 x 64 | KG32A T203/01 E KG32B T203/01 E | ● |
| 40 A | 15 kW | 48 x 48 64 x 64 | KG41 T203/01 E KG41B T203/01 E | ● |
| 63 A | 22 kW | 48 x 48 64 x 64 | KG64 T203/01 E KG64B T203/01 E | ● |
| 80 A | 30 kW | 64 x 64 88 x 88 | KG80 T203/01 E KG80C T203/01 E | ● |
| 100 A | 37 kW | 64 x 64 88 x 88 | KG100 T203/01 E KG100C T203/01 E | ● |
| 125 A | 45 kW | 88 x 88 | KG125 T203/01 E | ● |
| 160 A | 55 kW | 88 x 88 | KG160 T203/01 E | ● |

| Dauerstrom (I _n /I _{th}) | Schaltleistung AC-23B (A) | Frontschild | Artikelnummer | ab Lager lieferbar |
|---|---------------------------|--------------------|-------------------------------------|--------------------|
| 2-polig 230 V | | | | |
| 20 A | 1,5 kW | 48 x 48 64 x 64 | KG10A T102/01 E KG10B T102/01 E | ● |
| 3-polig 3 x 400 V | | | | |
| 20 A | 5,5 kW | 48 x 48 64 x 64 | KG10A T103/01 E KG10B T103/01 E | ● |
| 25 A | 7,5 kW | 48 x 48 64 x 64 | KG20A T103/01 E KG20B T103/01 E | ● |
| 32 A | 11 kW | 48 x 48 64 x 64 | KG32A T103/01 E KG32B T103/01 E | ● |
| 40 A | 15 kW | 48 x 48 64 x 64 | KG41 T103/01 E KG41B T103/01 E | ● |
| 63 A | 22 kW | 48 x 48 64 x 64 | KG64 T103/01 E KG64B T103/01 E | ● |
| 80 A | 30 kW | 64 x 64 88 x 88 | KG80 T103/01 E KG80C T103/01 E | ● |
| 100 A | 37 kW | 64 x 64 88 x 88 | KG100 T103/01 E KG100C T103/01 E | ● |
| 125 A | 45 kW | 88 x 88 | KG125 T103/01 E | ● |
| 160 A | 55 kW | 88 x 88 | KG160 T103/01 E | ● |

| Frontschild | Maximale Anzahl Vorhängeschlösser | |
|-------------|-----------------------------------|------------------|
| | Bügel-Ø | Anzahl Schlösser |
| 48 x 48 | 4 | 2 |
| 64 x 64 | 8 | 1 |
| 88 x 88 | 9 | 3 |

| | Schalter | | | | | | Lochbild | | | | | | |
|---------------|----------|-----|-----|-----|------|------|----------|----|------|-----------------|----|-------|------------------|
| | A | C | G | H | I | L | R | M | N | P | D1 | D2 | D3 |
| KG10A 2-polig | 48 | 4 | 48 | 50 | | 38,7 | 33 | 36 | 12,2 | 30 | 5 | 11-15 | 3,5 |
| KG10A 3-polig | 48 | 4 | 48 | 50 | | 48,2 | 33 | 36 | 12,2 | 30 | 5 | 11-15 | 3,5 |
| KG10B 2-polig | 64 | 4 | 48 | 50 | | 45,7 | 40,1 | 48 | 12,2 | 30 | 5 | 11-15 | 3,5 |
| KG10B 3-polig | 64 | 4 | 48 | 50 | | 55,2 | 40,1 | 48 | 12,2 | 30 | 5 | 11-15 | 3,5 |
| KG20A, KG32A | 48 | 4 | 42 | 54 | | 53,8 | 33 | 36 | 12,2 | 30 | 5 | 10 | 3,5 |
| KG20B, KG32B | 64 | 4 | 42 | 54 | | 53,8 | 40,1 | 48 | 12,2 | 30 | 5 | 10 | 3,5 |
| KG41, KG64 | 48 | 4 | 50 | 64 | | 60,5 | 33 | 36 | | | 5 | 10 | |
| KG41B, KG64B | 64 | 4 | 50 | 64 | | 60,5 | 40,1 | 48 | 12,2 | 30 ² | 5 | 10 | 3,5 ³ |
| KG80, KG100 | 64 | 4 | 70 | 80 | 26 | 70,6 | 40,1 | 48 | 14 | 37 | 5 | 10 | 4,5 |
| KG80C, KG100C | 88 | 4 | 70 | 80 | 26 | 70,6 | 49,3 | 68 | 14 | 37 | 6 | 10 | 4,5 |
| KG125, KG160 | 88 | 5,5 | 112 | 108 | 22,2 | 96 | 49,3 | 68 | | | 6 | 13 | |

¹ KG64B = 14, ² KG64B = 37, ³ KG64B = 4,5

Informationen zu KG-Schaltern mit Bolzenanschlüssen finden Sie auf Seite 37.

< Zurück zum Kapitelverzeichnis >

