

## Flachsteckhülsen

DIN 46247, Teil 3  
DIN 46340, Teil 3 zum Einrasten in Tüllen

## Clips femelles plats

DIN 46247, partie 3  
DIN 46340, partie 3 pour encliqueter dans des boîtiers

## Flat receptacles

DIN 46247, part 3  
DIN 46340, part 3 to engage in housings

# 6,3 mm

Werkstoff:  
BZ = Bronze  
MS = Messing  
ST = Stahl

Matière:  
BZ = bronze  
MS = laiton  
ST = acier

Material:  
BZ = bronze  
MS = brass  
ST = steel

Strombelastbarkeit:  
0.5 - 1.0 mm<sup>2</sup> / 10 A max.  
1.5 - 2.5 mm<sup>2</sup> / 15 A max.  
4.0 - 6.0 mm<sup>2</sup> / 25 A max.

Intensité admissible:  
0.5 - 1.0 mm<sup>2</sup> / 10 A max.  
1.5 - 2.5 mm<sup>2</sup> / 15 A max.  
4.0 - 6.0 mm<sup>2</sup> / 25 A max.

Current carrying capacity:  
0.5 - 1.0 mm<sup>2</sup> / 10 A max.  
1.5 - 2.5 mm<sup>2</sup> / 15 A max.  
4.0 - 6.0 mm<sup>2</sup> / 25 A max.

Oberflächenbehandlung: Code  
bl = blank (0)  
ag = versilbert (1)  
au = vergoldet (2)  
ni = vernickelt (5)  
sn = reinverzinkt (7)

Traitements de surface: Code  
bl = brut (0)  
ag = argenté (1)  
au = doré (2)  
ni = nickelé (5)  
sn = étamage pur (7)

Surface-plating: Code  
bl = clean (0)  
ag = silver-plated (1)  
au = gold-plated (2)  
ni = nickel plated (5)  
sn = pure tin-plated (7)

Bestellbeispiel:  
Exemple de commande:  
Example of order:

3831.67  
(3831 MS sn)

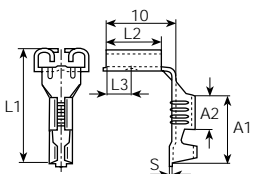
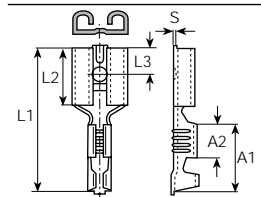
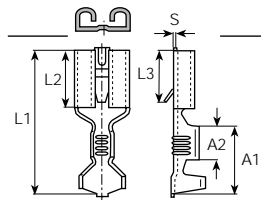
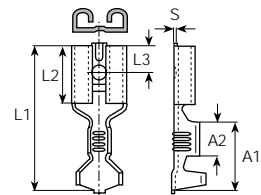

mm <sup>2</sup> (AWG)	für Steckungen pour languettes for tabs	Artikel-Nr. Numéro d'article Part-No.	DIN	L1 mm	L2 mm	L3 mm	A1 mm	A2 mm	S mm	Stand- Packg	Werkzeuge Outils Tools
0.5-1 (22-18)	6.3 x 0.8	3831.6( ) MS	46247/T3	19	7.5	4	9	4.5	0.45	1000	3988N 3984A
	6.3 x 0.8	3831.95 ST ni	46247/T3	19	7.5	4	9	4.5	0.45	1000	
0.5-1.5 (22-16)	6.3 x 0.8	3832.6( ) MS	46247/T3	19	7.5	4	9	4.5	0.45	1000	3988N 3984A
	6.3 x 0.8	3832.95 ST ni	46247/T3	19	7.5	4	9	4.5	0.45	1000	
1-2.5 (18-14)	6.3 x 0.8	3833.27 BZ sn	46247/T3	19	7.5	4	8.5	4	0.4	1000	3975C
	6.3 x 0.8	3833.6( ) MS	46247/T3	19	7.5	4	8.5	4	0.4	1000	3988N
	6.3 x 0.8	3833.95 ST ni	46247/T3	19	7.5	4	8.5	4	0.4	1000	3984A
4-6 (12-10)	6.3 x 0.8	3835A.67 MS sn	46247/T3	19	7.5	4	9	4.5	0.45	500	3975C
	6.3 x 0.8	3835.95 St ni	46247/T3	19	7.5	4	9	4.5	0.45	500	3988N 3984B
1.5-2.5 (16-14)	6.3 x 0.8	3832D.6( ) MS	46340/T3	19	7.5	7.3	8.5	4	0.4	1000	3975C 3988N 3984A
4-6 (12-10)	6.3 x 0.8	3835.6( ) MS	46247/T3	19	7.5	4	9	4.5	0.45	500	3975C 3988N 3984A
0.5-1 (22-18)	6.3 x 0.8	3832W.6( ) MS		15.2	7.5	4	9	4.5	0.45	1000	3988N 3984A
1.5-2.5 (16-14)	6.3 x 0.8	3833W.6( ) MS		15.2	7.5	4	9	4.5	0.45	1000	3975C 3988N 3984A