

## Flachsteckhülsen in Bandform

DIN 46247, Teil 3 / DIN 46346, Form A

## Clips femelles plats en bande

DIN 46247, partie 3 / DIN 46346, form A

## Flat receptacles in chain form

DIN 46247, part 3 / DIN 46346, form A

6,3 mm

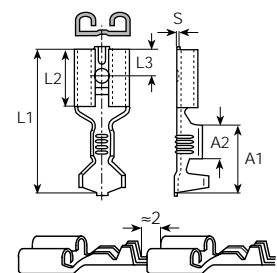

mm <sup>2</sup>	(AWG)	für Steckungen pour languettes for tabs	Artikel-Nr. Numéro d'article Part-No.	DIN	L1 mm	L2 mm	L3 mm	A1 mm	A2 mm	S mm	Rolle Bobine Reel
0.5-1	(22-18)	6.3 x 0.8	38310.6( ) MS	46247/T3	19	7.5	4	9	4.5	0.45	à 8'000
1-2.5	(18-14)	6.3 x 0.8	38330.6( ) MS	46247/T3	19	7.5	4	8.5	4	0.4	à 7'000
0.5-1	(22-18)	6.3 x 0.8	38372.6( ) MS	46346/A	12.5	7.4	4	11	3.5	0.38	à 3'500

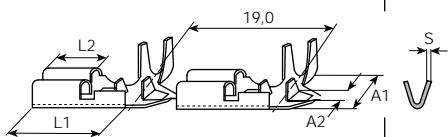

Crimpresse und Applikator auf Anfrage  
Presse automatique et outils sur demande  
Automatic applicator and dies on request

## Steckzungen

DIN 46248, Teil 3, Form A

## Languettes

DIN 46248, partie 3, form A

## Tabs

DIN 46248, part 3, form A

6,3 mm

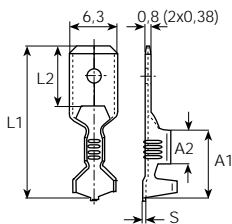

mm <sup>2</sup>	(AWG)	für Flachsteckhülsen pour clip femelle plat for flat receptacles	Artikel-Nr. Numéro d'article Part-No.	DIN	L1 mm	L2 mm	A1 mm	A2 mm	S mm	Stand- Packg	Werkzeuge Outils Tools
0.5-1	(22-18)	6.3 x 0.8	3836A.6( ) MS	46248/T3	20	8	8.5	4.6	0.38	1000	3984A 3988N
1.5-2.5	(16-14)	6.3 x 0.8	3836B.6( ) MS	46248/T3	20	8	8.5	4.6	0.38	1000	3975C 3984A 3988N
4-6	(12-10)	6.3 x 0.8	3836C.6( ) MS	46248/T3	20	8	8.5	4.6	0.38	500	3975C 3984B 3988N