









MONTAGEANLEITUNG

-  MONTAGEANLEITUNG
-  ASSEMBLY INSTRUCTION
-  DE INSTRUCTIE VAN DE ASSEMBLAGE
-  ISTRUZIONE DELL'ASSEMBLEA
-  INSTRUCCIÓN DE ASAMBLEA
-  INSTRUCTION DE MONTAGE
-  NÁVOD K MONTÁŽI
-  MONTERINGSANVISNING

-  MONTAJ TALIMATI
-  ASENNUSOHJE
-  BRUGSANVISNING
-  BRUKSANVISNING
-  UPUTE ZA MONTAŽU
-  NAVODILA ZA MONTAŽO
-  SZERELÉSI ÚTMUTATÓ
-  INSTRUCTIUNI DE MONTAJ



Modell-Nr.

12040

ART.-NR. FRONT KORPUS

12041  Silber

12042  Silber

12044  Silber

12047  Silber

12046   Schwarz

Friedrich Küpper GmbH
Friedrich-Küpper-Weg
54570 Berlingen
Deutschland

Telefon +49 (0) 65 91 - 95 42 0
Telefax +49 (0) 65 91 - 95 42 17
E-Mail info@friedrich-kuepper-gmbh.de
Internet www.friedrich-kuepper-gmbh.de

INZELTEILE / PIECES

(A)
1x
 772 mm x 475 mm



(C)
1x
 1057 mm x 473 mm



(B)
1x
 772 mm x 475 mm



(D)
1x
 1057 mm x 473 mm



(F)
1x
 645 mm x 450 mm



(E)
1x
 985 mm x 480 mm



(K)
1x
 403 mm x 468 mm



(Y)
1x
 1200 mm x 600 mm



(L)
1x
 400 mm x 25 mm

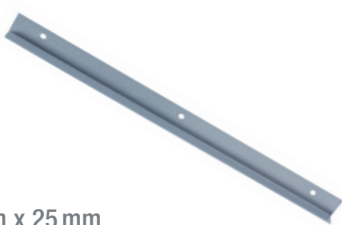

(J)
5x
 450 mm x 120 mm



(X)
5x
 450 mm x 20 mm



(H)
5x
 450 mm x 445 mm



(I)
5x
 470 mm x 130 mm



BEUTELINHALT / BAG CONTENT

 6x 5,5x 19 mm	 10x KU 4 x 16 mm	 18x M5 x 10 mm	 18x ø 5,3 mm	 18x M5	 40x M4 x 10 mm
 40x M4	 1x M6 x 16 mm	 1x ø 6,4 mm	 1x M6	 1x 6 x 12 mm	 1x
 1x	 1x	 4x	 4x	 4x M8	 5x

BENÖTIGTES WERKZEUG / NEEDED TOOLS

 1 PH 1 x 100 PH 2 x 100 Schlitz 6,5 x 150	 2 SW 7 SW 8 SW 10	 3 4 mm
 4	 5	 6 5 mm
 7	 8	

1.



2. WICHTIG / IMPORTANT



3.  2x M5  2x M5 x 10  2x 5,3MM

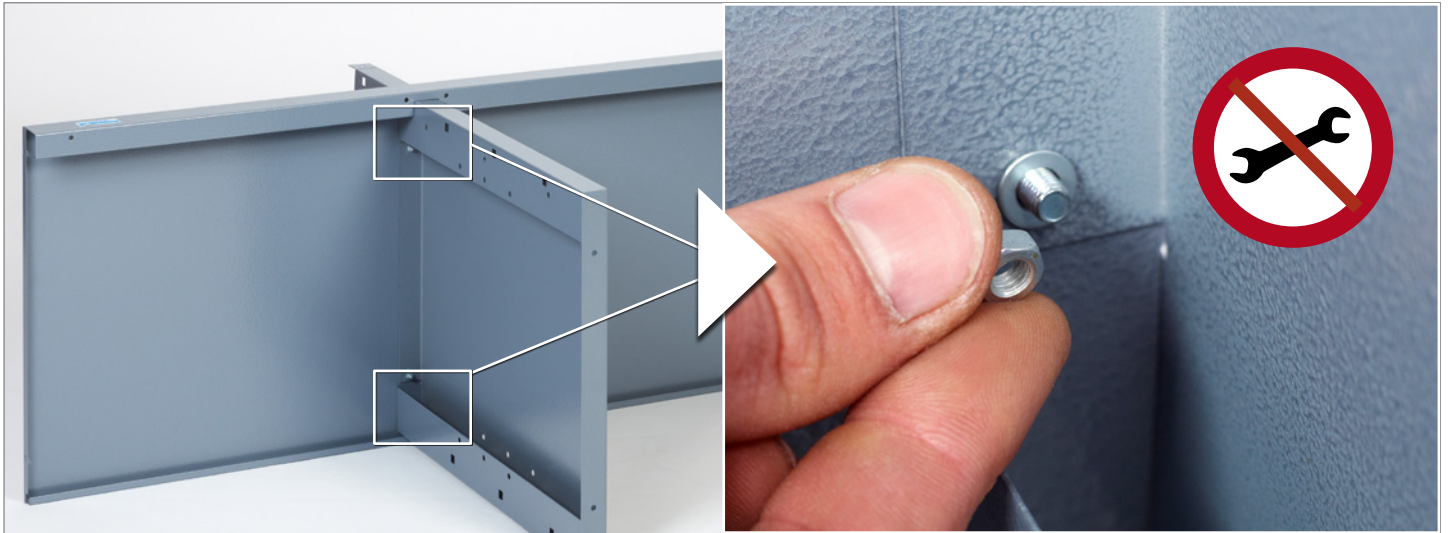

4.



5.  2x M5  2x M5 x 10  2x 5,3MM  ② SW 8  ① PH 2 X 100



6.



7.

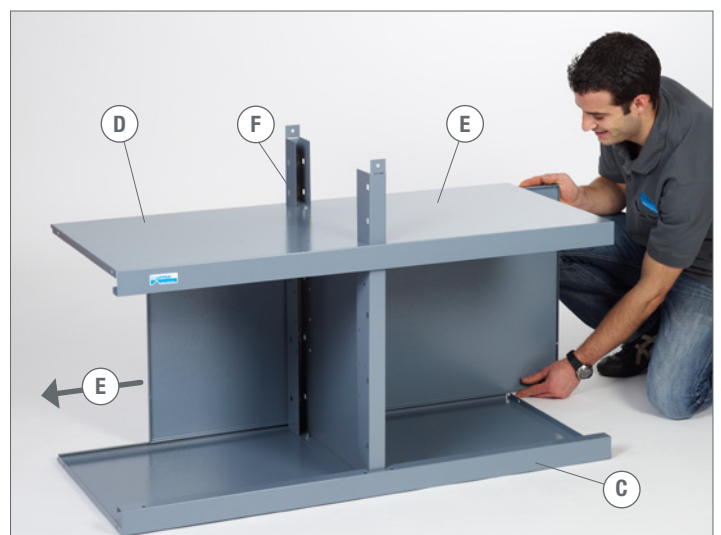

ZU SCHRITT 4. / IN ADDITION TO STEP 4.

②  SW 8 ①  PH 2x100

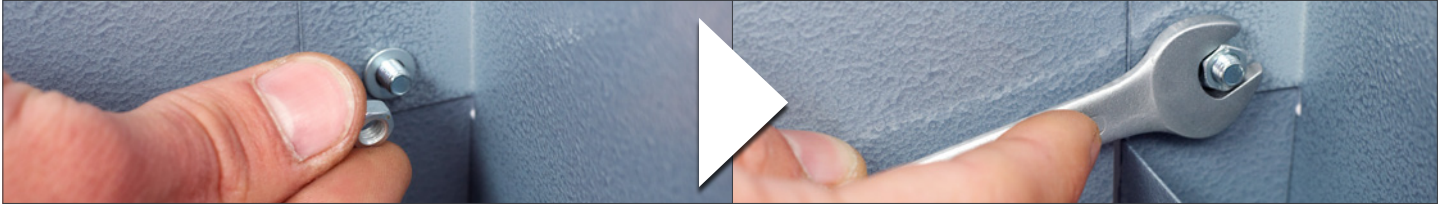

8. WICHTIG / IMPORTANT



9. WICHTIG / IMPORTANT

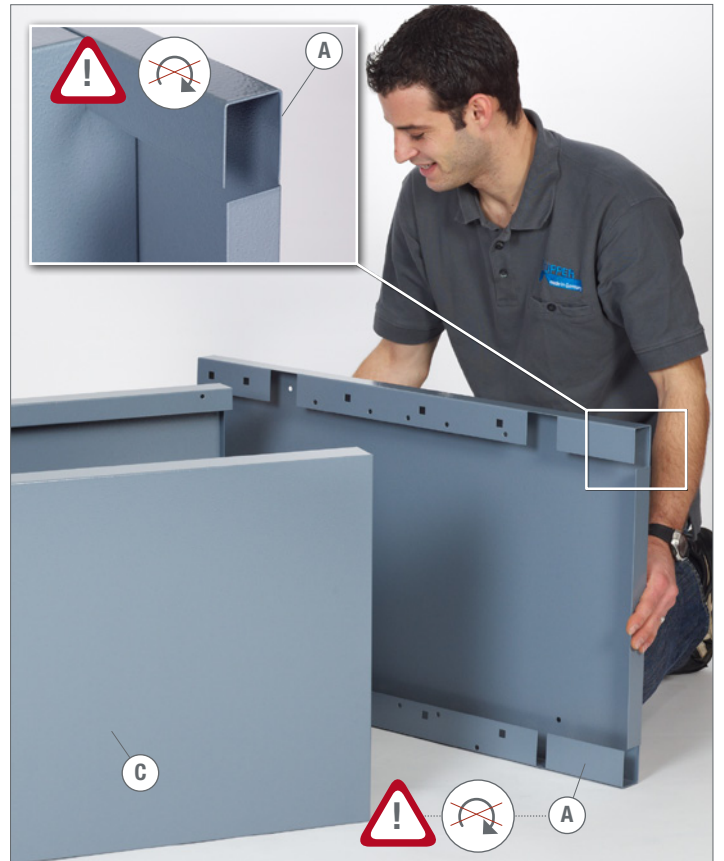

10.  6x M5  6x M5 x 10  6x 5,3MM ②  SW 8 ①  PH 2x100



11.  6x M5  6x M5 x 10  6x 5,3MM ②  SW 8 ①  PH 2x100



12. 4x M8 4x 4x 4x

5



13. 2x M5 2x M5 x 10 2x 5,3 mm

2 SW 8 1 PH 2 x 100

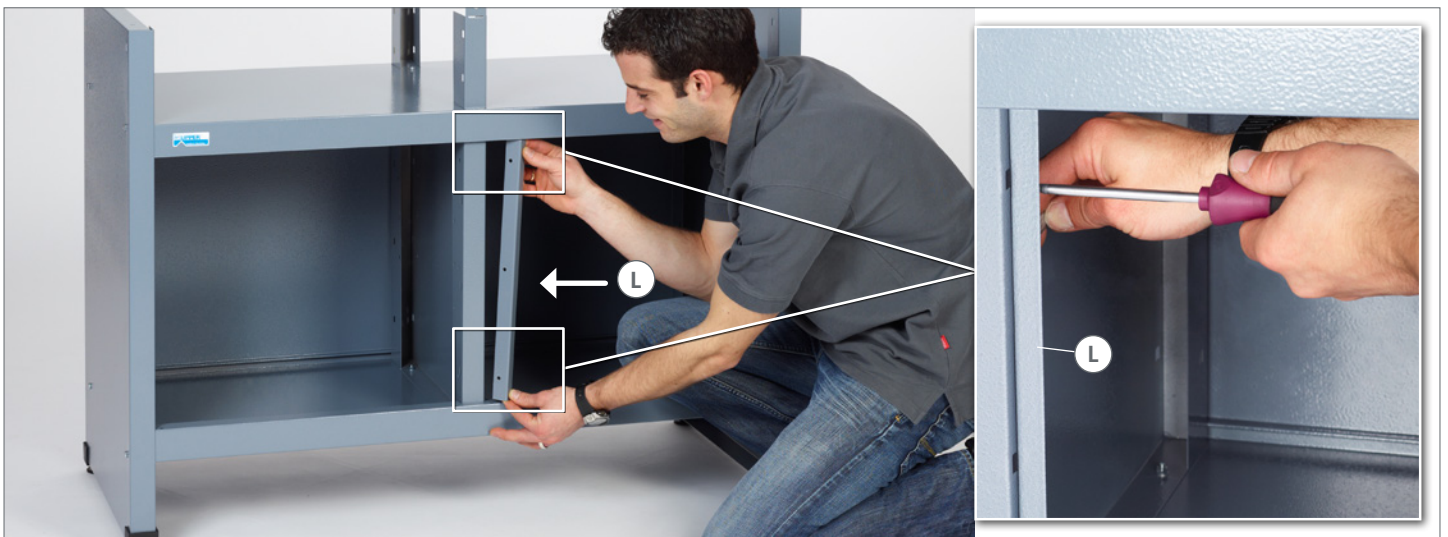

14.



15.  1x  1x 6x12

 ① Schlitz 6,5 x 150

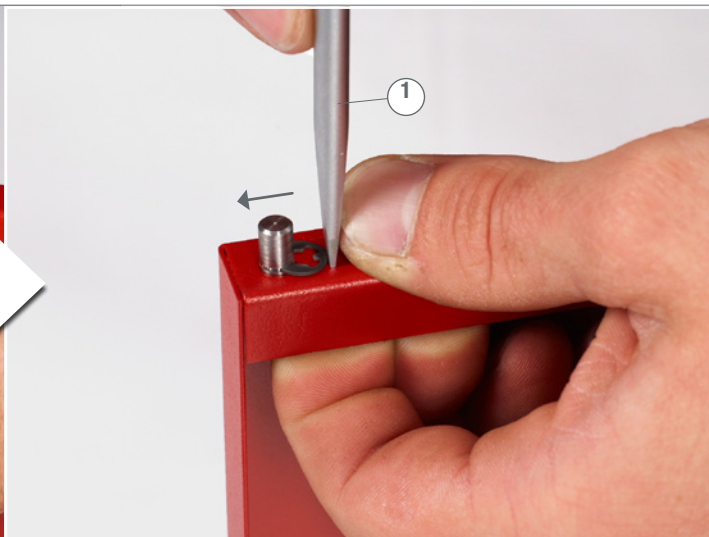

16.



17.  1x M6  1x M6 x 16  1x 6,4 mm  ② SW 10  ⑥

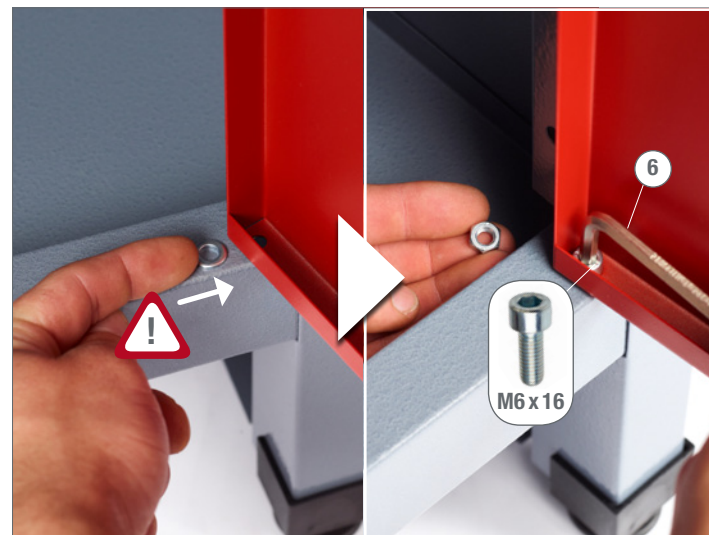

18.  1x  1x

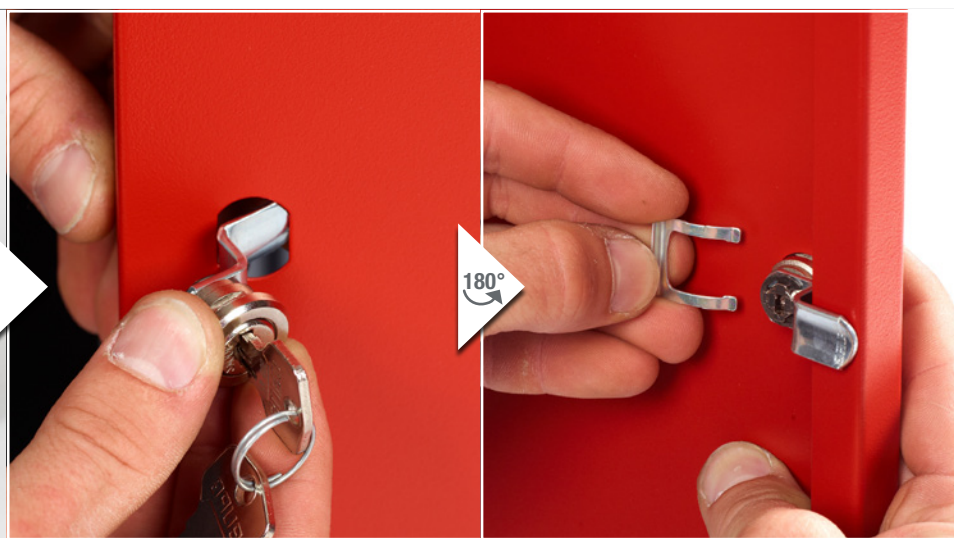

19.

8  7 

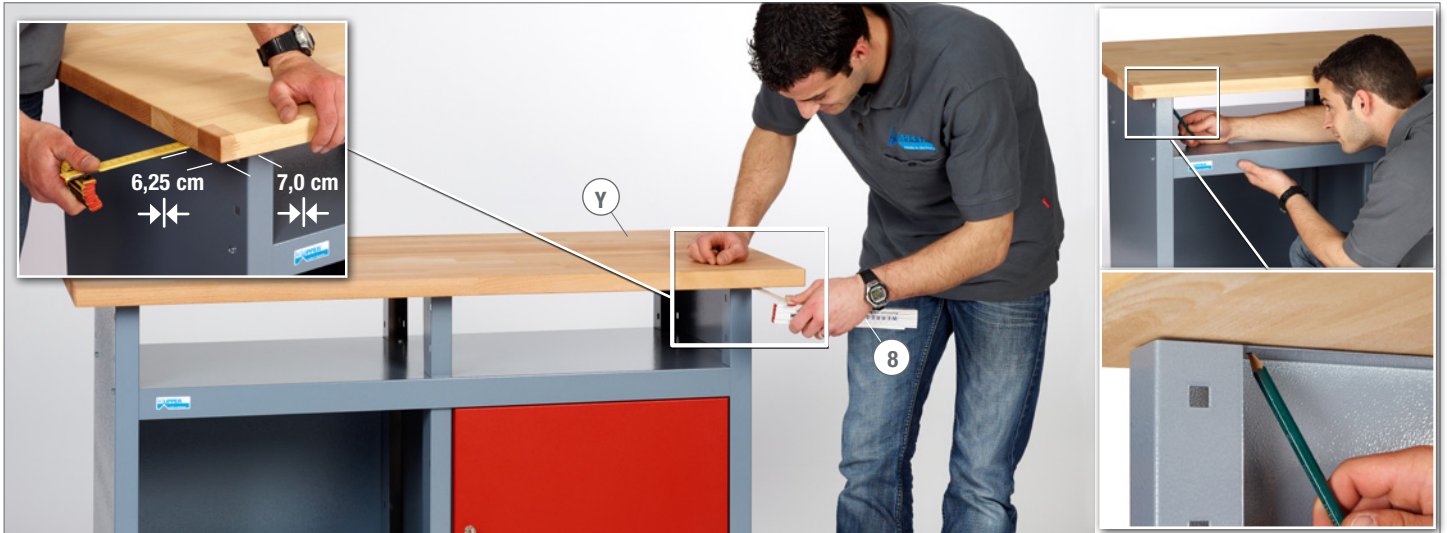

20.

4  3 



21.

6x 5,5 x 19  2  SW 8 2  SW 8



22.

 5x CR



23.

 5x CL



24. 10x M4 10x M4x10

② SW7 ① PH1x100



25. 30x M4 30x M4x10

② SW7 ① PH1x100

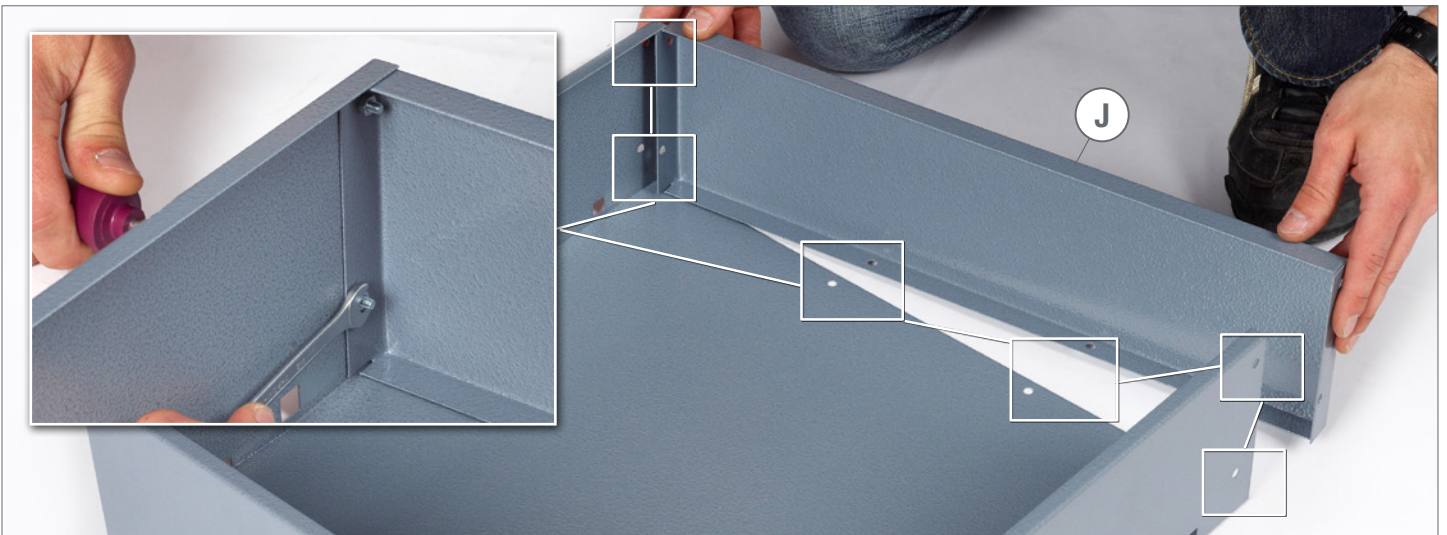

26.

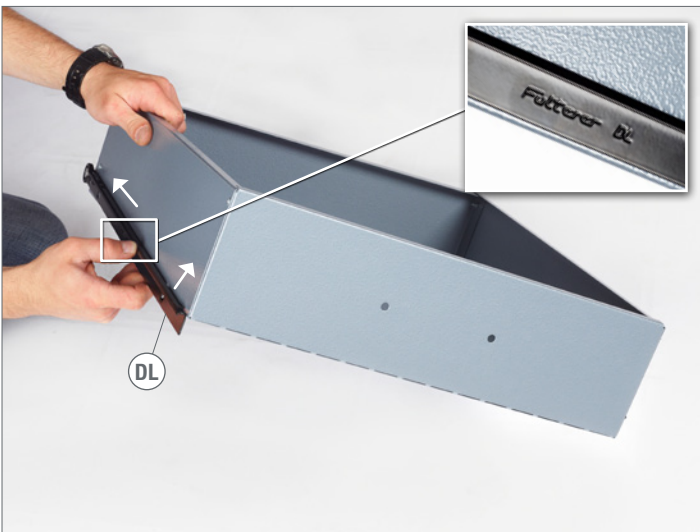

27.

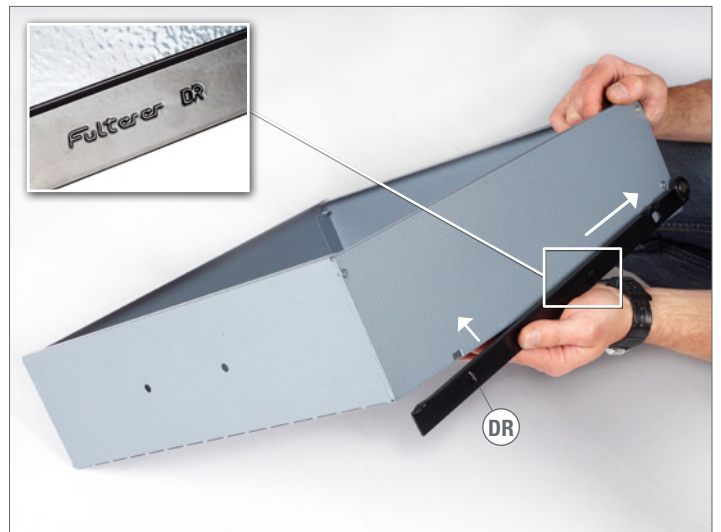

28.



29.

10x KU 4x16

5x



① PH2x100



30.





Modell-Nr.

12040