

















MONTAGEANLEITUNG

-  MONTAGEANLEITUNG
-  ASSEMBLY INSTRUCTION
-  DE INSTRUCTIE VAN DE ASSEMBLAGE
-  ISTRUZIONE DELL'ASSEMBLEA
-  INSTRUCCIÓN DE ASAMBLEA
-  INSTRUCTION DE MONTAGE
-  NÁVOD K MONTÁŽI
-  MONTERINGSANVISNING

-  MONTAJ TALIMATI
-  ASENNUSOHJE
-  BRUGSANVISNING
-  BRUKSANVISNING
-  UPUTE ZA MONTAŽU
-  NAVODILA ZA MONTAŽO
-  SZERELÉSI ÚTMUTATÓ
-  INSTRUCTIUNI DE MONTAJ



Modell-Nr.

12150

ART.-NR. FRONT KORPUS

12151  Silber

12152  Silber

12154  Silber

12157  Silber

12156  

Friedrich Küpper GmbH
Friedrich-Küpper-Weg
54570 Berlingen
Deutschland

Telefon +49 (0) 65 91 - 95 42 0
Telefax +49 (0) 65 91 - 95 42 17
E-Mail info@friedrich-kuepper-gmbh.de
Internet www.friedrich-kuepper-gmbh.de

EINZELTEILE / PIECES

A



1x
772 mm x 475 mm

B



1x
772 mm x 475 mm

F



2x
645 mm x 450 mm

K



3x
403 mm x 468 mm

L



3x
400 mm x 25 mm

C



1x
1570 mm x 473 mm

D



1x
1570 mm x 473 mm

E

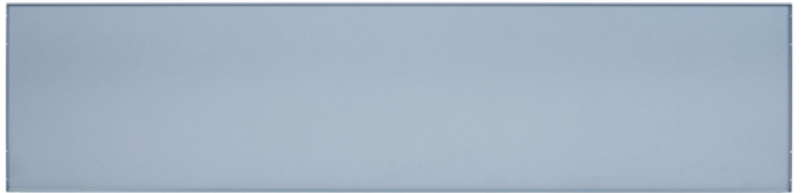

1x
1500 mm x 480 mm

Y



1x
1700 mm x 600 mm

H



3x
450 mm x 445 mm

I

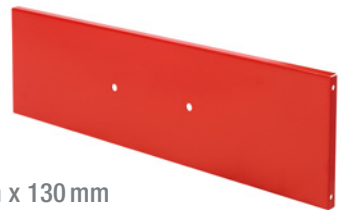

3x
470 mm x 130 mm

J



3x
450 mm x 120 mm

X



3x
450 mm x 20 mm

BEUTELINHALT / BAG CONTENT

 8x 5,5x19 mm	 6x KU 4x16 mm	 26x M5x10 mm	 26x ø5,3 mm	 26x M5	 24x M4 x 10 mm
 24x M4	 3x M6x16 mm	 3x ø6,4 mm	 3x M6	 3x 6x12 mm	 3x
 3x	 3x	 4x	 4x	 4x M8	 3x

BENÖTIGTES WERKZEUG / NEEDED TOOLS

 ① PH 1x100 PH 2x100 Schlitz 6,5x150	 ② SW 7 SW 8 SW 10	 ③ 4 mm
 ④	 ⑤	 ⑥ 5 mm
 ⑦	 ⑧	

1.



2. WICHTIG / IMPORTANT



3. WICHTIG / IMPORTANT



4.  4x M5  4x M5 x 10  4x 5,3MM

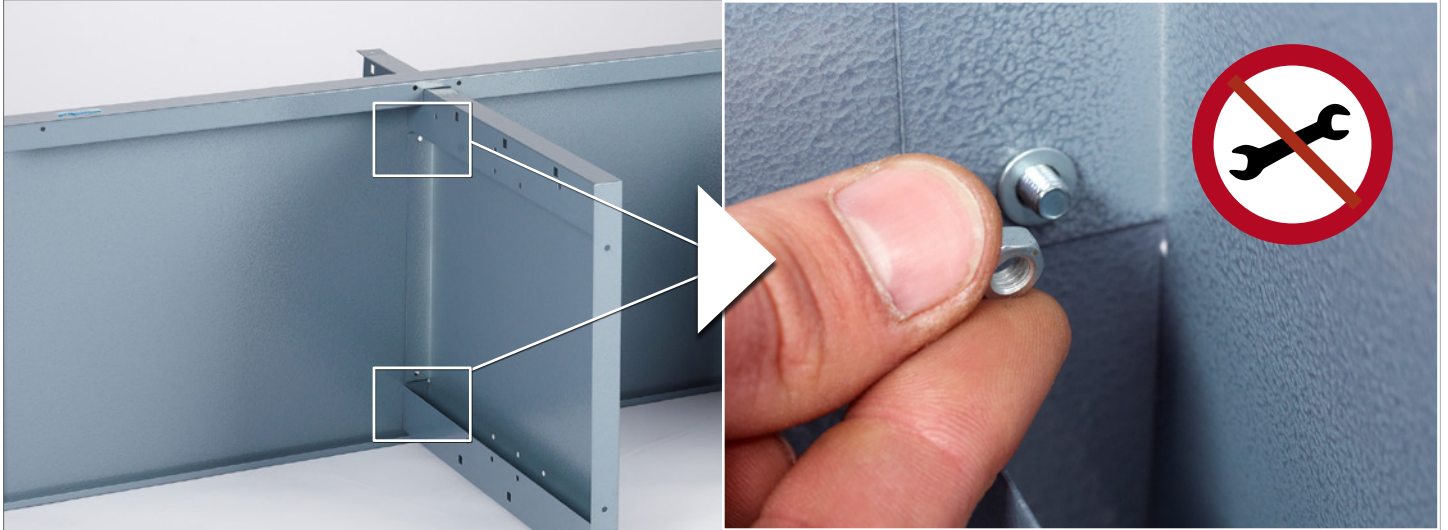

5.



6.  4x M5  4x M5 x 10  4x 5,3MM  2 SW 8  1 PH 2 X 100



7.



8.

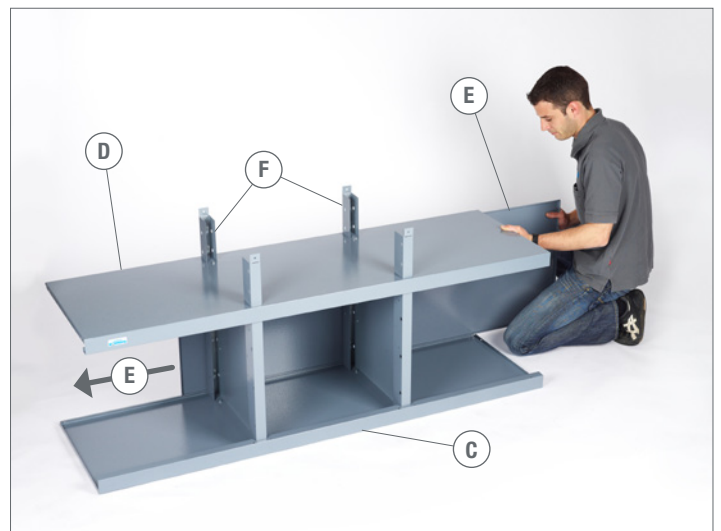

ZU SCHRITT 4. / IN ADDITION TO STEP 4.

②  SW 8 ①  PH 2x100

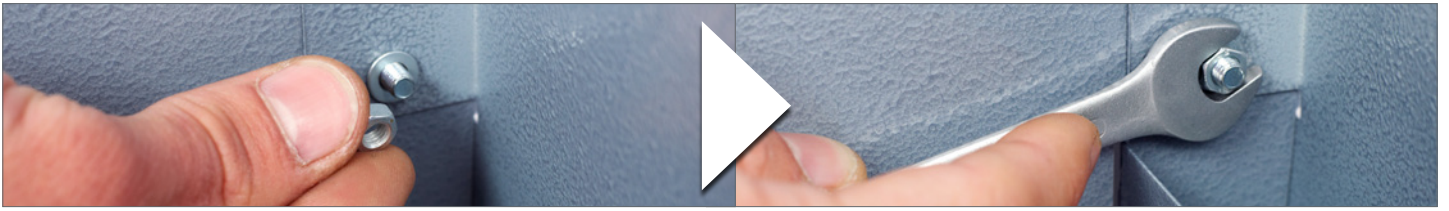

9. WICHTIG / IMPORTANT



10.  6x M5  6x M5x10  6x 5,3MM ②  SW 8 ①  PH 2x100



11.  6x M5  6x M5x10  6x 5,3MM ②  SW 8 ①  PH 2x100



12.



5



13.



2 SW 8 1 PH 2x100



14.



15.

⑧ ⑦

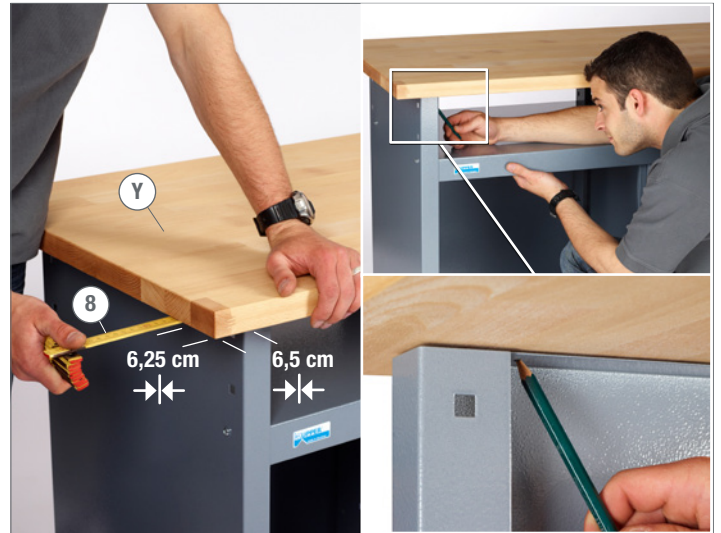

16.

④ ③



17.

8x 5,5 x 19

② SW 8



18.

3x 3x 6 x 12

① Schlitz 6,5 x 150

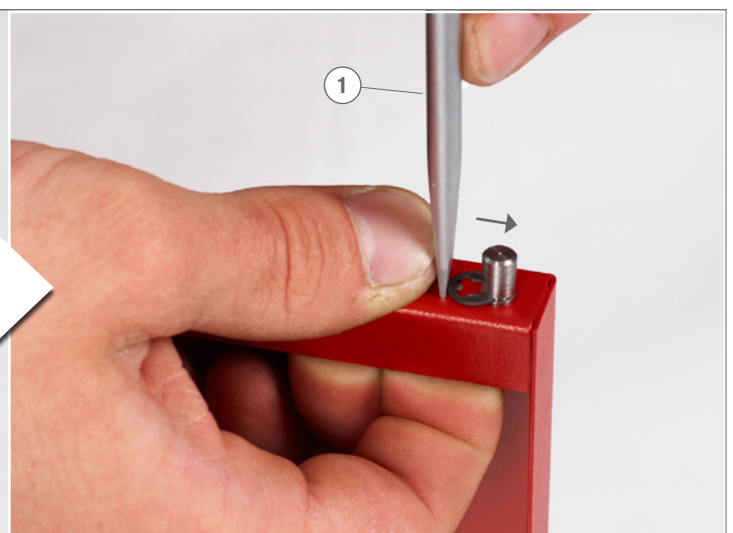

19.



20.

3x M6 3x M6 x 16 3x 6,4 mm ② SW 10 ⑥

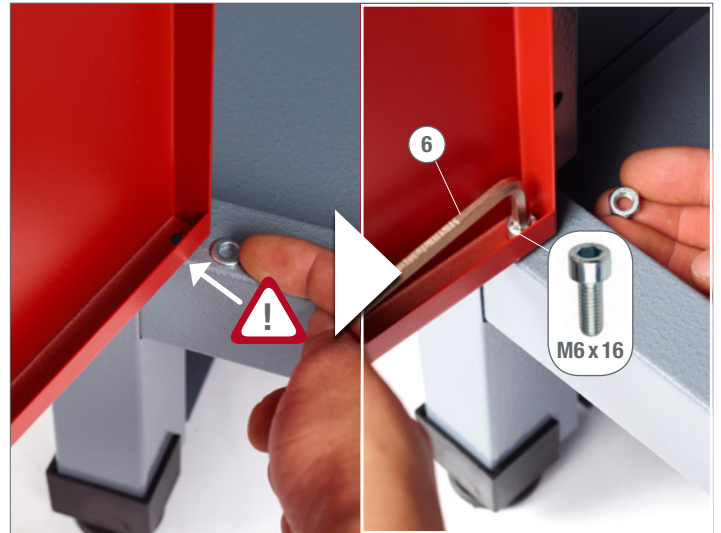

21.

3x 3x

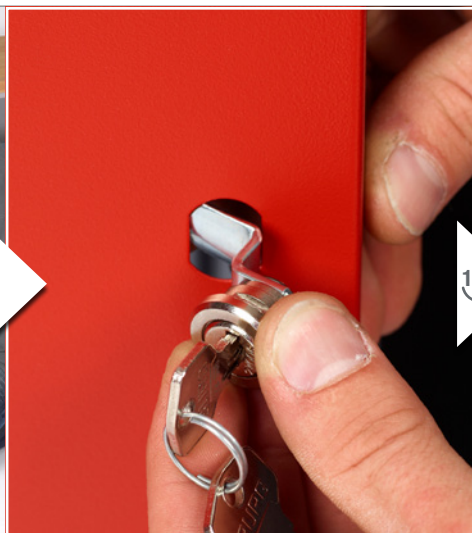

22.

⑩ 3x CR



23.

⑩ 3x CL



24.

6x M4

6x M4 x 10

② SW7

① PH1x100

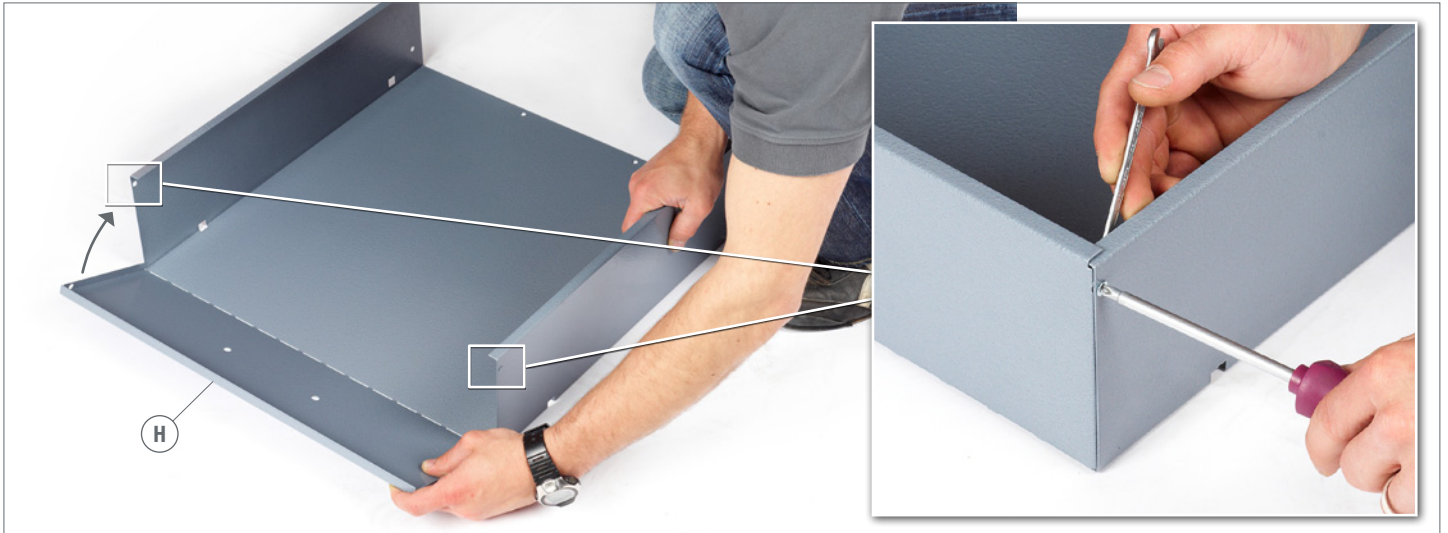

25.

18x M4

18x M4 x 10

② SW7

① PH1x100

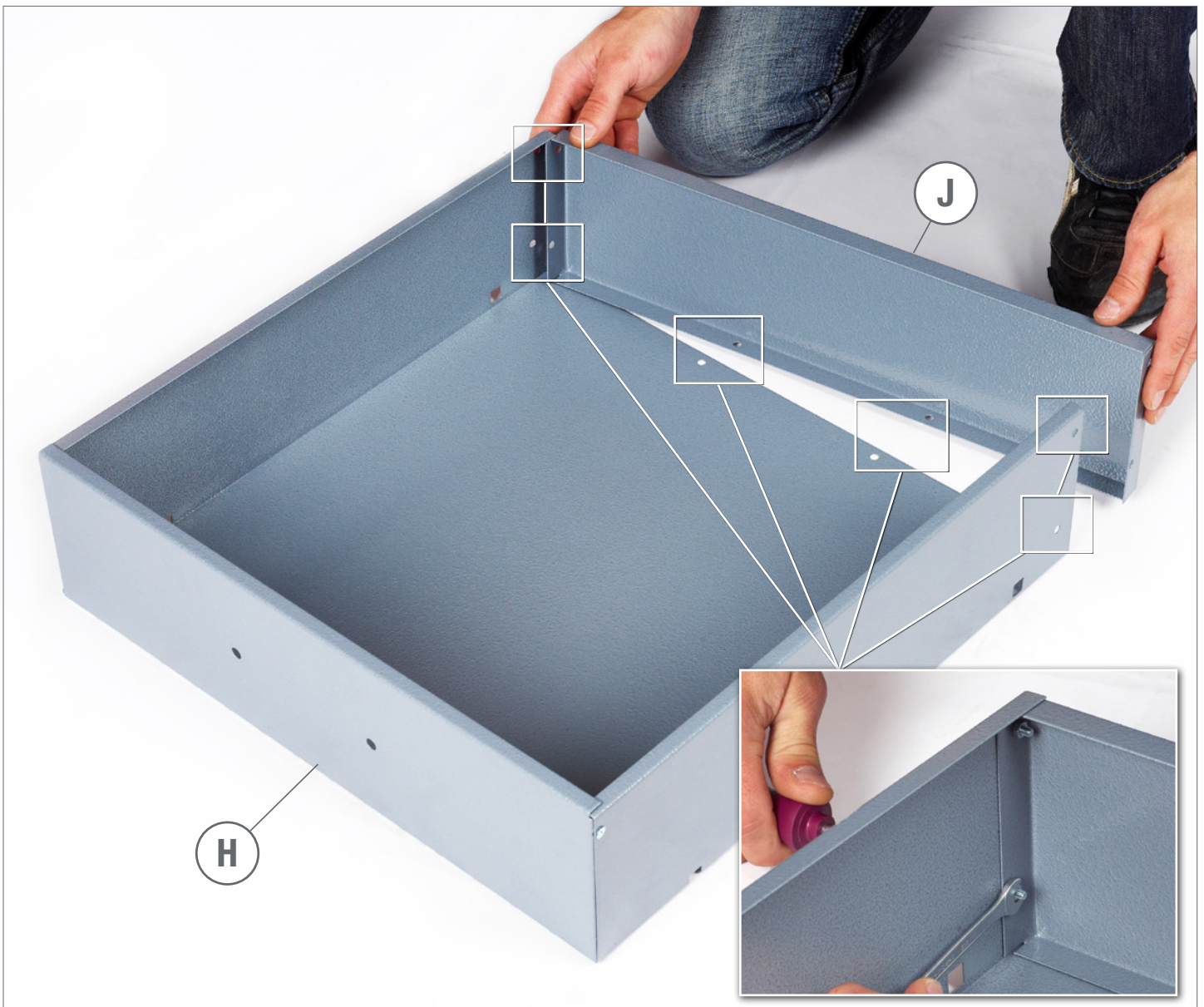

26.

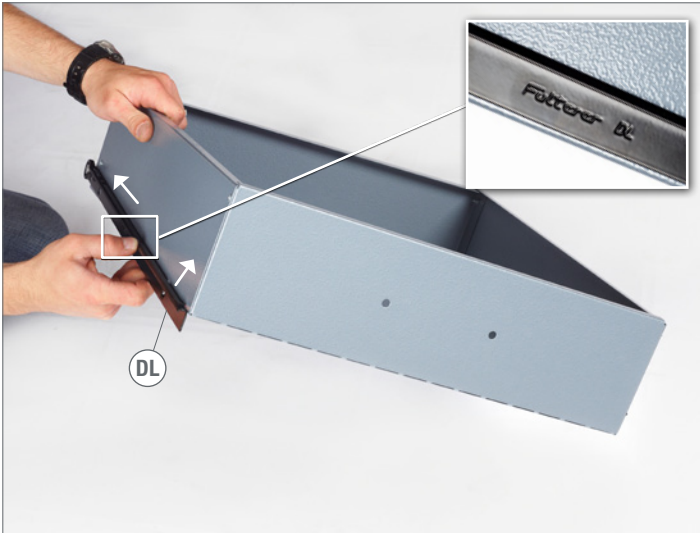

27.

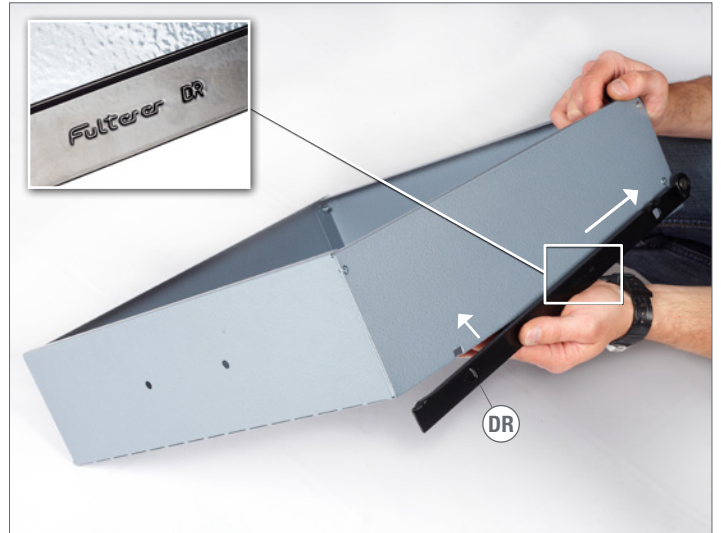

28.



29.

6x KU 4 x 16



1 PH2x100



30.



31.

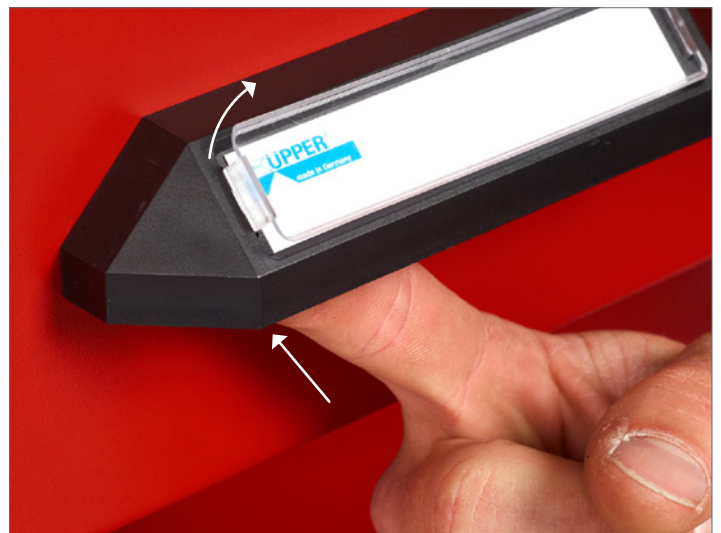



Modell-Nr.

12150