

















## MONTAGEANLEITUNG

-  MONTAGEANLEITUNG
-  ASSEMBLY INSTRUCTION
-  DE INSTRUCTIE VAN DE ASSEMBLAGE
-  ISTRUZIONE DELL'ASSEMBLEA
-  INSTRUCCIÓN DE ASAMBLEA
-  INSTRUCTION DE MONTAGE
-  NÁVOD K MONTÁŽI
-  MONTERINGSANVISNING

-  MONTAJ TALIMATI
-  ASENNUSOHJE
-  BRUGSANVISNING
-  BRUKSANVISNING
-  UPUTE ZA MONTAŽU
-  NAVODILA ZA MONTAŽO
-  SZERELÉSI ÚTMUTATÓ
-  INSTRUCTIUNI DE MONTAJ

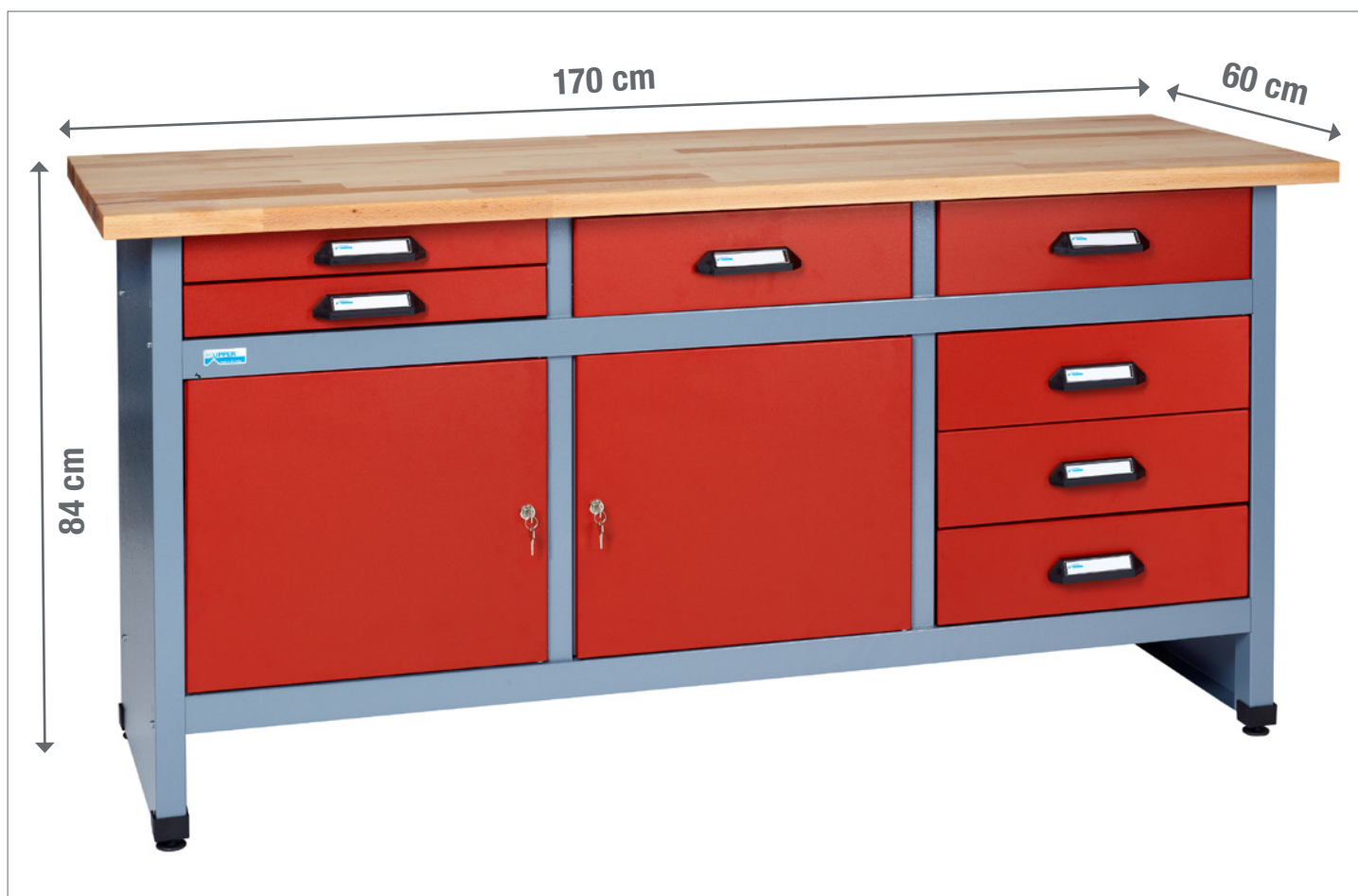

Modell-Nr.

# 12270

ART.-NR. FRONT KORPUS

12271  Silber

12272  Silber

12274  Silber

12277  Silber

12276  

Friedrich Küpper GmbH  
Friedrich-Küpper-Weg  
54570 Berlingen  
Deutschland

Telefon +49 (0) 65 91 - 95 42 0  
Telefax +49 (0) 65 91 - 95 42 17  
E-Mail [info@friedrich-kuepper-gmbh.de](mailto:info@friedrich-kuepper-gmbh.de)  
Internet [www.friedrich-kuepper-gmbh.de](http://www.friedrich-kuepper-gmbh.de)

EINZELTEILE / PIECES

**(A)**



**1x**  
772 mm x 475 mm

**(B)**



**1x**  
772 mm x 475 mm

**(F)**



**2x**  
645 mm x 450 mm

**(K)**



**2x**  
403 mm x 468 mm

**(L)**



**2x**  
400 mm x 25 mm

**(C)**



**1x**  
1570 mm x 473 mm

**(D)**



**1x**  
1570 mm x 473 mm

**(E)**



**1x**  
1500 mm x 480 mm

**(Y)**

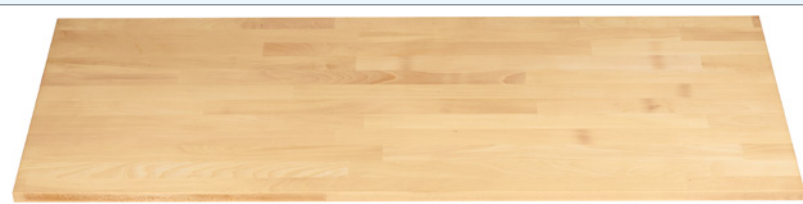

**1x**  
1700 mm x 600 mm

**(H)**



**5x**  
450 mm x 445 mm

**(I)**

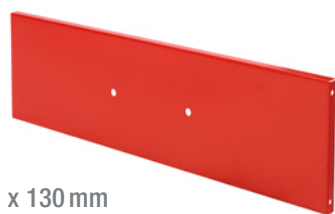

**5x**  
470 mm x 130 mm

**(J)**



**5x**  
450 mm x 120 mm

**(W)**



**2x**  
470 mm x 65 mm

**(V)**



**2x**  
450 mm x 440 mm

**(X)**



**7x**  
450 mm x 20 mm

BEUTELINHALT / BAG CONTENT

 8x 5,5x 19 mm	 14x KU 4 x 16 mm	 24x M5x 10 mm	 24x ø 5,3 mm	 24x M5	 40x M4 x 10 mm
 40x M4	 2x M6x 16 mm	 2x ø 6,4 mm	 2x M6	 2x 6x 12 mm	 2x
 2x	 2x	 4x	 4x	 4x M8	 7x

BENÖTIGTES WERKZEUG / NEEDED TOOLS

 ① PH 1 x 100 PH 2 x 100 Schlitz 6,5 x 150	 ② SW 7 SW 8 SW 10	 ③ 4 mm
 ④	 ⑤	 ⑥ 5 mm
 ⑦	 ⑧	

1.



2. WICHTIG / IMPORTANT



3. WICHTIG / IMPORTANT



4.  4x M5  4x M5 x 10  4x 5,3MM

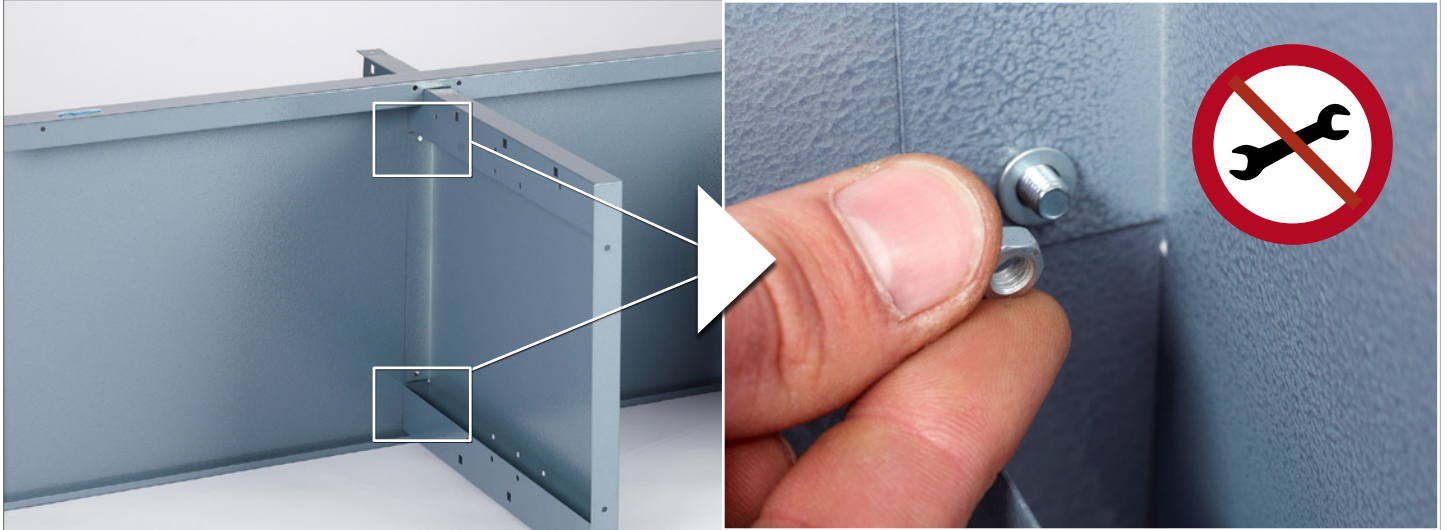

5.



6.  4x M5  4x M5 x 10  4x 5,3MM  ② SW 8  ① PH 2 X 100



7.



8.

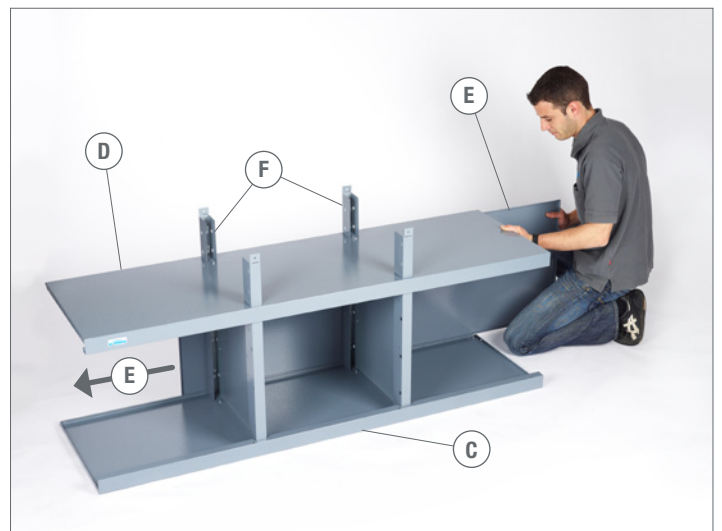

ZU SCHRITT 4. / IN ADDITION TO STEP 4.

②  SW 8    ①  PH 2x100

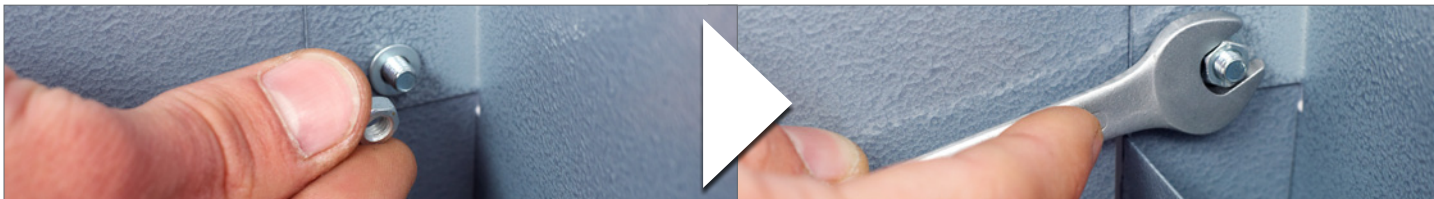

## 9. WICHTIG / IMPORTANT



10.

 6x M5     6x M5x10     6x 5,3MM    ②  SW 8    ①  PH 2x100



11.

 6x M5     6x M5x10     6x 5,3MM    ②  SW 8    ①  PH 2x100



12.



5



13.



2 SW 8  
1 PH 2x100

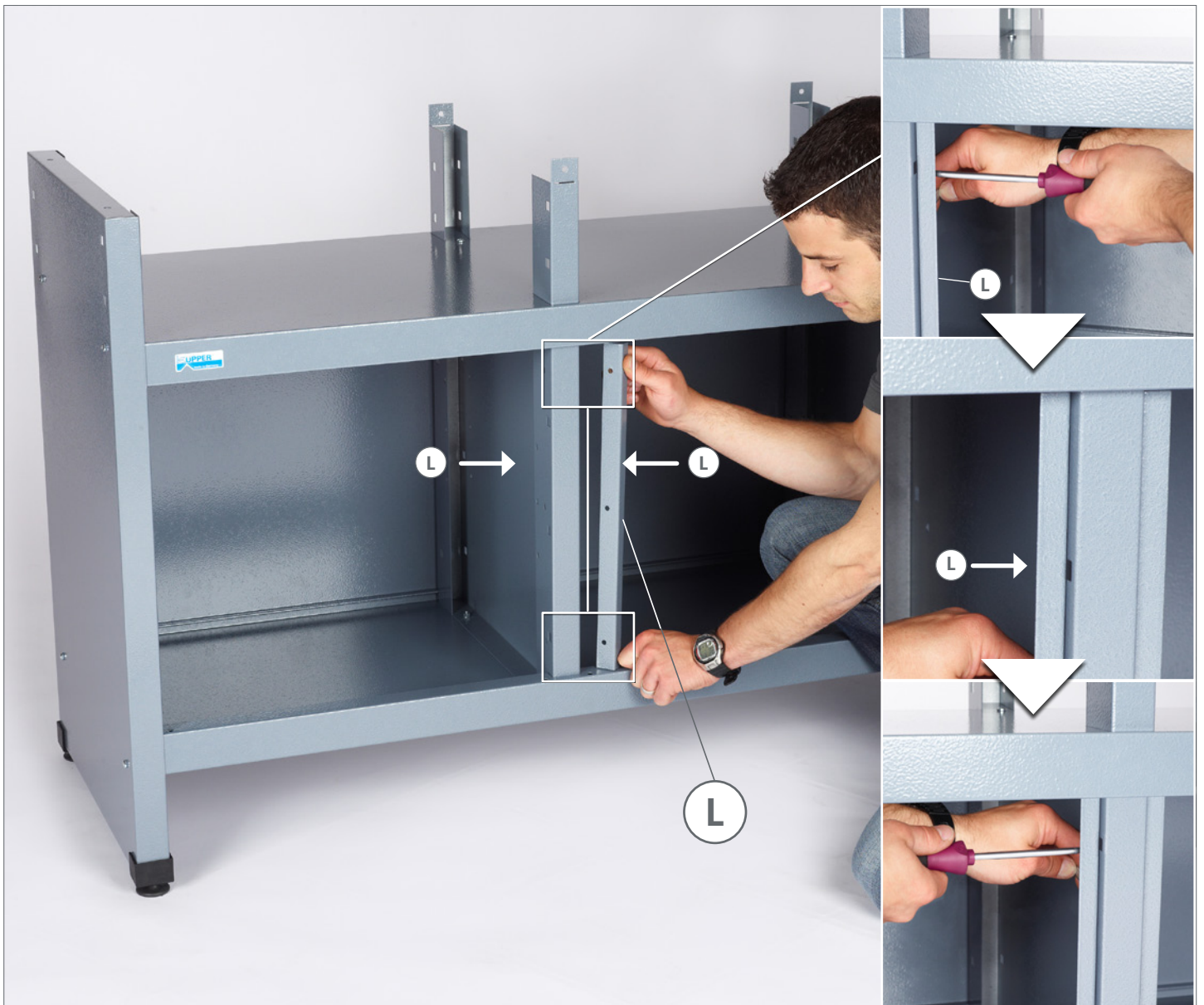

14.



15.

⑧ ⑦



16.

④ ③



17.

8x 5,5 x 19

② SW 8



18.

②x ②x 6 x 12

① Schlitz 6,5 x 150

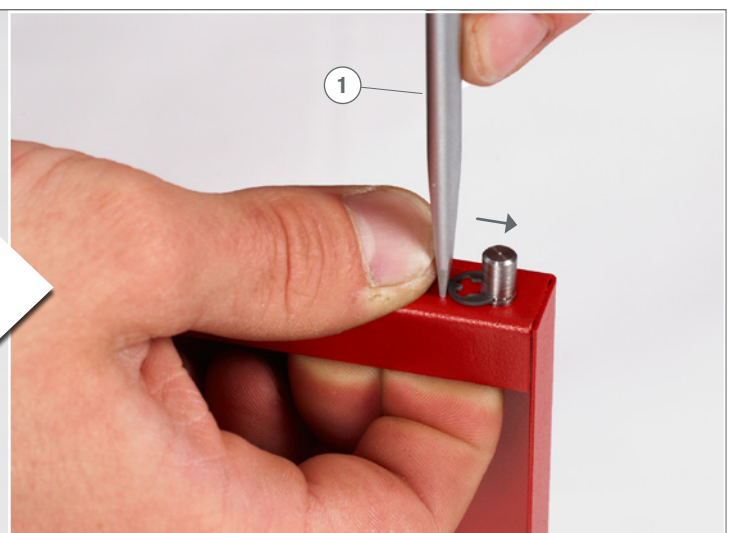



19.



20.

2x M6 2x M6 x 16 2x 6,4 mm ② SW 10 ⑥

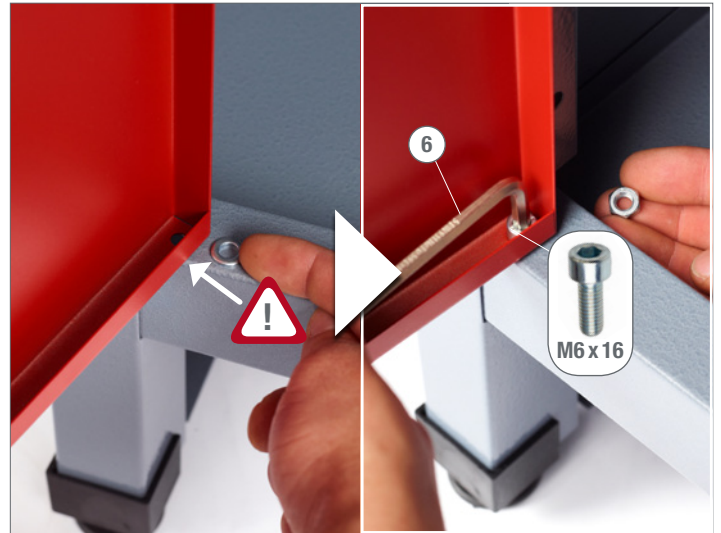

21.

2x 2x

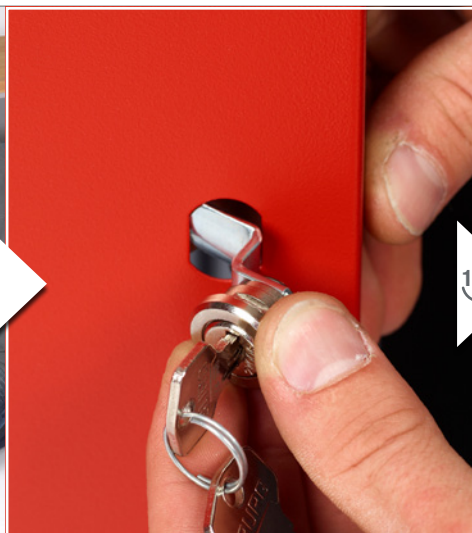

22.

⑦ 7x CR



23.

⑦ 7x CL



24.

4x KU 4x16

2x



① PH1x100

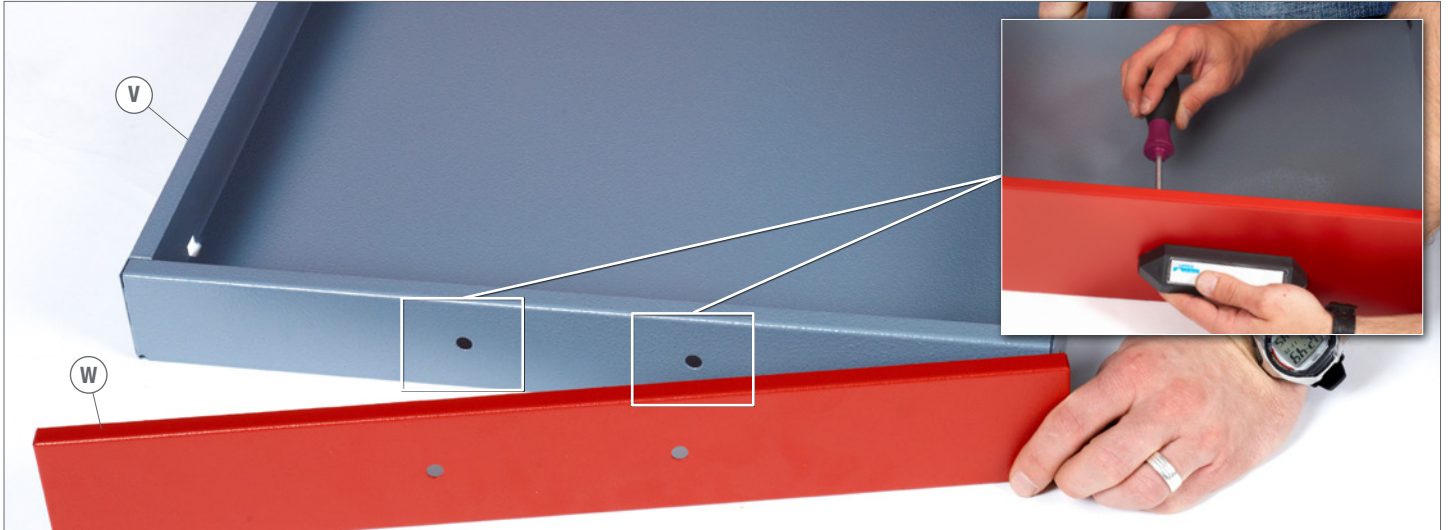

25.

10x M4

10x M4x10

② SW7

① PH1x100

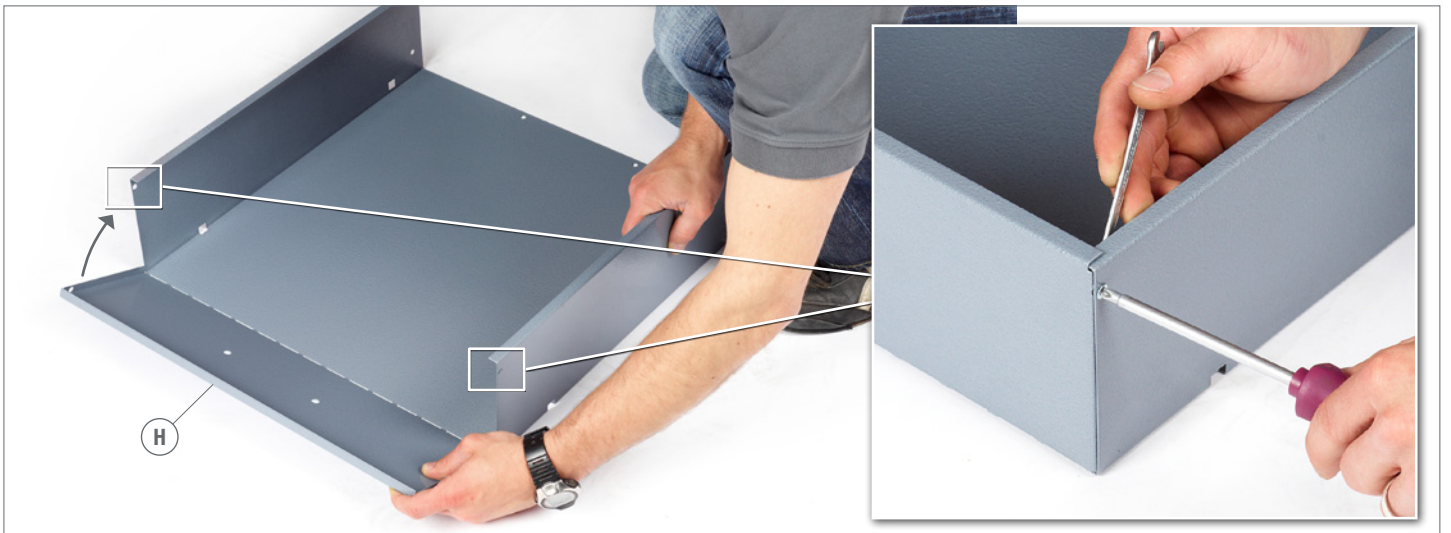

26.

30x M4

30x M4x10

② SW7

① PH1x100

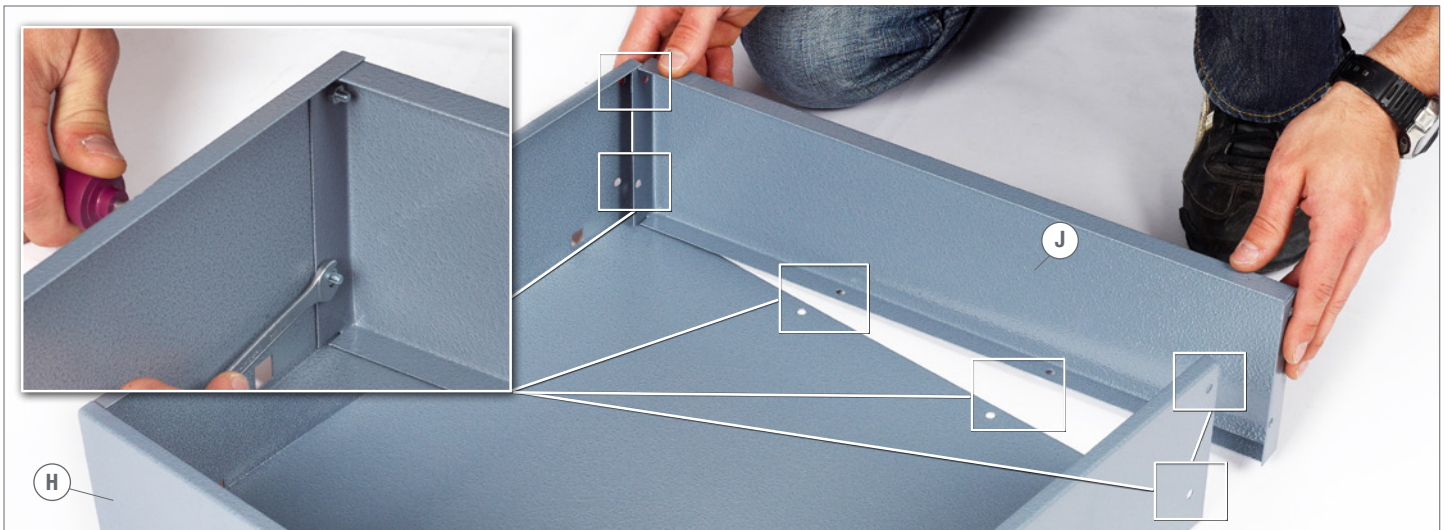

27.

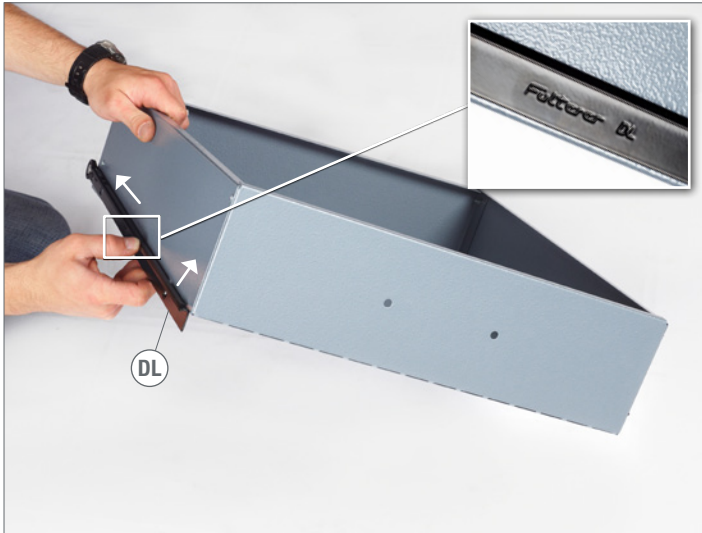

28.

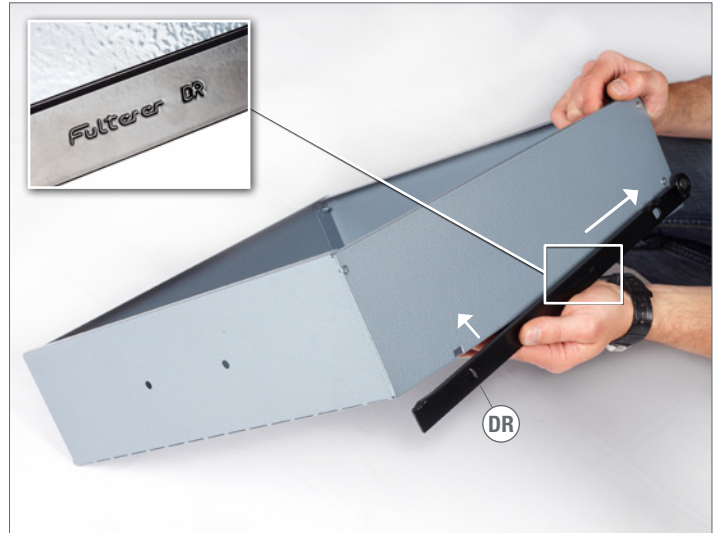

29.



30.

10x KU 4x16    5x     ①  PH2x100



31.



32.





Modell-Nr.

12270