

















MONTAGEANLEITUNG

-  MONTAGEANLEITUNG
-  ASSEMBLY INSTRUCTION
-  DE INSTRUCTIE VAN DE ASSEMBLAGE
-  ISTRUZIONE DELL'ASSEMBLEA
-  INSTRUCCIÓN DE ASAMBLEA
-  INSTRUCTION DE MONTAGE
-  NÁVOD K MONTÁŽI
-  MONTERINGSANVISNING

-  MONTAJ TALIMATI
-  ASENNUSOHJE
-  BRUGSANVISNING
-  BRUKSANVISNING
-  UPUTE ZA MONTAŽU
-  NAVODILA ZA MONTAŽO
-  SZERELÉSI ÚTMUTATÓ
-  INSTRUCIUNI DE MONTAJ



Modell-Nr.

12390

ART.-NR. FRONT KORPUS

12391  Silber

12392  Silber

12394  Silber

12397  Silber

12396  

Friedrich Küpper GmbH
Friedrich-Küpper-Weg
54570 Berlingen
Deutschland

Telefon +49 (0) 65 91 - 95 42 0
Telefax +49 (0) 65 91 - 95 42 17
E-Mail info@friedrich-kuepper-gmbh.de
Internet www.friedrich-kuepper-gmbh.de

EINZELTEILE / PIECES

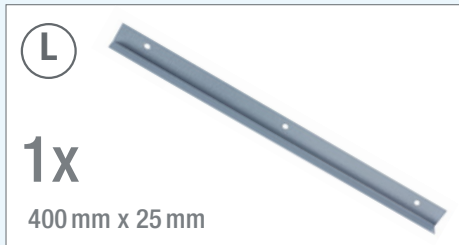
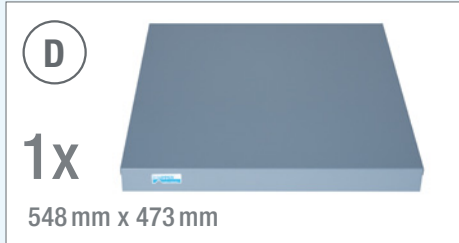
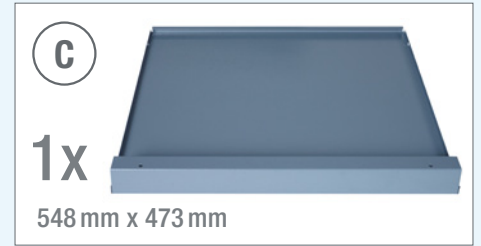
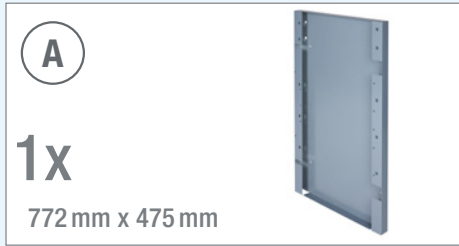

BEUTELINHALT / BAG CONTENT

 4x 5,5x19 mm	 2x KU 4x16 mm	 14x M5x10 mm	 14x ø5,3 mm	 14x M5	 8x M4 x 10 mm
 8x M4	 1x M6x16 mm	 1x ø6,4 mm	 1x M6	 1x 6x12 mm	 1x
 1x	 1x	 4x	 4x	 4x M8	 1x

BENÖTIGTES WERKZEUG / NEEDED TOOLS

 ① PH 1x100 PH 2x100 Schlitz 6,5x150	 ② SW 7 SW 8 SW 10	 ③ 4 mm
 ④	 ⑤	 ⑥ 5 mm
 ⑦	 ⑧	

1.



2.

2x M5 2x M5 x 10 2x 5,3 MM

② SW 8 ① PH 2 X 100

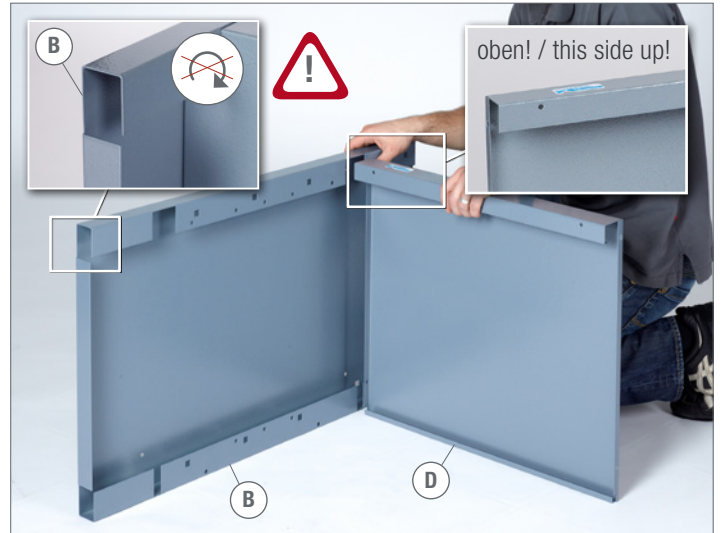

3.

2x M5 2x M5 x 10 2x 5,3 MM

② SW 8 ① PH 2 X 100



4. 2x M5 2x M5x10 2x 5,3MM

② SW8 ① PH2X100



5. 6x M5 6x M5x10 6x 5,3MM

② SW8 ① PH2X100



6. 4x M8 4x 4x 4x

⑤



7.

2x M5

2x M5x10

2x 5,3mm

② SW 8

① PH 2x100



8.

1x

1x 6x12

① Schlitz 6,5 x 150

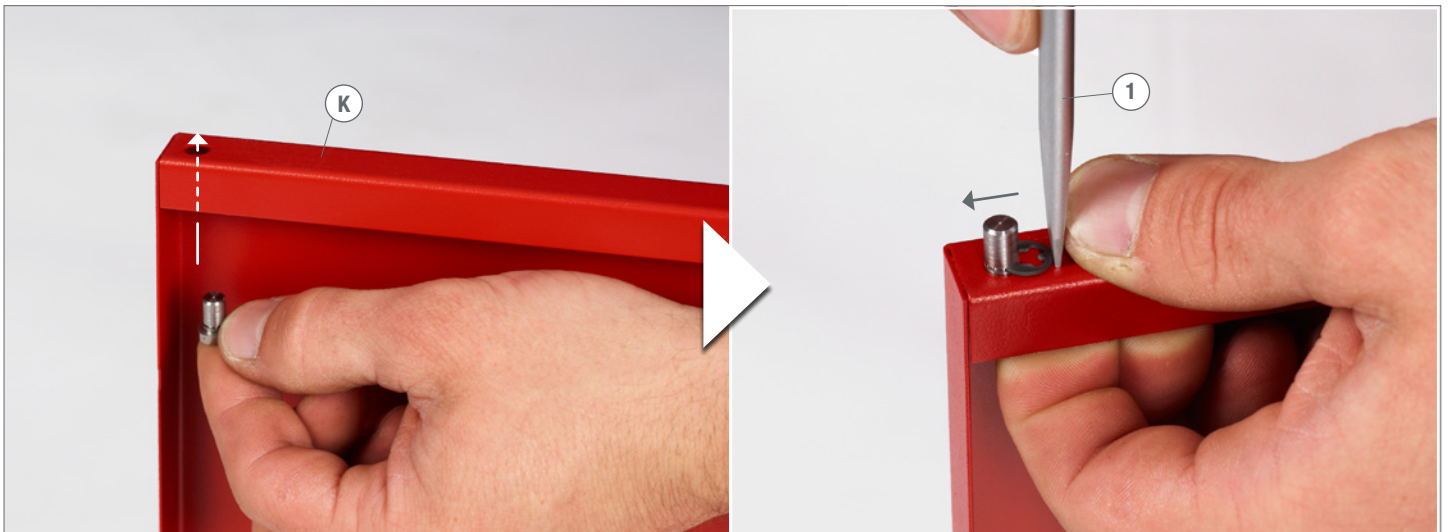

9.



10.

- 1x M6
- 1x M6x16
- 1x 6,4 mm
- ② SW 10
- ⑥

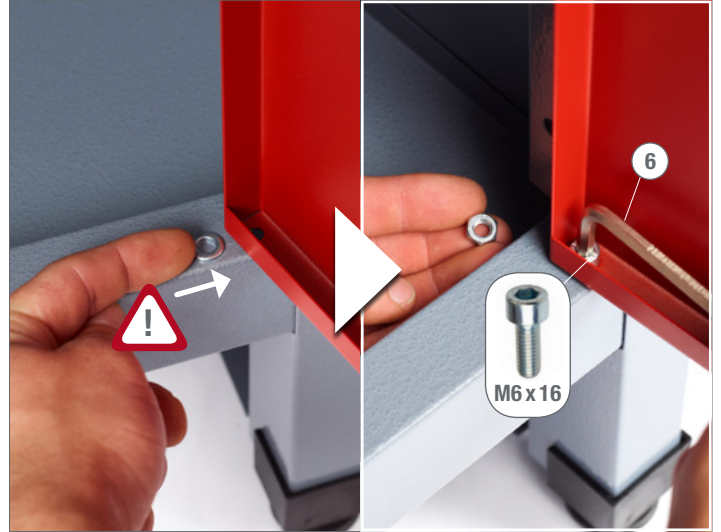

11.

- 1x
- 1x



12. ^(X)
1x CR



13. ^(X)
1x CL



14.

⑧ ⑦



15.



16.

4x 5,5x19



17.

2x M4 2x M4 x 10



18.

6x M4

6x M4 x 10

② SW7

① PH1x100

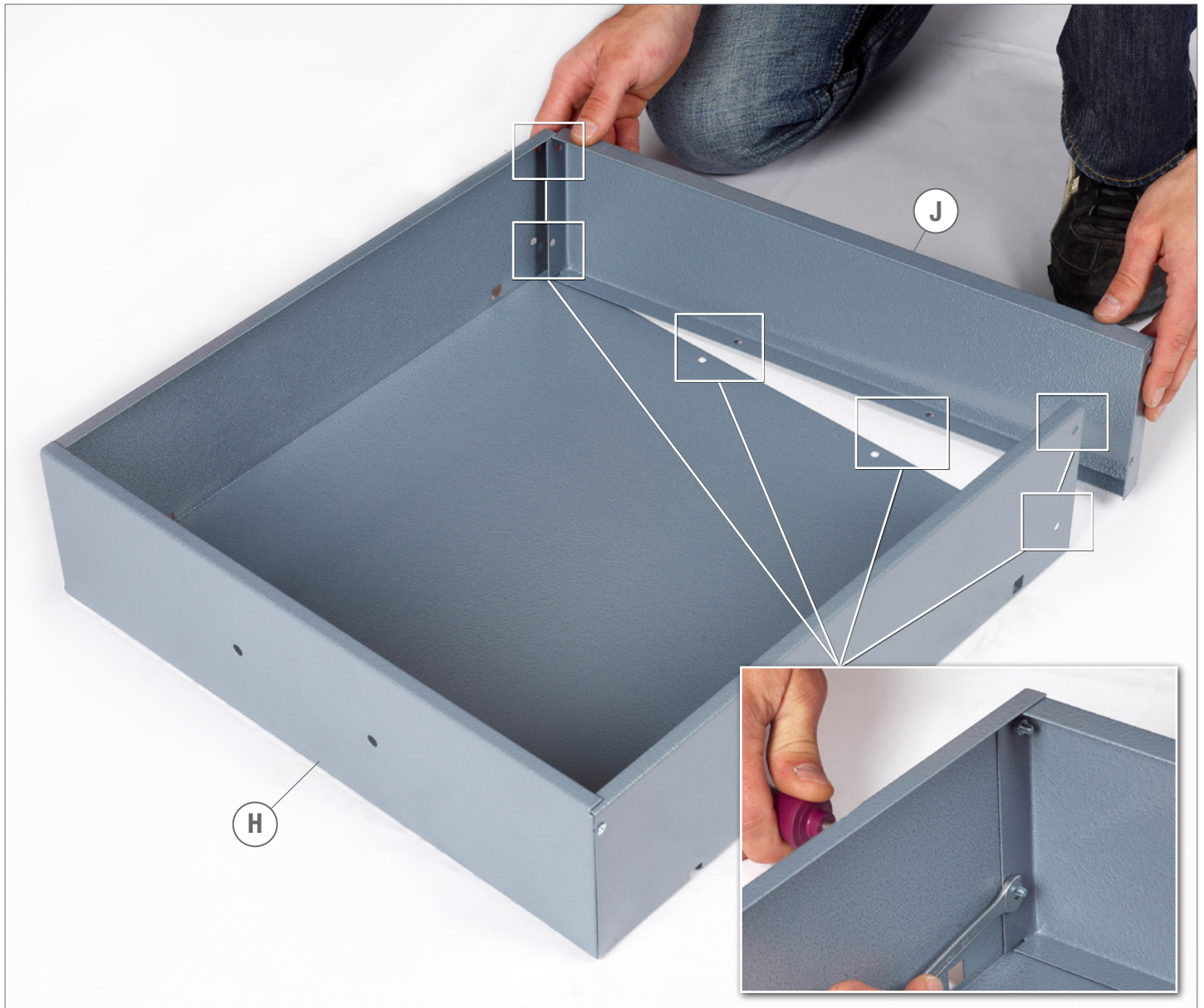

19.

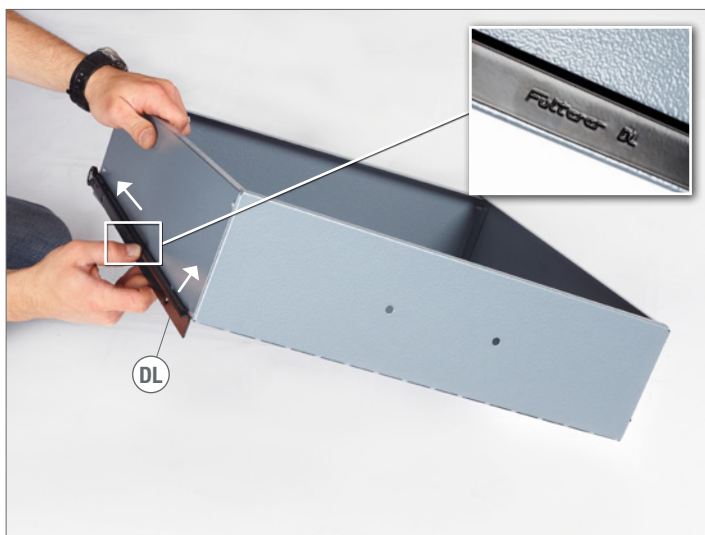

20.

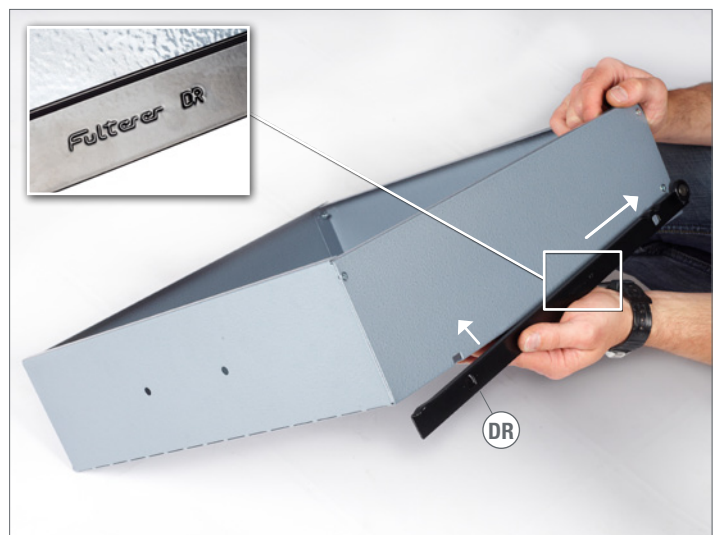

21.



22.

2x KU 4x16

1x



① PH2x100



23.





Modell-Nr.

12390