

















MONTAGEANLEITUNG

-  MONTAGEANLEITUNG
-  ASSEMBLY INSTRUCTION
-  DE INSTRUCTIE VAN DE ASSEMBLAGE
-  ISTRUZIONE DELL'ASSEMBLEA
-  INSTRUCCIÓN DE ASAMBLEA
-  INSTRUCTION DE MONTAGE
-  NÁVOD K MONTÁŽI
-  MONTERINGSANVISNING

-  MONTAJ TALIMATI
-  ASENNUSOHJE
-  BRUGSANVISNING
-  BRUKSANVISNING
-  UPUTE ZA MONTAŽU
-  NAVODILA ZA MONTAŽO
-  SZERELÉSI ÚTMUTATÓ
-  INSTRUCTIUNI DE MONTAJ



Modell-Nr.

12490

ART.-NR. FRONT KORPUS

12491  Silber

12492  Silber

12494  Silber

12497  Silber

12496  

Friedrich Küpper GmbH
Friedrich-Küpper-Weg
54570 Berlingen
Deutschland

Telefon +49 (0) 65 91 - 95 42 0
Telefax +49 (0) 65 91 - 95 42 17
E-Mail info@friedrich-kuepper-gmbh.de
Internet www.friedrich-kuepper-gmbh.de

EINZELTEILE / PIECES

A

1x

772 mm x 475 mm



B

1x

772 mm x 475 mm



C

1x

548 mm x 473 mm



D

1x

548 mm x 473 mm



E

1x

474 mm x 480 mm

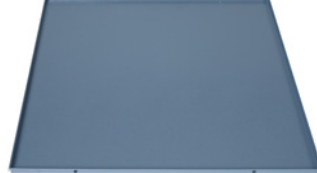

Y

1x

600 mm x 600 mm



X

4x

450 mm x 20 mm



J

4x

450 mm x 120 mm



H

4x

450 mm x 445 mm



I

4x

470 mm x 130 mm

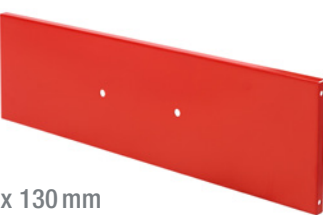

BEUTELINHALT / BAG CONTENT



BENÖTIGTES WERKZEUG / NEEDED TOOLS



1.



2.

2x M5 2x M5 x 10 2x 5,3 MM

② SW 8 ① PH 2 X 100

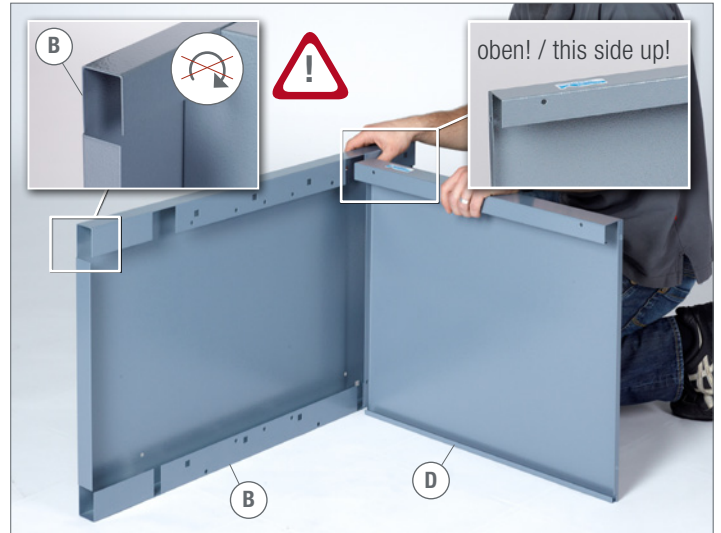

3.

2x M5 2x M5 x 10 2x 5,3 MM

② SW 8 ① PH 2 X 100



4. 2x M5 2x M5x10 2x 5,3MM

2 SW8 1 PH2X100

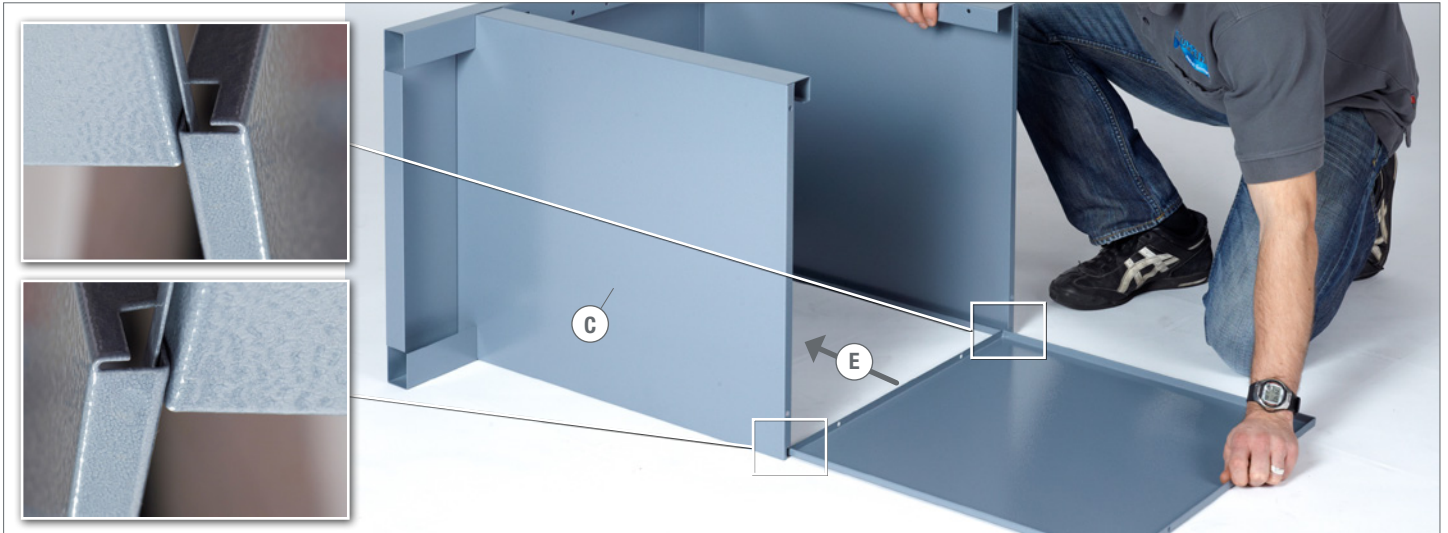

5. 6x M5 6x M5x10 6x 5,3MM 2 SW8 1 PH2X100



6. 4x M8 4x 4x 4x



7. 4x CR



8. 4x CL



9.

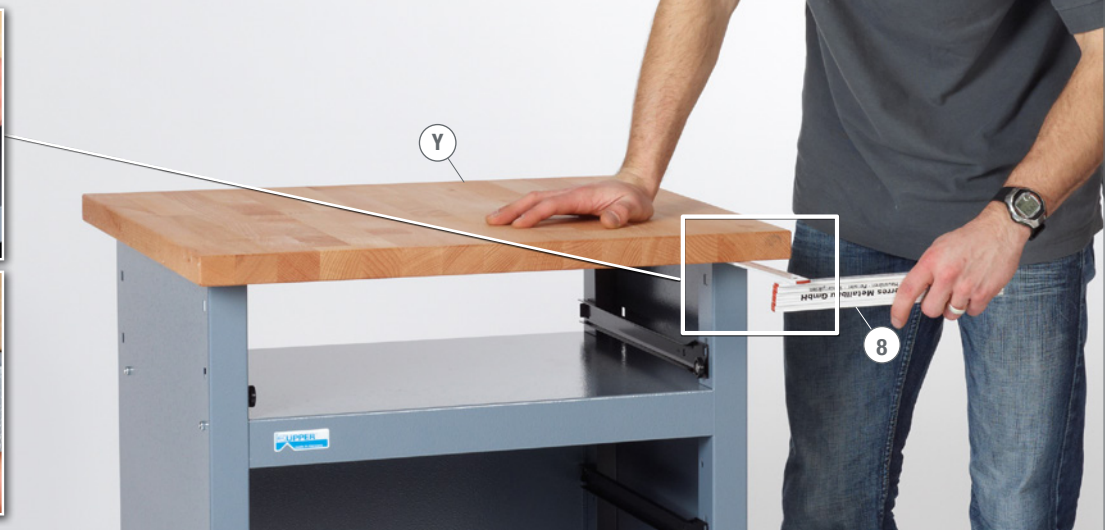
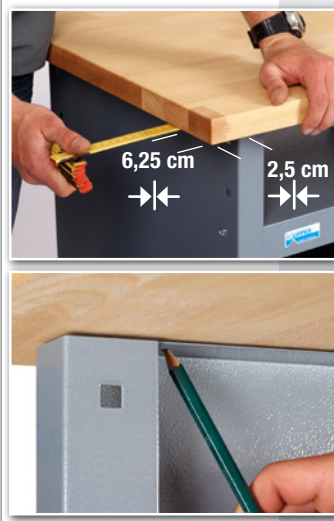

10.



11.

4x 5,5 x 19



12.

8x M4 8x M4 x 10

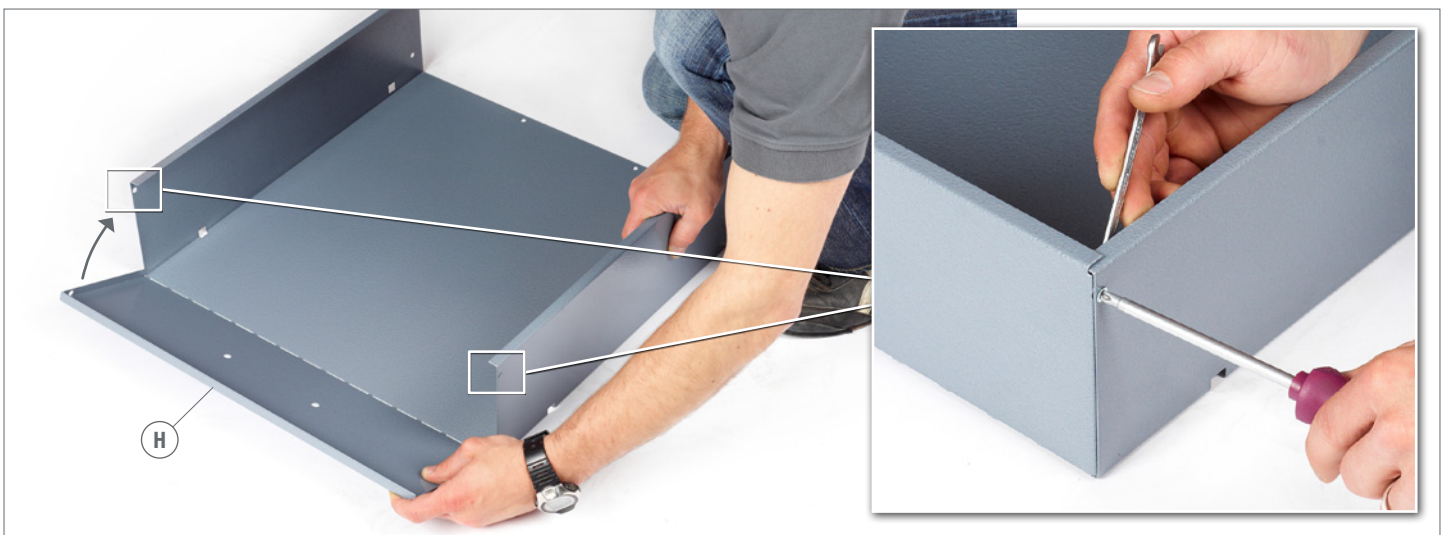

13. 24x M4 24x M4x10

② SW7 ① PH1x100

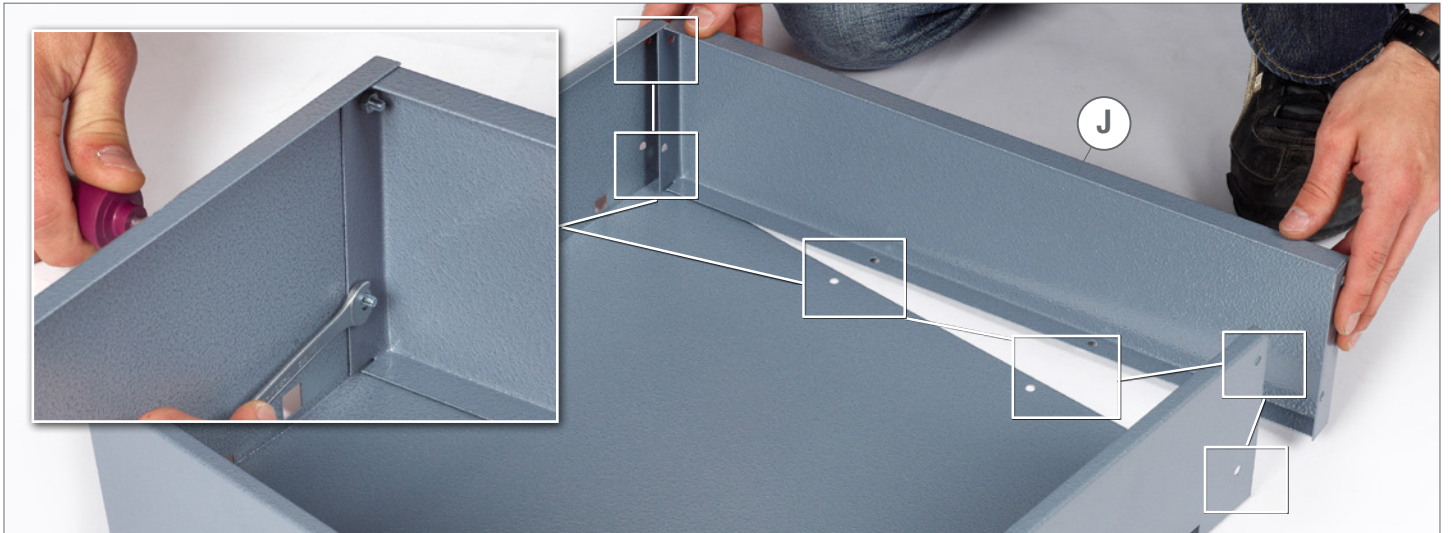

14.

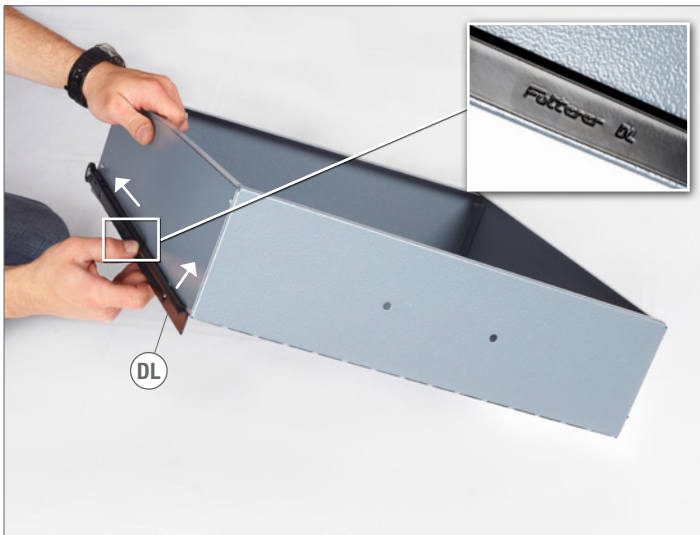

15.

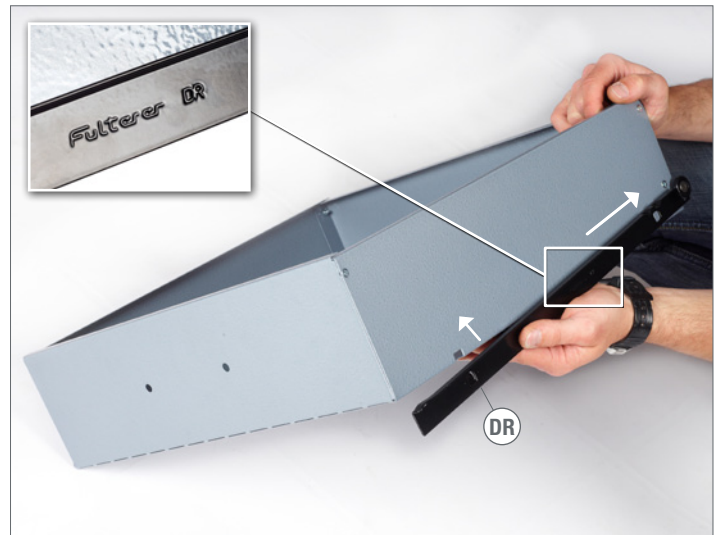

16. 8x KU 4x16 4x [Bracket Icon] ① PH2x100



17.





Modell-Nr.

12490