

Datenblatt / Datasheet

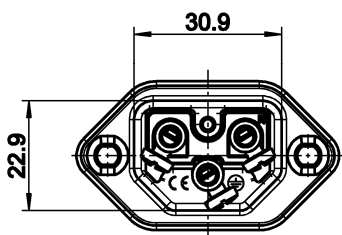
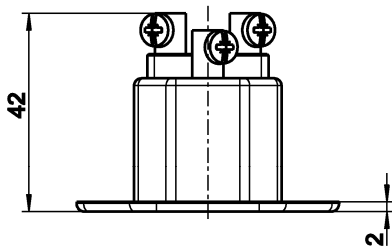
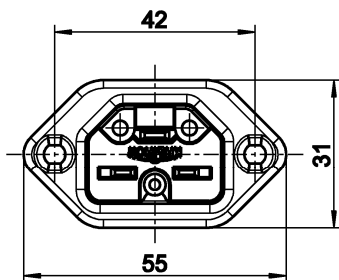
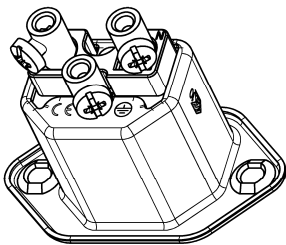
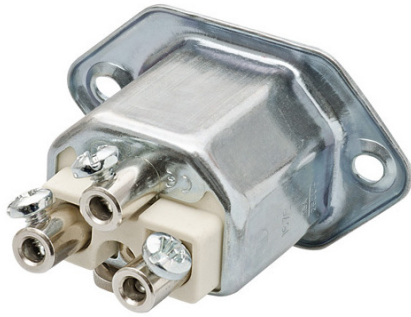

Metall Geräte Einbaustecker T 155, mit Schutzkontakt.
EN 60 320, Normblatt C 22. Für Heissgeräte mit 200 °C
Dauergebrauchstemperatur.

*Metall plug for building in into appliances with
constant working temperatures up to 200 °C. With
protective contact system.*

Typ: 444 .1
Type:

Nennspannung: AC 250 V
Rated voltage:

Nennstrom: 16A
Rated current:

Bauart: EN 60 320, Normblatt C 22
According to:

Schutzart: IP xx
IP-Code

Anschlüsse: Buchsenklemmen
Type of Terminals: Pillar terminals

Kontakte: CuZn 37
Material of Terminals:

Kontaktträger: Steatit
Carrying parts: ceramic

Gehäuse: Metall
Cover:

Approbationen: ENEC VDE
Certified by:

Anmerkung: —
Annotation:

RoHs Konformität: Ja
RoHs Compliance: yes

Ce Kennzeichnung: Ja
Ce Marking: Yes

Altgeräte richtlinie: Nicht zutreffend
WEEE: Not applicable