

Werkstoff/Matière/Material  
.6 = Messing/laiton/brass  
.8 = rostfreier Stahl/acier inox/stainless steel  
.9 = Stahl/acier/steel

= Oberflächen/Surface/Surface-plating  
Seite/page/page 5.011

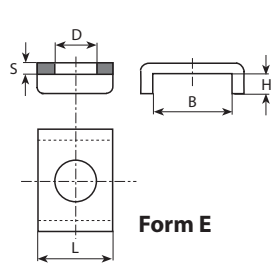

Form E

Klemmbügel

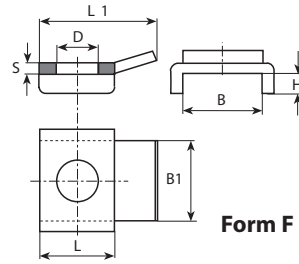

Form F

étriers de serrage

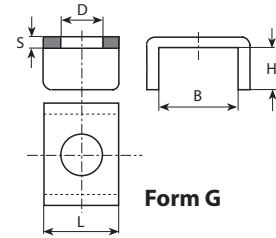

Form G

clamping straps

für Bolzen pour borne for stud mm	Form	øD mm	B mm	L mm	H mm	B1 mm	L1 mm	S mm	Artikelnummer Numéro d'article Part-No.
M3	E	3.2	5.3	6	2			1	6401c.6
	E	3.2	6.2	6	2			1	6402c.6
	E	3.6	6.4	6	2.2			1	6405c.9
	E	3.4	7	6	1			1	6500e.6
	E	3.4	7	6	2.5			1	6501e.6
	G	3.4	7	6	4.5			1	6501g.6
	E	3.6	7	6	2.5			1	6502e.6
M3.5	E	3.9	6.2	6	2			1	6403c.6
	E	3.9	8.1	8	2.5			1	6403e.6
M4	E	4.8	8.4	8	2.5			1.2	64064c.80
	E	4.8	8.4	8	2.5			1.2	64064c.9
	E	4.8	8.5	8	3.5			1.25	64064d.80
	E	4.6	7.2	8.5	3.6			1.5	6407c.6
	E	4.6	7.2	8.5	3.6			1.5	6407c.9
	E	4.5	8.4	8	2.8			1.5	64084c.6
	E	4.5	10.5	8	3.5			1.5	6503e.9
	F	4.5	10.5	8	3.5	9.5	13	1.5	6503f.6
	G	4.5	10.5	8	5.5			1.5	6503g.9
M5	E	4.5	6.9	8.5	3.2			0.8	6506e.9
	E	5.3	8.4	8	2.8			1.2	64065c.9
	E	5.7	10.5	10	2.5			1.5	64085c.6
	E	5.5	12.5	10	4			1.8	6504e.6
	E	5.5	12.5	10	4			1.8	6504e.9
	F	5.5	10.3	10	2.5	10.1	16	1.2	6505e.80
	F	5.5	10.3	10	2.5	10.1	16	1.5	6505f.6
	F	5.5	10.3	10	2.5	10.1	16	1.2	6505k.80
M6	E	5.5	10.3	10	2.5			1.2	6507e.80
	E	7	12.5	12	3.5			1.8	6417c.6
	E	7	12.5	12	3.5			1.8	6417c.80
	E	7	12.5	12	3.5			1.8	6417c.9
M8	G	7	16.2	14	4.8			1.8	6417g.6
	G	8.5	16.2	14	4.8			1.8	6419g.6