

**Linearführung ARC 15 MN**  
**ARC15MN-S1-Z-V0-N-350L-25-25**

---

**cpc** CHIEFTEK PRECISION Co., LTD.

**HEADQUARTERS**  
**CHIEFTEK PRECISION Co., LTD.**  
No.3, Dali 1<sup>st</sup> Rd., Sinshih Township,  
Tainan Science Park, 741-45 Tainan, Taiwan, R.O.C  
TEL:+886-6-505 5858    [Http://www.chieftek.com](http://www.chieftek.com)  
E-mail:service@mail.chieftek.com

**CHIEFTEK PRECISION USA**  
4881 Murietta Street.  
Chino, CA. 91710  
Tel: +1-909-628-9300  
Fax: +1-909-628-7171

**cpc Europa GmbH**  
Industriepark 314,  
D-78244 Gottmadingen, Germany  
TEL: +49-7731-59130-38  
FAX: +49-7731-59130-28

**CHIEFTEK MACHINERY KUNSHAN Co., LTD.**  
No.1188, Hongqiao Rd, Kunshan,  
Jiangsu, P.R. China  
TEL:+86-512-5525 2831  
FAX:+86-512-5525 2851



## Linearführung ARC 15 MN

### ARC15MN-S1-Z-V0-N-350L-25-25

MOD (Modell Code)	ARC15MN
RT (Schienentyp)	Standard
SIZE (Groesse / mm)	15
ST (Dichtungstyp)	S : Standard
BQ (Wagen Anzahl)	1
LSP (Schmierpad)	Z : Mit Schmierpad
BC (Kugelmutter)	ohne Kugelmutter
PC (Vorspannungsklasse)	V0
RL (Schienenlänge / mm)	350
PA (Anfangsbohrung Position)	P1 Standard
P1 (Anfangsbohrung Abstand / mm)	25
P2 (Bohrungsendabstand / mm)	25
AG (Genauigkeitsgrad)	N
POS1 (Position erster Laufwagen / mm)	27.75
POS2 (Position zweiter Laufwagen / mm)	0
POS3 (Position dritter Laufwagen / mm)	0
POS4 (Position vierter Laufwagen / mm)	0
H (H / mm)	24
W2 (W2 / mm)	9.5
W1 (W1 / mm)	15
H1 (H1 / mm)	15
P ( / mm)	60
DXDXG1 (Dxdxg1 / mm)	7.5x4.5x5.3
W (W / mm)	34
L (L / mm)	55.5
L1 (L1 / mm)	40.3
H2 (h2 / mm)	20.7
P1X (P1X / mm)	26
P2X (P2X / mm)	26
MXG2 (Mxg2 / mm)	M4x7
T (T / mm)	6
T1 (T1 / mm)	6
N1 (N1 / mm)	M3x6,5
N2 (N2 / mm)	M3x6
N3 (N3)	P3
E (E / mm)	3.5
S1 (S1 / mm)	4.5
S2 (S2 / mm)	7.5
S3 (S3 / mm)	9.8
S4 (S4 / mm)	10.9
RW (Schienengewicht / g/m)	1290

**cpc** CHIEFTEK PRECISION Co., LTD.

HEADQUARTERS  
CHIEFTEK PRECISION Co., LTD.  
No.3, Dali 1<sup>st</sup> Rd., Sinshih Township,  
Tainan Science Park, 741-45 Tainan, Taiwan, R.O.C  
TEL:+886-6-505 5858 Http://www.chieftek.com  
E-mail:service@mail.chieftek.com

CHIEFTEK PRECISION USA  
4881 Murietta Street.  
Chino, CA. 91710  
Tel: +1-909-628-9300  
Fax: +1-909-628-7171

cpc Europa GmbH  
Industriepark 314,  
D-78244 Gottmadingen, Germany  
TEL: +49-7731-59130-38  
FAX: +49-7731-59130-28

CHIEFTEK MACHINERY KUNSHAN Co., LTD.  
No.1188, Hongqiao Rd, Kunshan,  
Jiangsu, P.R. China  
TEL:+86-512-5525 2831  
FAX:+86-512-5525 2851



**Linearführung ARC 15 MN**  
**ARC15MN-S1-Z-V0-N-350L-25-25**

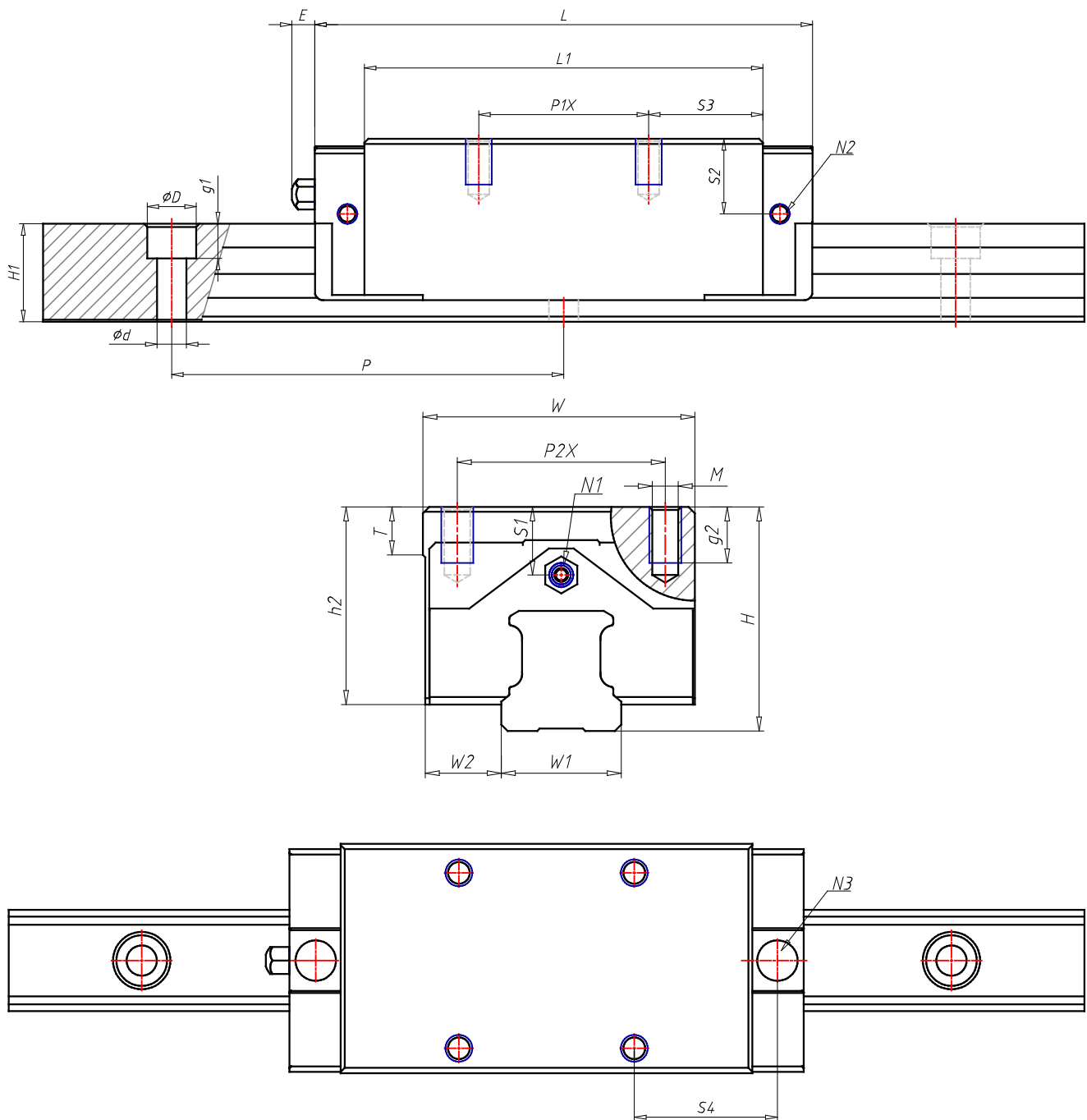

**cpc** CHIEFTEK PRECISION Co., LTD.

HEADQUARTERS  
 CHIEFTEK PRECISION Co., LTD.  
 No.3, Dali 1<sup>st</sup> Rd., Sinshih Township,  
 Tainan Science Park, 741-45 Tainan, Taiwan, R.O.C  
 TEL:+886-6-505 5858 Http://www.chieftek.com  
 E-mail:service@mail.chieftek.com

CHIEFTEK PRECISION USA  
 4881 Murietta Street.  
 Chino, CA. 91710  
 Tel: +1-909-628-9300  
 Fax: +1-909-628-7171

cpc Europa GmbH  
 Industriepark 314,  
 D-78244 Gottmadingen, Germany  
 TEL: +49-7731-59130-38  
 FAX: +49-7731-59130-28

CHIEFTEK MACHINERY KUNSHAN Co., LTD.  
 No.1188, Hongqiao Rd, Kunshan,  
 Jiangsu, P.R. China  
 TEL:+86-512-5525 2831  
 FAX:+86-512-5525 2851

