

MK151

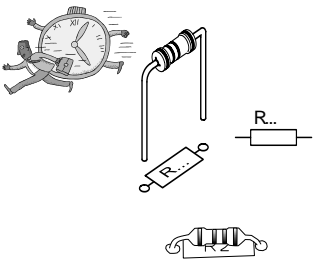

1

Resistor - Weerstand - Résistance - Widerstand - Resistencia - Motstand - Vastus - Resistenze



◇ R1 ... R7, R12 : 270	(Red, Purple, Brown) - (Rood, Paars, Bruin) - (Rouge, Violet, Brun) - (Rot, Violet, Braun) - (Röd, Lila, Brun) - (Punainen, Purppura, Ruskea) - (Rojo, Morado, Marrón) - (Encarnado, Violeta, Castanho) - (Rosso, Viola, Marrone)
◇ R16 : 47K	(Yellow, Purple, Orange) - (Geel, Paars, Oranje) - (Jaune, Violet, Orange) - (Gelb, Violet, Orange) - (Gul, Lila, Orange) - (Keltainen, Purppura, Oranssi) - (Amarillo, Morado, Naranja) - (Amarelo, Violeta, Laranja) - (Giallo, Viola, Aranciato)
◇ R9 : 470	(Yellow, Purple, Brown) - (Geel, Paars, Bruin) - (Jaune, Violet, Brun) - (Gelb, Violet, Braun) - (Gul, Lila, Brun) - (Keltainen, Purppura, Ruskea) - (Amarillo, Morado, Marrón) - (Amarelo, Violeta, Castanho) - (Giallo, Viola, Marrone) - (Gul, Violet, Brun)
◇ R10, R11, R14, R15 : 4K7	(Yellow, Purple, Red) - (Geel, Paars, Rood) - (Jaune, Violet, Rouge) - (Gelb, Violet, Rot) - (Gul, Lila, Röd) - (Keltainen, Purppura, Punainen) - (Amarillo, Morado, Rojo) - (Amarelo, Violeta, Encarnado) - (Giallo, Viola, Rosso)
◇ R13 : 22K	(Red, Red, Orange) - (Rood, Rood, Oranje) - (Rouge, Rouge, Orange) - (Rot, Rot, Orange) - (Röd, Röd, Orange) - (Punainen, Punainen, Oranssi) - (Rojo, Rojo, Naranja) - (Encarnado, Encarnado, Laranja) - (Rosso, Rosso, Aranciato)
◇ R17 : 10K	(Brown, Black, Orange) - (Bruin, Zwart, Oranje) - (Brun, noir, Orange) - (Braun, Schwarz, Orange) - (Brun, Svart, Orange) - (Ruskea, Musta, Oranssi) - (Marrón, Negro, Naranja) - (Castanho, Preto, Laranja) - (Marrone, Nero, Aranciato)
◇ R18 : 100K	(Brown, Black, Yellow) - (Bruin, zwart, Geel) - (Brun, noir, Jaune) - (Braun, Schwarz, Gelb) - (Brun, Svart, Gul) - (Ruskea, Musta, Keltainen) - (Marrón, Negro, Amarillo) - (Castanho, Preto, Amarelo) - (Marrone, Nero, Giallo)

2 DIODE



3 CAPACITOR

CATHODE → D...

◇ D1 : BAT85
◇ D2 ... D4, D6, D7 : 1N4007
◇ D5, D8 : 1N4148

4 IC SOCKET

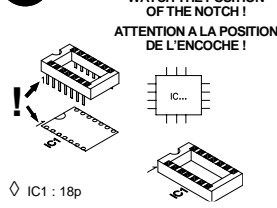

6 TRANSISTOR

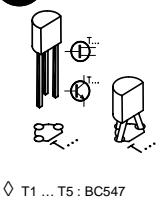

7 VOLTAGE REGULATOR

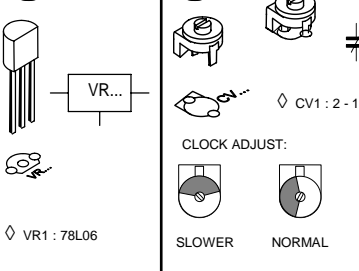

8 TRIM CAPACITOR

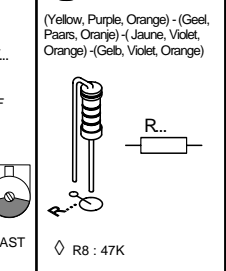

10 ELECTROLYTIC CAPACITORS

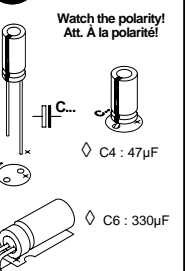

11 DISPLAYS

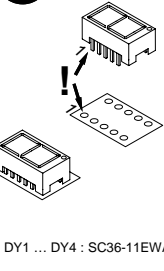

12 LED'S

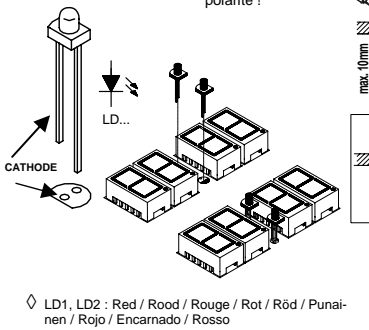

1

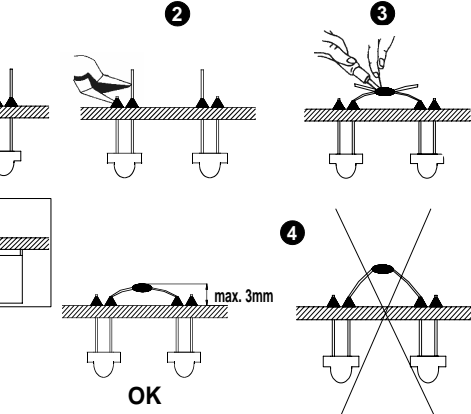

13 CRYSTAL

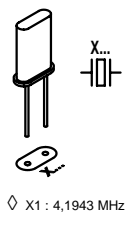

14 IC

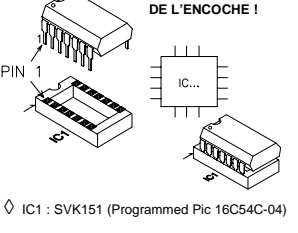

15

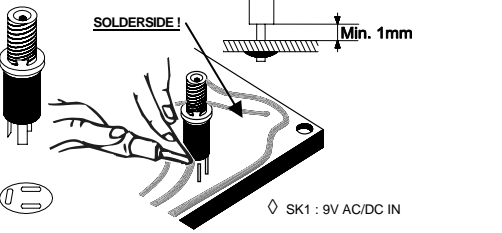

16 PUSH BUTTON

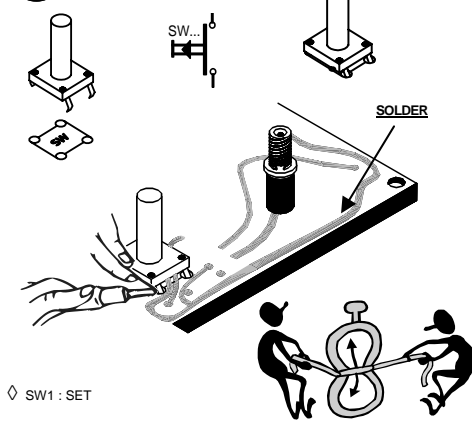

17 BACKUP - BATTERY

