

Supplement

Title:	56x Getting Started	
PN:	3833028	Supplement Issue: 3
Print Date:	Dec. 2010	Issue Date: 3/14
Revision/Date:		Page Count: 3

This supplement contains information necessary to ensure the accuracy of the above manual.

Change #1, 58989, 64912

On page 10, replace the **Specification Summary** table with:

Specifications Summary

See Users Manual on CD for full specifications.

Feature	561	566	568
IR Temperature Range	-40 °C to 550 °C (-40 °F to 1022 °F)	-40 °C to 650 °C (-40 °F to 1202 °F)	-40 °C to 800 °C (-40 °F to 1472 °F)
Accuracy	$<0\text{ °C}: \pm(1\text{ °C} + 0.1\text{ %}/1\text{ °C});$ $\geq 0\text{ °C}: \pm 1\text{ % of reading or } \pm 1\text{ °C, whichever is greater}$ $<32\text{ °F}: \pm(2\text{ °F} + 0.1\text{ %}/1\text{ °F});$ $\geq 32\text{ °F}: \pm 1\text{ % of reading or } \pm 2\text{ °F, whichever is greater}$		
K-Type Thermocouple Input Temperature Range	-40 °C to 550 °C (-40 °F to 1022 °F)	-270 °C to 1372 °C (-454 °F to 2501 °F)	
K-Type Thermocouple Input Temperature Accuracy	Input accuracy $\pm 1\text{ % of reading or } \pm 2\text{ °C} (\pm 1\text{ % of reading or } \pm 4\text{ °F}),$ whichever is greater	$-270\text{ °C to } -40\text{ °C}: \pm(1\text{ °C} + 0.2\text{ %}/1\text{ °C})$ $(-454\text{ °F to } -40\text{ °F}: \pm(2\text{ °F} + 0.2\text{ %}/1\text{ °F}))$ $-40\text{ °C to } 1372\text{ °C}: \pm 1\text{ % of reading or } \pm 1\text{ °C, whichever is greater}$ $(-40\text{ °F to } 2501\text{ °F}: \pm 1\text{ % of reading or } \pm 2\text{ °F, whichever is greater})$	

Change #2, 67464

On page 6, under **561 Display**, add:

Switch Between °C and °F

Open the battery compartment and locate the switch positioned between the left side of the battery near the Thermometer wall. To toggle between °C and °F, use a small screwdriver or paper clip to move the switch to the necessary position. See the Figure below.

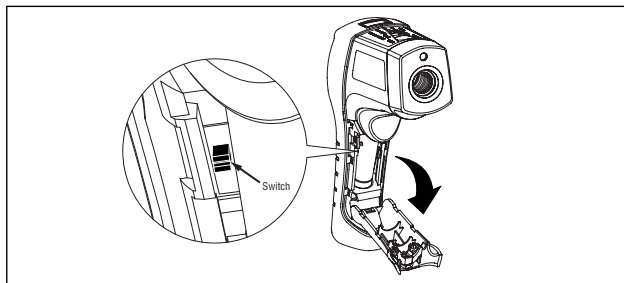

efh012f.eps

561 toggle between °C and °F

On page 11, add the following to the **Specification Summary** table:

Electromagnetic Compatibility	Applies to use in Korea only. Class A Equipment (Industrial Broadcasting & Communication Equipment) ^[1] [1] This product meets requirements for industrial (Class A) electromagnetic wave equipment and the seller or user should take notice of it. This equipment is intended for use in business environments and is not to be used in homes.
--------------------------------------	--