

Contact	Dim A	Dim B	Dim C	Dim D
28	35.56	33.02	15.24	17.78

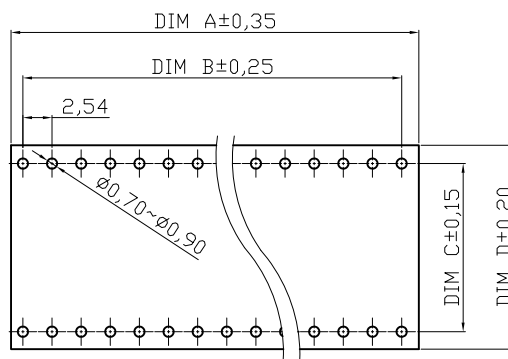

PCB LAYOUT

NOTES

Material:  
 Pin (outer sleeve) : Brass,machined, CuZn38Pb2  
 Clip(contact 4 finger) : Phosphor Bronze  
 Plating Sleeve : 2um/80u"nickel,5um/200u"Tin  
 Clip Plating: 2um/80 u"nickel,Gold Flash  
 Insulator body(black) : Glass filled thermoplastic polyester UL94V-0

Electrical

Current rating : 3 Amps/contact max.  
 Contact resistance :  $\leq 4m\Omega$  /contact  
 Insulation resistance :  $\geq 10000M\Omega$  at 500VAC  
 Rated voltage : 100 VRMS /150VDC

Mechanical

Operating temperature : Gold plated:-55 °C to +125 °C  
 (Continuous) -67 °F to +105 °F  
 Tin plated:-40 °C to +105 °C

Average insertion force with steel pin of:  $\varnothing 0.43mm/0.017"$  < 250g  
 Average withdrawal force with steel pin of  $\varnothing 0.43mm/0.017"$  >50g  
 Mechanical life : min.200

Applications and features:

- 1.The open frame is most common type.
- 2.The open body design gives better access (for cleaning and inspections) to air-cooling.
- 3.Side and end stackable.
- 4.High retention design prevents IC walkout during heavy vibration.
- 5.Closed bottom sleeve for 100% anti-wicking of solder.
- 6.Twist free construction.

Environmental data

Solderability (IEC 60068-2-20. Ta) :235 °C, 2s  
 Resistance to soldering heat (IEC 60068-2-20. Tb) :  
 -Through hole mount components :260 °C, 10s

RoHS compliant

Scale	1:1	Date	20.07.2012	Name	Lucas
TOLERANCE		Drawn	20.07.2012	Winnie	
X.	±0.50	Approved	20.07.2012		
X.X	±0.30				
X.XX	±0.10				
DIM	TOL				
X.°	±1°				
Angle	TOL	© Drawn	20.07.2012	Lucas	
		Id.	Modification	Date	Name



Customer-No.		CONRAD 183834	
ASSMANN WSW-No.		AR 28-HZL-TT	
Drawing-No.	ASS 4909 CO	rev00	
Replace		Sheet	