

1

2

3

4

5

6

7

A

A

B

B

C

C

D

D

E

E

F

F

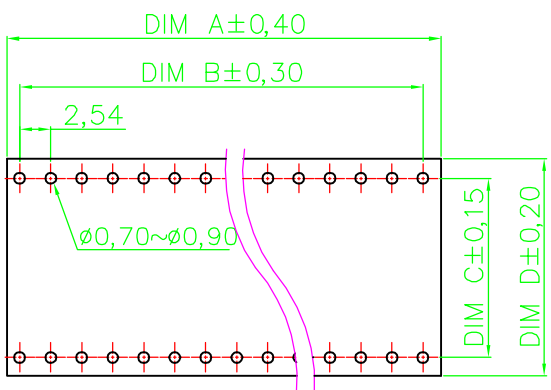
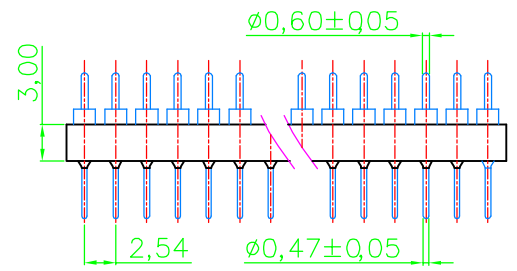
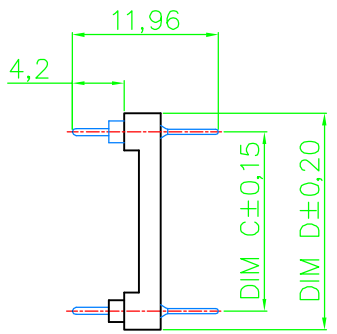
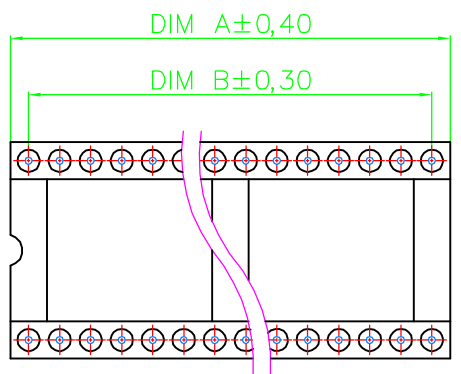

PCB LAYOUT

Technical Data

Material:

Pin (outer sleeve) : Brass,machined, CuZn38Pb2  
 Plating : 2um/80 u"nickel, Gold Flash  
 Insulator body(black) : Glass filled polyester UL94V-0

Electrical

Current rating : 3 Amps/contact max.  
 Insulation resistance :  $\square$  10000M $\Omega$  at 500VAC  
 Rated voltage : 100 VRMS /150VDC

Mechanical

Operating temperature : Gold plated: -550°C to +125°C (Continuous)  
 -67° F to +257° F

Applications and features:

- 1.The male header contacts are designed for "Sandwich application" because The pin of  $\varnothing 0.5mm/0.050"$  can be plugged into a standard IC-contact.
- 2.3 different heights are available.
- 3.Low profile type..
- 4.Side and end stackable.
- 5.Twist free construction.

Environmental data

Solderability (IEC 60068-2-20. Ta) :235° C, 2s  
 Resistance to soldering heat (IEC 60068-2-20. Tb) :  
 -Through hole mount components :260° C, 10s

Contact	Dim A	Dim B	Dim C	Dim D
06	7.62	5.08	7.62	10.16
08	10.16	7.62	7.62	10.16
10	12.70	10.16	7.62	10.16
14	17.78	15.24	7.62	10.16
16	20.32	17.78	7.62	10.16
18	22.86	20.32	7.62	10.16
20	25.40	22.86	7.62	10.16
24	30.48	27.94	15.24	17.78
28	35.56	33.02	15.24	17.78
40	50.80	48.26	15.24	17.78

RoHS compliant

Scale	1:1					Date	Name	Customer-No.
TOLERANCE						Drawn	23.07.2009	Dean
X.	±0.50					Approved	23.07.2009	Hellwig
X.X	±0.30							
X.XX	±0.10							
DIM	TOL							Drawing-No.
X.°	±1°							ASS 1187 CO
		①	Drawn	23.07.2009	Dean			rev01
Angle	TOL	Id.	Modification	Date	Name			Replace

1

2

3

4

5

6

7

svxxx