

# 103-H7823-1740

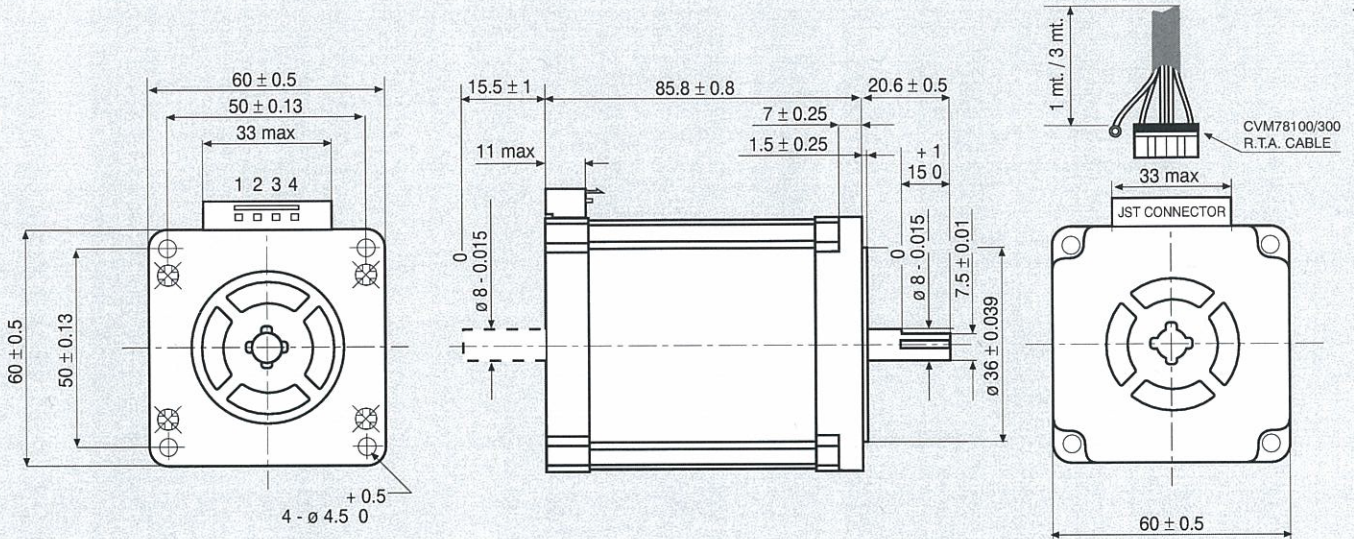

MOTOR CONNECTOR IS JST mod. B4P-VH 4 POLES MALE.  
 FOR CONNECTION USE JST mod. VHR-4N FEMALE CONNECTOR AND mod. SVH-21T-P1.1 CONTACTS.  
**NOTE:** 103-H7823-1740 MOTORS NEED CVM78100 AND CVM78300 R.T.A. CABLES. CONTACT R.T.A. FOR FURTHER DETAILS.

Dimensions in mm.

## FEATURES CARATTERISTICHE

MODEL MODELLO	103 - H7823 - 1740 (103 - H7823 - 1714)
BASIC STEP ANGLE	$1.8^\circ \pm 0.09^\circ$
BIPOLAR CURRENT (Amp)	4.0
UNIPOLAR CURRENT (Amp)	
RESISTANCE (Ohm)	0.65
INDUCTANCE (mH)	2.4
BIPOLAR HOLDING TORQUE (Ncm)	300
UNIPOLAR HOLDING TORQUE (Ncm)	
ROTOR INERTIA ( $\text{Kgm}^2 \times 10^{-7}$ )	840
THEORETICAL ACCELERATION ( $\text{rad} \times \text{sec}^{-2}$ )	35700
BACK E.M.F. (V/Krpm)	75
MASS (Kg)	1.4
LEADS CODE	V

Codes between brackets refer to double shaft models.  
 Le sigle fra parentesi si riferiscono ai modelli bialbero.

## TORQUE/SPEED CURVE CURVA DI COPPIA/VELOCITÀ

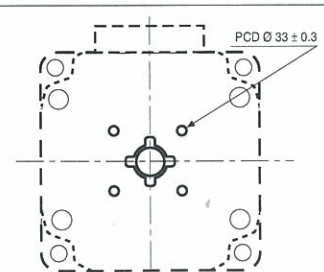
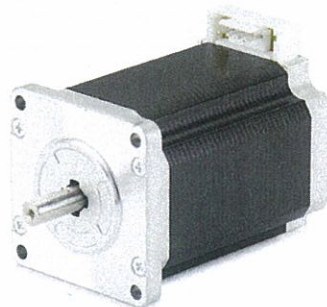
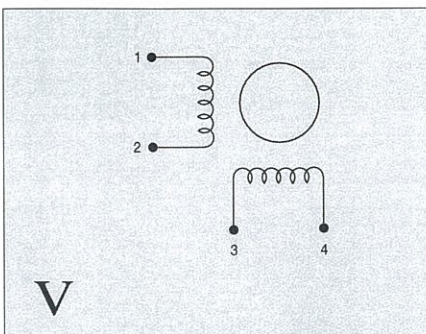
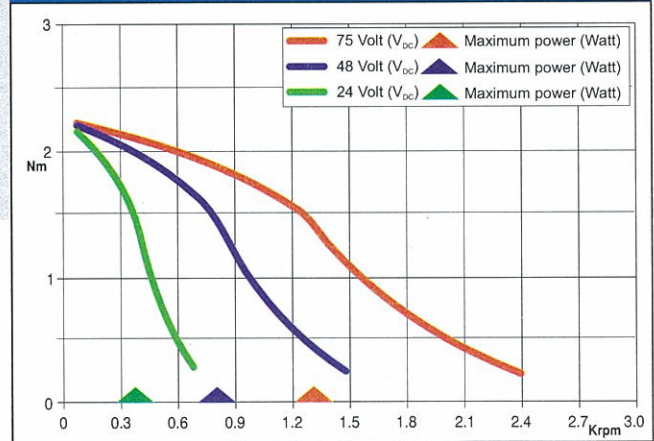

DOUBLE SHAFT MOTORS ONLY.  
 4-M3X0.5 THREADED HOLES. TAP DEPTH 8 mm.