

Sealed Rechargeable Cylindrical cell Nickel Metal Hydride

SC-2000 mAh

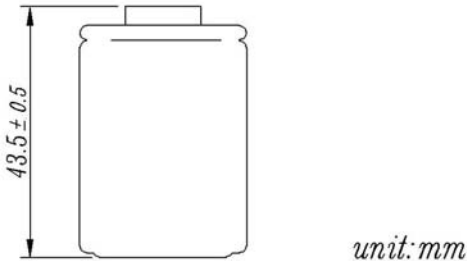
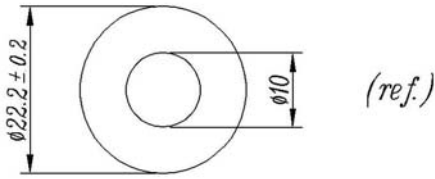

Date Sheet

Type-----EnrichpowerSC2000
System-----Sealed rechargeable Ni-MHCylindrical cell
Nominal Voltage-----1.2V
Application-----Discharge current 200mA to 20A (Continuous)

Capacity (discharged at 0.2C to 1.0v at 20°C)

Nominal 2000mAh
 Minimum 1900mAh
 Typical 2000mAh

Internal resistance (at 1 kHz)

Fully charged, 20°C (approx) --- 5 ~ 7mΩ

Weight approx-----40g

Dimensions(including shrink sleeve)

-Diameter -----22.2(±0.2mm)

-Height -----43.5(±0.5mm)

Cd content(%cell w):-----0%

Typical Discharge time & Avg. Voltage (20°C)

30A--240S--1.10V (TURBOMATCHER , discharged at 30A to

0.9v at 20°C)

Max. discharge current(continuous)-----20C

Charging conditions(20°C)

standard charge-----200mA 14h

quick charge-----2000mA 1.1h

fast charge -----2A to 6A

Charge termination control recommended control parameter

-ΔV 5mV

DT/dt 0.8°C/min(0.5-1C)

0.8°C-1°C/min(>1C)

TCO 40-45°C

Timer 105%nominal input

Continuous 100mA maximum current for 1 year

Overcharge No conspicuous deformation and/or leakage

Max. charging voltage 1.5V at 200mA charging

Operation temperatures(recommended)

Fast Charge (Charge Control required)
Voltage(V)

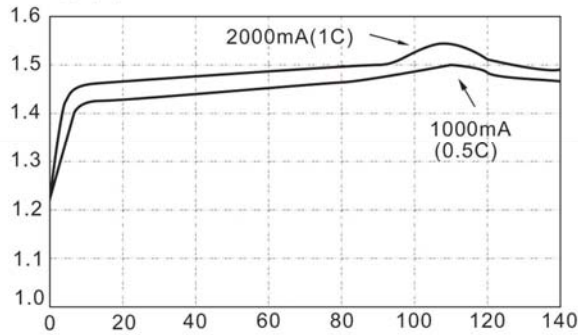

Low Rate Discharge
Voltage(V)

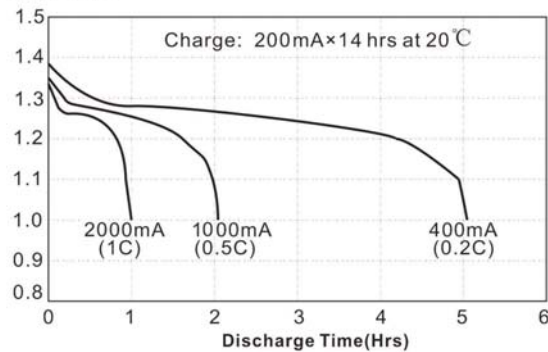

High Rate Discharge
Voltage (V)

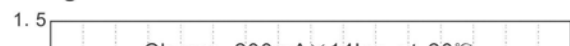

Storage----- -20°C up to +35°C

Discharge----- -20°C up to +50°C

standard charge----- 0°C up to +40°C

quickcharge,fastcharge--10°C upto+40°C

permanent charge-----+10°C up to +45°C

Life expectancy(20°C)----->500 cycles