

**Sealed Rechargeable Cylindrical cell Nickel Metal Hydride**

SC-4200 mAh

**Date Sheet**

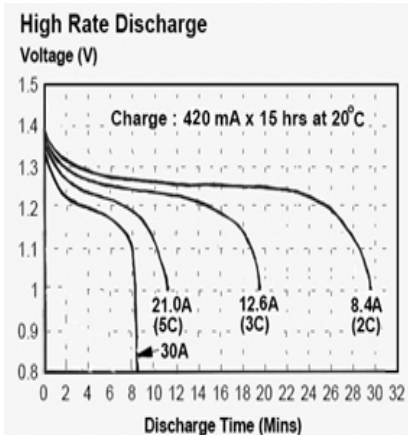
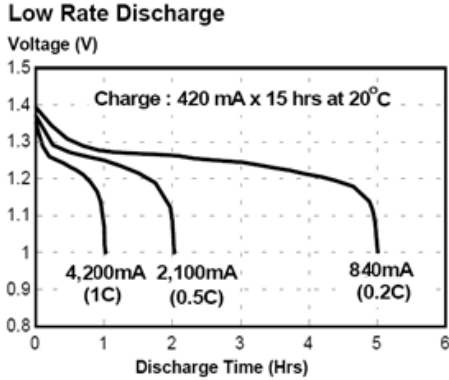
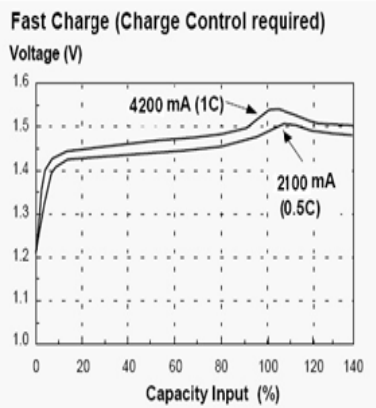
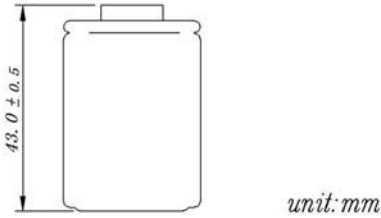
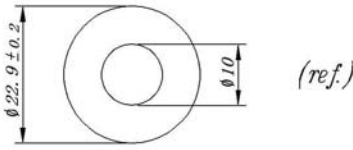

**Type**-----EastpowerSC4200

**System**-----Sealed rechargeable Ni-MHCylindrical cell

**Nominal Voltage**-----1.2V

**Application**-----Discharge current 420mA to 30A (Continuous)

**Capacity** (discharged at 0.2C to 1.0v at 20□)

Nominal 4200mAh

Minimum 4100mAh

Typical 4200mAh

**Internal resistance** (at 1 kHz)

Fully charged,20□(approx)---1.6□1.8mΩ

**Weight approx**-----69g

**Dimensions**(including shrink sleeve)

-Diameter -----22.9 (±0.2mm)

-Height -----43.0(±0.5mm)

**Cd content(%cell w)**:-----0%

**Typical Discharge time&Avg.Voltage** (20□)

30A--510S--1.235V (TURBOMATCHER□ discharged at 30A to 0.9v at 20□)

**Max.discharge current**(continuous)-----20C

**Charging conditions**(20□)

standard charge-----420mA 14h

quick charge-----4200mA 1.1h

fast charge -----2A to 6A

Charge termination control recommended control parameter

-ΔV 5mV

DT/dt 0.8□/min(0.5-1C)

0.8□-1□/min(>1C)

TCO 40-45□

Timer 105%nominal input

**Continuous** 100mA maximum current for 1 year

**Overcharge** No conspicuous deformation and/or leakage

**Max.charging voltage** 1.5V at 420mA charging

**Operation temperatures**(recommended)

Storage----- -20□ up to +35□

Discharge----- -20□ up to +50□

standard charge----- 0□ up to +40□

quickcharge,fastcharge--10□ upto+40□

permanent charge-----+10□ up to +45□

**Life expectancy**(20□)----->500 cycles