

Ni-MH rechargeable cylindrical cell (Data Sheet)

Specification

Nominal Voltage		1.2V	
Dimensions	Diameter	25.2±0.2mm	
	Height	50.0±0.3mm	
	Apx. Weight	67g	
0.2C Discharge Capacity	Typical	2250mAh	
	Nominal	2200mAh	
Typical Internal Impedance		Less than 20mΩ	
Charge	Standard	220mA for 16hrs	
	Fast	2200mA for about 75min	
Life expectancy		500 cycles	
Operating Temperature	Charge	Standard	0°C to 40°C
		Fast	10°C to 40°C
	Discharge		-10°C to 50°C
	Storage	<1 year	-10°C to 30°C
<3 months		-10°C to 40°C	

(CELL DIMENSIONS)

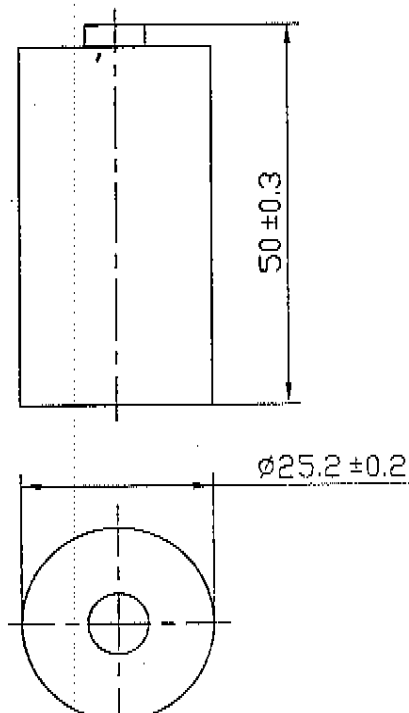

CHARGE CHARACTERISTICS

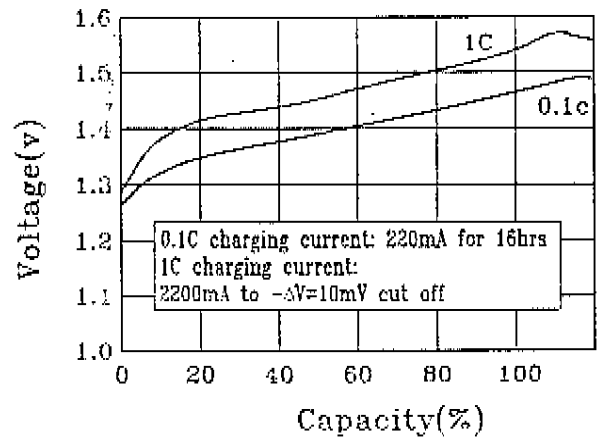

DISCHARGE CHARACTERISTICS

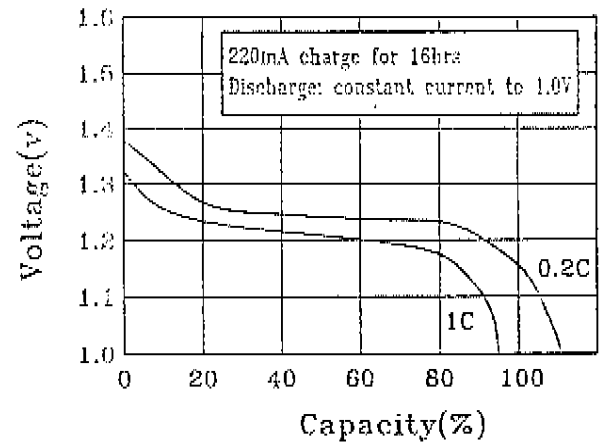

DISCHARGE CHARACTERISTICS AT DIFFERENT TEMPERATURE

