

NPC SERIES - NPC24-12I

The low maintenance and valve regulated constructions combine with heavy-duty plates and unique separator systems to make NPC service twice as long as conventional counterparts.

FEATURES

1. Double cycle life

NPC operates 500 charge/discharge cycles or twice as many cycles as conventional cycle use batteries at 75%D.O.D. (depth of discharge).

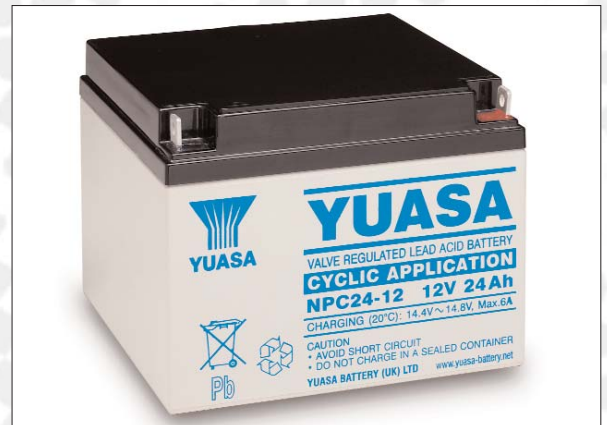

CYCLE SERVICE LIFE IN RELATION TO DEPTH OF DISCHARGE AT 75% DOD

TESTING CONDITIONS

Capacity test 0.17CA (FV 10.2V)
 Life test 0.25CA, 3 hours
 CHARGING: 14.6V, 9 HOURS
 MAX. CHARGING CURRENT: 0.25CA
 AMBIENT TEMPERATURE: 25°C (77°F)

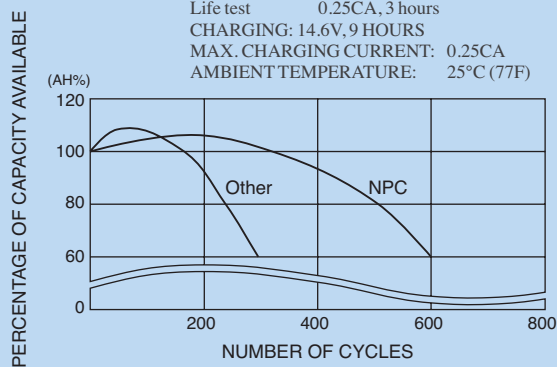

2. Valve-regulated and maintenance-free

Battery electrolyte retained solidly in the separator and the innovative gas recombinant system allows minimum gas emittance freeing the user from maintenance.

3. Durability for deep discharge use

Yuasa's state-of-the-art plate barrier prevention and the unique separator systems help endure deep discharge use thus considerably prolonging battery's service life.

4. Minimal self-discharge

Cyclic use batteries tend to be left discharged after usage causing plate corrosion leading to shortened life. Self discharge rate of NPC is as small as only 0.1% a day at 20°C and thus extends the storage period allowed.

Operating temperature range

Charge: -15 ~ 50°C (5 ~ 122°F)
 Discharge: -15 ~ 50°C (5 ~ 122°F)
 Storage: -20 ~ 50°C (-4 ~ 122°F)

Specifications

NPC Model	Volts	Rated Capacity (20 hr rate) (Ah)	Approx. Dimensions			Weight	Layout	Terminals
			Length	Width	Overall height incl. terminals			
NPC24 - 12I	12	24	175mm	166mm	125mm	8.8kg	2	J

Recommended charging method

Current: Max. 0.25CA Voltage: 2.4 ~ 2.5VPC

Applications

- Wheelchairs • Golf trolley • Lawn mowers • Lights
- Toy cars • Sprayers • Photovoltaics • Robots
- Communications • Electric tools • Pumps
- Measuring instruments • AGV (Automatic guided vehicle)
- Magnetic lifts

Terminals

Terminal J

Terminal	x	y
J:	17mm	M5

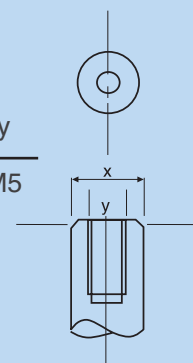

Layout

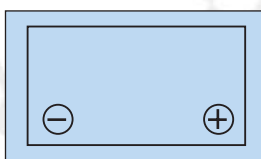

CAUTION

- Avoid short circuit.
- Do not charge in a sealed container.
- Service life and operational characteristics will be affected by temperature.
- AC Ripple reduces service life.

Performance

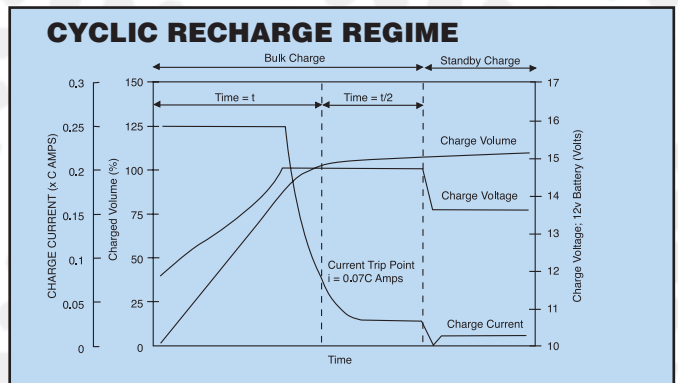
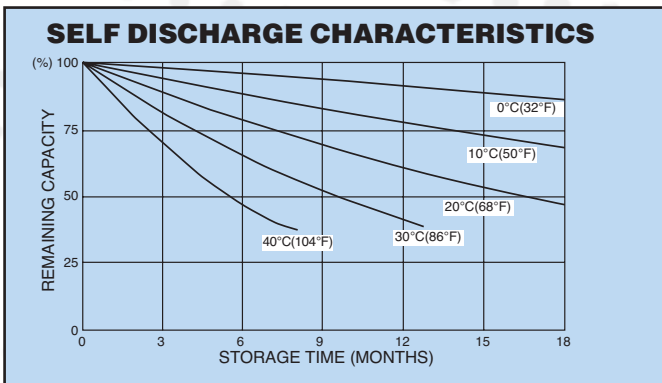
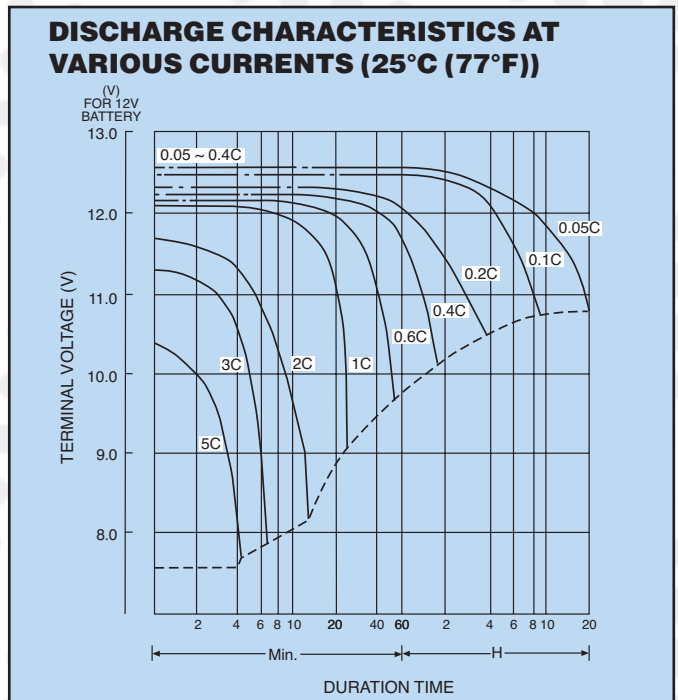
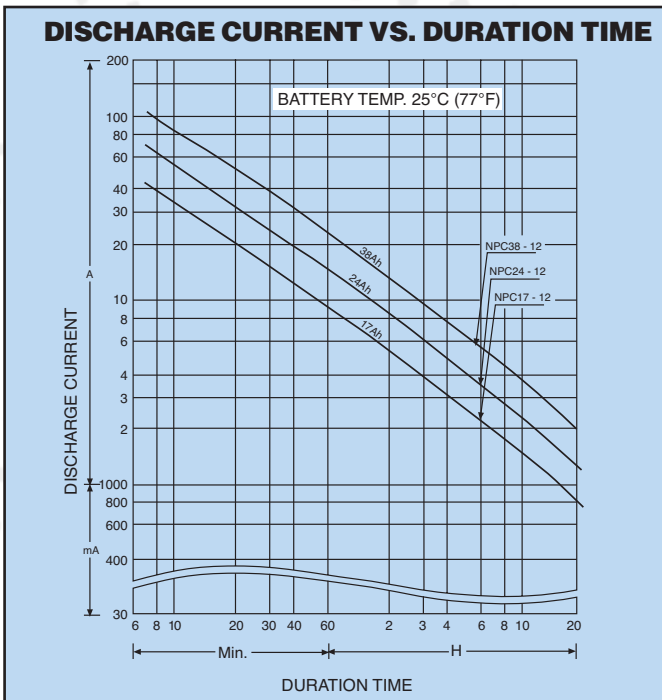
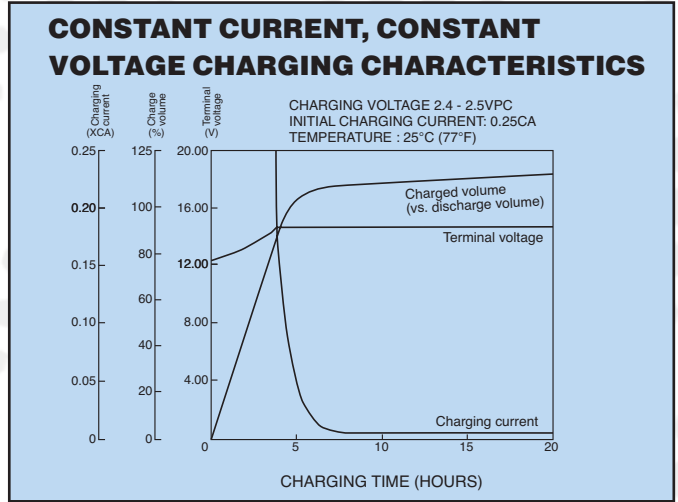
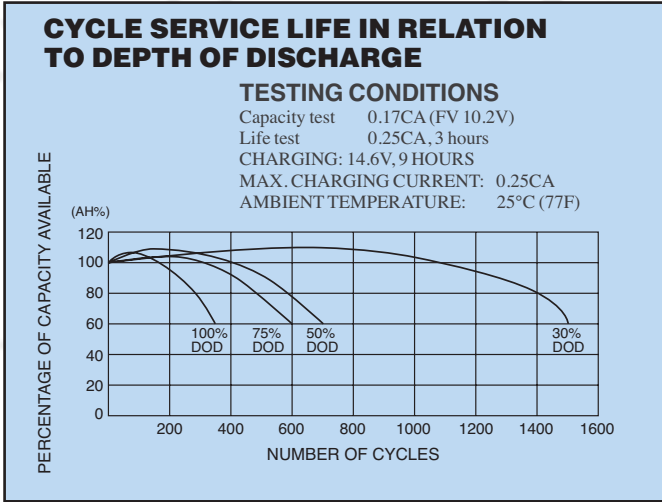

Yuasa Battery Sales (UK) Ltd
 Unit 22 Rassau Industrial Estate
 Ebbw Vale, Gwent, NP23 5SD
 Tel: 08708 500312 Fax: 08708 500317
 E-mail: enquiries@yuasa-sales.co.uk

Registered number 1548820

Cat. No. NPC24-12I February 07

E&O.E.

Distributed by