

# Technical Manual



# JBL CSS8018

## SPECIFICATIONS

### ACOUSTIC & ELECTRICAL SPECIFICATIONS:

- Nominal Impedance: 8 Ohms
- Driver Power Handling: 20W
- Frequency Range (- 10 dB):  
Driver/Grille Assembly: 50 Hz - 17 kHz  
Installed in CSS-BB  
BACKCAN: 90 Hz - 17 kHz
- Driver Sensitivity (mid-range)  
(1W [2.83V], 1m, 2k - 6k Hz):97 dB

### SYSTEM COMPONENTS:

- Transducer: 200 mm (8 in) speaker, 25 mm (1 in) diameter voice coil with a Kapton™ coil-former
- DC Resistance: 7.8 ohm

### AURAL SWEEP TEST SPECIFICATIONS:

A. System Aural Sweep Test: 25V Input (2.5W Tap), 50 Hz to 18 kHz

### PHYSICAL SPECIFICATIONS:

- Net Weight (ea): 3.5 lb (1.58 kg.)

### WARRANTY INFORMATION:

- Refer to Warranty Statement packed with each product.
- Transformer Taps:

	Orange	Green	Gray	Yellow	Black
25V	1.3W	2.5W	5W	10W	COM
	White	Blue	Brown	Orange	Black
70V	1.3W	2.5W	5W	10W	COM
100V	2.5W	5W	10W	N/C	COM

## PACKAGE

- Warranty Card  
59660
- Instruction Sheet  
445673-001
- Carton  
445678-001
- Inner Carton  
445677-001
- Inside Carton Wrap  
Liner  
455676-001
- Main PE Bag  
445674-001

Accessory Bag  
445675-001

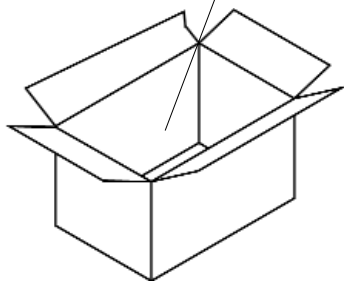

## COMPONENT EXPLODED VIEW

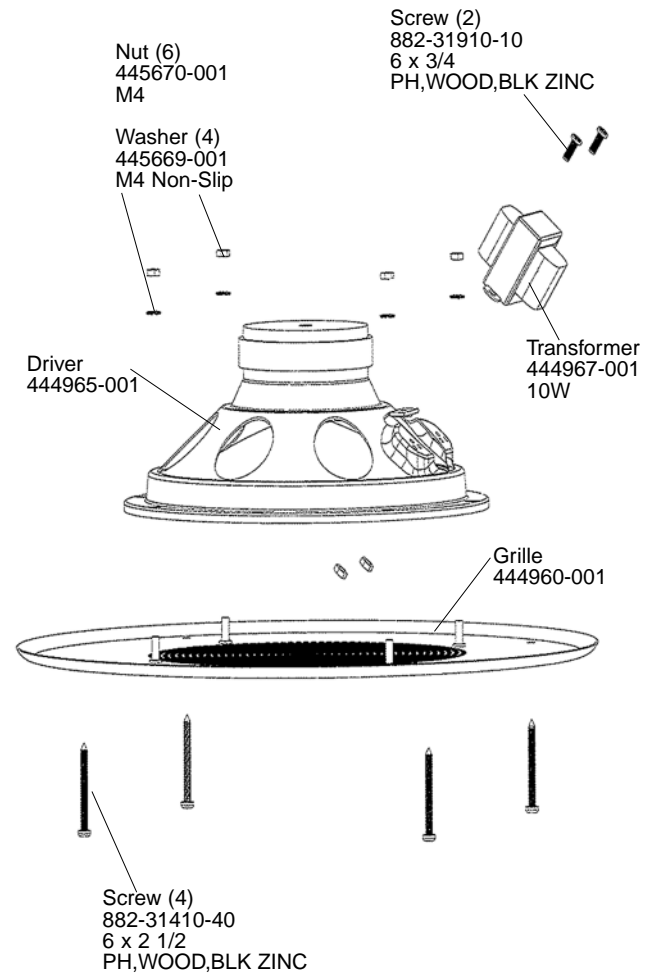

JBL CSS8018 REV A



# CSS8018

Commercial Series Ceiling Speaker

# INSTALLATION INSTRUCTIONS

1. Install according to diagram.
2. Connect leads according to Tap Wiring chart.
3. Cut off bare portion of unused leads and terminate with wire nuts.

Note: Always install in accordance with applicable electrical and building codes.

### Tap Wiring:

	Orange	Green	Gray	Yellow	Black
<b>25V</b>	1.3W	2.5W	5W	10W	COM
	White	Blue	Brown	Orange	Black
<b>70V</b>	1.3W	2.5W	5W	10W	COM
<b>100V</b>	2.5W	5W	10W	N/C	COM



JBL Professional  
8500 Balboa Boulevard, P.O. Box 2200  
Northridge, California 91329 U.S.A.

### Tile Rails CSS-TR4/8 (x2)

Secure to ceiling/grids in manner required by local building code.

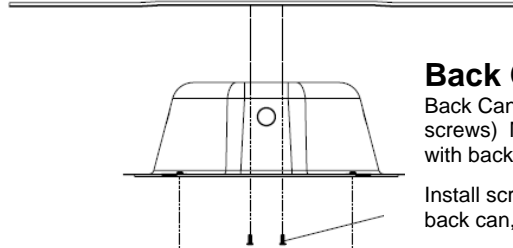

### Back Can CSS-BB8

Back Can / Tile Rail screws (machine screws) M4 x 8 mm (4 places, packaged with back can)

Install screw through thru-hole in back can, and screw into tile rail.

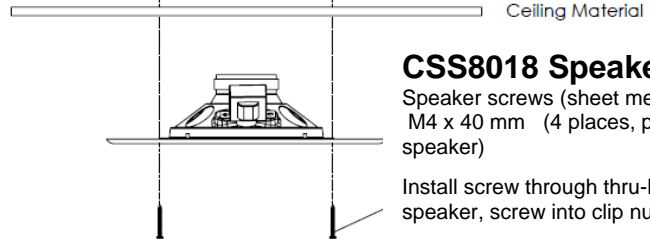

### CSS8018 Speaker

Speaker screws (sheet metal screws) M4 x 40 mm (4 places, packaged with speaker)

Install screw through thru-hole in speaker, screw into clip nut in back can.