

# PISG

Engineer's Kit : EK-PISG



Part No	Inductance L (μH)	f <sub>L</sub> (MHz) ± (%)	Tol ± (%)	SRF min (MHz)	DCR max (Ω)	Rated DC Current (A)	
						I <sub>sat</sub>	I <sub>ΔT = 30°C</sub>
PISG-1R0M-01	1	0.1	20	130	0.05	2.9	2.9
PISG-1R5M-01	1.5	0.1	20	115	0.06	2.6	2.8
PISG-2R2M-01	2.2	0.1	20	90	0.07	2.3	2.4
PISG-3R3M-01	3.3	0.1	20	70	0.08	2	2
PISG-4R7M-01	4.7	0.1	20	50	0.09	1.5	1.5
PISG-6R8M-01	6.8	0.1	20	45	0.13	1.2	1.4
PISG-100M-01	10	0.1	20	35	0.16	1.1	1.1
PISG-150M-01	15	0.1	20	30	0.23	0.9	1.2
PISG-220M-01	22	0.1	20	20	0.37	0.7	0.8
PISG-270M-01	27	0.1	20	15	0.51	0.65	0.7
PISG-330M-01	33	0.1	20	15	0.51	0.58	0.6
PISG-470M-01	47	0.1	20	14	0.64	0.5	0.5
PISG-560M-01	56	0.1	20	11	0.86	0.4	0.4
PISG-680M-01	68	0.1	20	11	0.86	0.4	0.4
PISG-101M-01	100	0.1	20	9	1	0.4	0.3
PISG-151M-01	150	0.1	20	6	2	0.27	0.25
PISG-221M-01	220	0.1	20	5.5	3.11	0.22	0.2
PISG-331M-01	330	0.1	20	5	3.8	0.18	0.16
PISG-471M-01	470	0.1	20	4	5.06	0.16	0.15
PISG-561M-01	560	0.1	20	3	9	0.15	0.15
PISG-681M-01	680	0.1	20	3	9.2	0.14	0.12
PISG-102M-01	1000	0.1	20	2	13.8	0.1	0.07

Material : Ferrite

Remark : I<sub>sat</sub> & I<sub>ΔT</sub> - see description in inductors  
Technical Data page 58

SPQ : Reel 750 [-01]

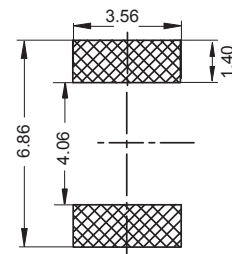
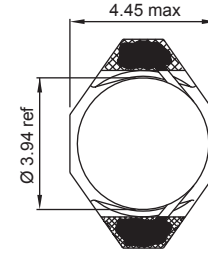
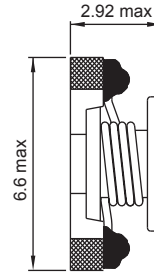

Recommended Layout for solder pads

Typical L vs Frequency(f)

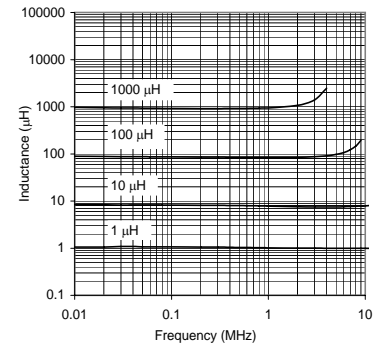

All dimensions in mm

SMD Power Inductors & Shielded