



AYVZ2.E122965 Attachment Plugs with Overload Protection - Component

[Page Bottom](#)

Attachment Plugs with Overload Protection - Component

[See General Information for Attachment Plugs with Overload Protection - Component](#)

E122965

Power inlets, Cat. Nos. 0713, 0717, 0717-1.

Cat Nos. 0725, 0725-1, 0726, 0726-1.

Appliance inlets, Cat. No. 0717-2 followed by P, C or F, followed by S, LS, Q or W, followed by two digits.

0717-1 Series: Models 0717-1-PS, 0717-1-PLS, 0717-1-PQ, 0717-1-PW may be followed by three alphanumeric digits; **0717-1S Series** Models 0717-1S-PS, 0717-1S-PLS, 0717-1S-PQ, 0717-1S-PW may be followed by three alphanumeric digits.

Appliance inlets with overcurrent protector, 0717-2S Series: Model 0717-2S followed by C or P, followed by Q or S.

Marking: Company name and catalog or model designation on device or carton.

[Last Updated](#) on 2008-06-18

[Questions?](#)

[Notice of Disclaimer](#)

[Page Top](#)

[Copyright © 2009 Underwriters Laboratories Inc.®](#)

The appearance of a company's name or product in this database does not in itself assure that products so identified have been manufactured under UL's Follow-Up Service. Only those products bearing the UL Mark should be considered to be Listed and covered under UL's Follow-Up Service. Always look for the Mark on the product.

UL permits the reproduction of the material contained in the Online Certification Directory subject to the following conditions: 1. The Guide Information, Designs and/or Listings (files) must be presented in their entirety and in a non-misleading manner, without any manipulation of the data (or drawings). 2. The statement "Reprinted from the Online Certifications Directory with permission from Underwriters Laboratories Inc." must appear adjacent to the extracted material. In addition, the reprinted material must include a copyright notice in the following format: "Copyright © 2009 Underwriters Laboratories Inc.®"

An independent organization working for a safer world with integrity, precision and knowledge.





AYVZ8.E122965

Attachment Plugs with Overload Protection Certified for Canada - Component

[Page Bottom](#)

Attachment Plugs with Overload Protection Certified for Canada - Component

[See General Information for Attachment Plugs with Overload Protection Certified for Canada - Component](#)

E122965

Appliance Inlets, 0717-1 Series: Models 0717-1-PS, 0717-1-PLS, 0717-1-PQ, 0717-1-PW maybe followed by three alphanumeric digits; **0717-1S** Series: Models 0717-1S-PS, 0717-1S-PLS, 0717-1S-PQ, 0717-1S-PW maybe followed by three alphanumeric digits.

Appliance inlets with overcurrent protector , 0717-2S Series: Model 0717-2S, followed by C or P, followed by Q or S.



Marking: Company name, model designation and Recognized Component Mark for Canada

[Last Updated](#) on 2008-02-08

[Questions?](#)

[Notice of Disclaimer](#)

[Page Top](#)

Copyright © 2009 Underwriters Laboratories Inc.®

The appearance of a company's name or product in this database does not in itself assure that products so identified have been manufactured under UL's Follow-Up Service. Only those products bearing the UL Mark should be considered to be Listed and covered under UL's Follow-Up Service. Always look for the Mark on the product.

UL permits the reproduction of the material contained in the Online Certification Directory subject to the following conditions: 1. The Guide Information, Designs and/or Listings (files) must be presented in their entirety and in a non-misleading manner, without any manipulation of the data (or drawings). 2. The statement "Reprinted from the Online Certifications Directory with permission from Underwriters Laboratories Inc." must appear adjacent to the extracted material. In addition, the reprinted material must include a copyright notice in the following format: "Copyright © 2009 Underwriters Laboratories Inc.®"

An independent organization working for a safer world with integrity, precision and knowledge.



ZEICHENGENEHMIGUNG MARKS APPROVAL

ist berechtigt, für ihr Produkt /
is authorized to use for their product

Gerätestecker mit integriertem Gerätesicherungshalter
Appliance inlet with integrated fuse-holder

die hier abgebildeten markenrechtlich geschützten Zeichen
für die ab Blatt 2 aufgeführten Typen zu benutzen /
the legally protected Marks as shown below for the types referred to on page 2 ff.



Geprüft und zertifiziert nach /
Tested and certified according to

DIN EN 60127-1 (VDE 0820-1):2007-02; EN 60127-1:2006
DIN EN 60320-1 (VDE 0625-1):2008-05; EN 60320-1:2001 + A1:2007
DIN EN 60127-6 (VDE 0820 Teil 6):2003-10; EN 60127-6:1994+ A1:1996+ A2:2003

VDE Prüf- und Zertifizierungsinstitut GmbH
Testing and Certification Institute
Zertifizierungsstelle / *Certification*

VDE Zertifikate sind nur gültig bei Veröffentlichung unter
VDE certificates are valid only when published on

Aktenzeichen: 1391600-1550-C018 / 103213
File ref.:

Ausweis-Nr. 40022412 Blatt 1
Certificate No. Page

Weitere Bedingungen siehe Rückseite und Folgeblätter /
further conditions see overleaf and following pages

Offenbach, 2007-10-18
(letzte Änderung/updated 2009-02-26)

<http://www.vde.com/zertifikat>
<http://www.vde.com/certificate>

Aktenzeichen / File ref.
1391600-1550-0018 / 103213 / FG31 / E

letzte Änderung / updated Datum / Date
2009-02-26 2007-10-18

Dieses Blatt gilt nur in Verbindung mit Blatt 1 des Zeichengenehmigungsausweises Nr. 40022412.
This supplement is only valid in conjunction with page 1 of the Certificate No. 40022412.

Gerätestecker mit integriertem Gerätesicherungshalter
Appliance inlet with integrated fuse-holder

Typ(en) / Type(s):

- 1 0717
- 2 0717-1
- 3 **0717-1S**

Bemessungsspannung AC 250 V
Rated voltage

Bemessungsstrom 10 A
Rated current

Bemessungswert der zul. 1,6 W / 10 A
Verlustleistung
Rated power acceptance

Polzahl 2-polig mit Schutzkontakt
Number of poles 2-pole with earthing contact

Bauart Normblatt C14
Kind of construction standard sheet C14

Ausführung(en) mit Montagerahmen für Geräteschalter entsprechend EN 61058-1
Construction(s) with mounting frame for switches for appliances according to EN 61058
Für / for 3

Kategorie PC 2
Category

Stifttemperatur max. 70°C
Temperature of the pins

Fortsetzung siehe Blatt 3 /
continued on page 3



CERTIFICATE FOR CHINA COMPULSORY PRODUCT CERTIFICATION

No. : 2003010204074306

NAME, MODEL AND SPECIFICATION

10A 250V Appliance Inlet for Class I Equipment for Cold Conditions; 10A 250V Appliance Inlet for Class I Equipment for Cold Conditions with FUSE-HOLDERS
0707-1, 0707-2, 0711, 0711-1, 0711-1RS, 0711-1RS-PQ, 0711-1RS-PS, 0711-1RS-PSG, 0711-2, 0711-SCQ, 0711-SCS, 0711-SPQ, 0711-SPS, 0714, 0714-1, 0714-P 10A 250V~; 0717, 0717-1, 0717-1S 10A 250V~

THE STANDARDS AND TECHNICAL REQUIREMENTS FOR THE PRODUCTS

GB17465.1-2009

This is to certify that the above mentioned products have met the requirements of implementation rules for compulsory certification (REF NO. CNCA-01C-006:2001).

Date of issue: Jul. 08, 2011 Date of expiry: Oct. 13, 2014

Validity of this certificate is subject to positive result of the regular follow up inspection by issuing certification body until the expiry date.

Date of original certification: Aug. 04, 2003

This certificate can be verified through CNCA's website: www.cnca.gov.cn



President:

Wang Kejiao

CHINA QUALITY CERTIFICATION CENTRE

Section 9, No. 188, Nansihuan Xilu, Beijing 100070 P.R. China

<http://www.cqc.com.cn>



SPECIFICATION

- A: MATERIAL:
 1. HOUSING: PC, UL 94V-0
 2. TERMINAL: COPPER ALLOY, TIN PLATED
- B: CHARACTERISTICS:
 1. RATING: 10A 250V~ EUROPE
 10A 250V~ NORTH AMERICA
 2. INSULATION RESISTANCE : 100MΩ MIN. AT 500V DC
 3. ELECTRIC STRENGTH: AC 2000V FOR ONE MINUTE
 4. FUSE: φ5X20mm
- C: APPROVALS: UL, CUL, VDE, & CCC
- D: EQUIVALENT CIRCUIT



E: ORDERING INFORMATION:

P/N	PANEL THICKNESS	SOCKET'S TERMINAL	SWITCH'S TERMINAL
0717-1S-PQ08N-A	0.8 mm	φ2.80x3.5	1.8 4.2
0717-1S-PQ10N-A	1.0 mm	φ2.80x3.5	1.8 4.2
0717-1S-PQ12N-A	1.2 mm	φ2.80x3.5	1.8 4.2
0717-1S-PQ14N-A	1.4 mm	φ2.80x3.5	1.8 4.2

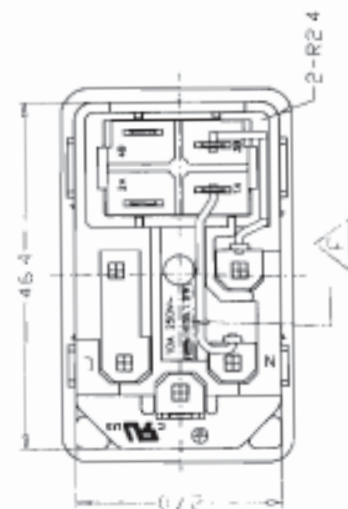
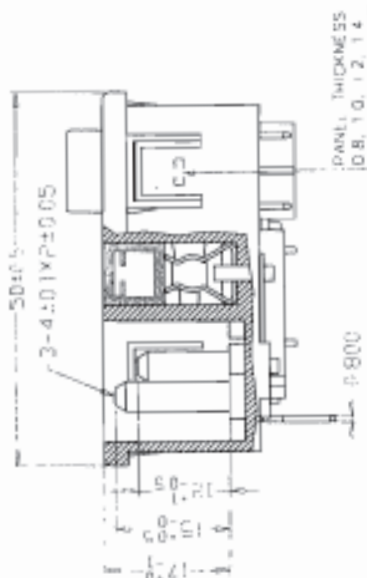
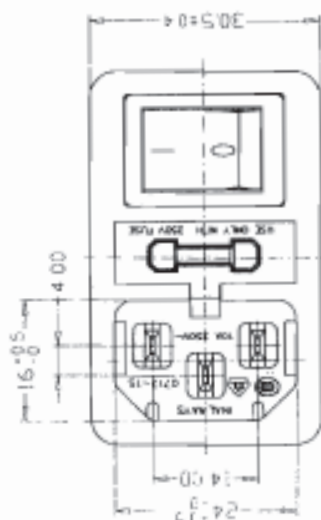
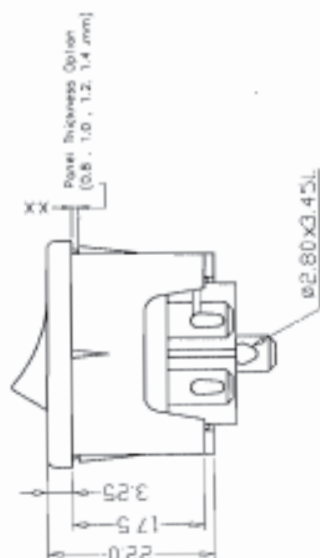
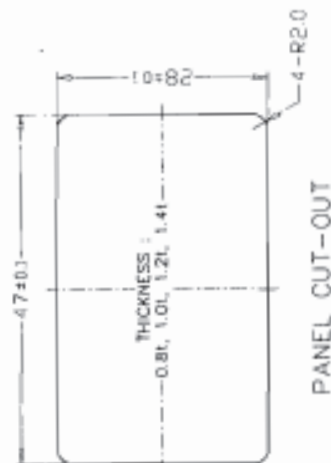

REV	DATE	DOCUMENT	DESCRIPTION
J			
I			
H			
G			
F	2008.03.07	DCR08012	MARK RELOCATE

TOLERANCE UNLESS OTHERWISE MARKED	
DIMENSION	±0.1
Ø	±0.1
ANGLE	±0.3

UNIT	SCALE	SHEET
mm	1:1	1 of 1

PART NO.: 0717-1S	NAME: AC INLET 3P WITH SWITCH & FUSE HOLDER (SNAP-IN)
MATERIAL: SEE ABOVE	SPEC: IEC 60320-1, C14
APPROVED CHECKED: [Signature]	DESIGNER NOTE: IEC 60127-6
日期: 2011-9-16 圖號: 0717-1S 製圖: 李嘉琦 審核: [Signature]	