

**SBC choke (Small Bobbin Core)**  
**Rated current 0,055 to 0,725 A**  
**Rated inductance 1 to 1000  $\mu$ H**

**Construction**

- Mini ferrite drum core
- Winding: enamel copper wire
- Flame-retardant lacquer coating

**Features**

- Small size
- Relatively high rated current

**Applications**

- RF blocking and filtering
- Decoupling and interference suppression
- For electronic household appliances, automotive and entertainment electronics

**Terminals**

- Central axial leads, tinned
- Radially bent to 5 mm lead spacing

**Marking**

Inductance indicated by color bands in accordance with IEC 62

**Delivery mode**

Taped and reeled

For details on taping, packing and packing units [see page 435](#).

**Outline drawing**

B82141-A (axial leads, taped)

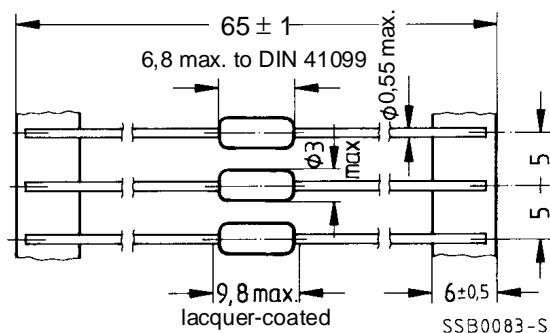

Minimum lead spacing 10 mm  
 approx. weight 0,22 g

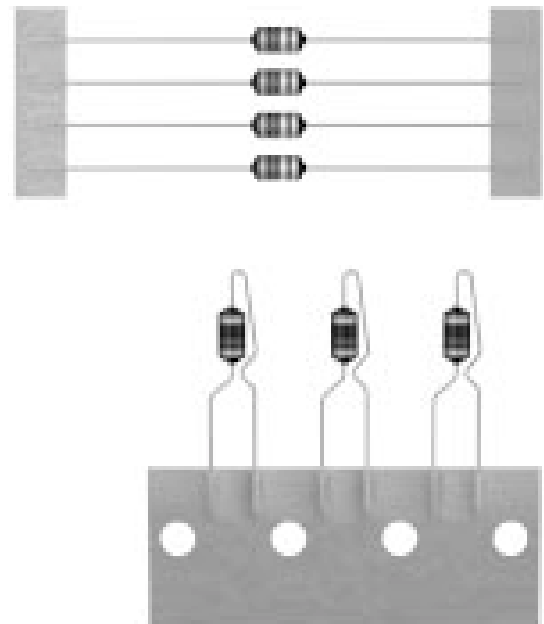

B82141-B (central radial leads, taped)

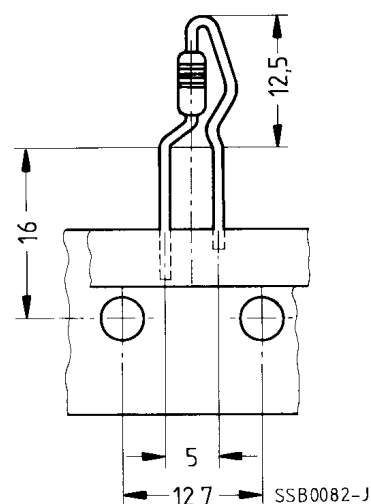

**Characteristics and ordering codes**

For further technical data [see page 91](#).

$L_R$ $\mu\text{H}$	Tolerance <sup>1)</sup>	$Q_{\min}$	$f_Q$ MHz	$I_R$ mA	$R_{\max}$ $\Omega$	$f_{\text{res, min}}$ MHz	Ordering code <sup>2)</sup>
1,0	$\pm 10\%$ $\hat{=} K$	40	7,96	725	0,19	180	B82141-+1102-K
1,2		40	7,96	700	0,20	160	B82141-+1122-K
1,5		40	7,96	670	0,22	155	B82141-+1152-K
1,8		45	7,96	660	0,23	145	B82141-+1182-K
2,2		45	7,96	630	0,25	130	B82141-+1222-K
2,7		45	7,96	610	0,27	110	B82141-+1272-K
3,3		50	7,96	580	0,30	90	B82141-+1332-K
3,9		50	7,96	560	0,32	70	B82141-+1392-K
4,7		50	7,96	530	0,36	60	B82141-+1472-K
5,6		50	7,96	510	0,38	50	B82141-+1562-K
6,8		50	7,96	480	0,43	40	B82141-+1682-K
8,2		50	7,96	450	0,52	30	B82141-+1822-K
10		55	2,52	410	0,60	25	B82141-+1103-K
12		55	2,52	385	0,67	20	B82141-+1123-K
15		55	2,52	365	0,74	17	B82141-+1153-K
18		55	2,52	350	0,81	14	B82141-+1183-K
22		55	2,52	335	0,90	12	B82141-+1223-K
27		55	2,52	315	1,00	11	B82141-+1273-K
33		55	2,52	300	1,12	10	B82141-+1333-K
39	55	2,52	285	1,21	8,5	B82141-+1393-K	

1) Closer tolerances upon request

2) Replace the + by code letter "A" for axial taping or by "B" for radial taping

**Characteristics and ordering codes**

For further technical data [see page 91](#).

$L_R$ $\mu\text{H}$	Tolerance <sup>1)</sup>	$Q_{\min}$	$f_Q$ MHz	$I_R$ mA	$R_{\max}$ $\Omega$	$f_{\text{res, min}}$ MHz	Ordering code <sup>2)</sup>
47	$\pm 5\%$ J	55	2,52	200	2,40	7,7	B82141-+1473-J
56		55	2,52	195	2,60	6,8	B82141-+1563-J
68		55	2,52	185	2,90	5,7	B82141-+1683-J
82		55	2,52	175	3,20	5,5	B82141-+1823-J
100		60	0,796	170	3,50	5,3	B82141-+1104-J
120		60	0,796	160	3,80	5,0	B82141-+1124-J
150		60	0,796	150	4,30	4,6	B82141-+1154-J
180		60	0,796	135	5,30	4,2	B82141-+1184-J
220		60	0,796	130	5,80	3,8	B82141-+1224-J
270		60	0,796	115	7,80	3,2	B82141-+1274-J
330		60	0,796	105	9,10	3,0	B82141-+1334-J
390		60	0,796	95	11,0	2,7	B82141-+1394-J
470		60	0,796	90	12,0	2,3	B82141-+1474-J
560		60	0,796	75	16,5	2,2	B82141-+1564-J
680		60	0,796	65	22,0	2,0	B82141-+1684-J
820		60	0,796	60	25,0	1,8	B82141-+1824-J
1000		60	0,796	55	33,0	1,5	B82141-+1105-J

1) Closer tolerances upon request

2) Replace the + by code letter "A" for axial taping or by "B" for radial taping

Impedance  $|Z|$   
versus frequency  $f$   
measured with impedance analyzer  
HP 4191A / HP 4194A

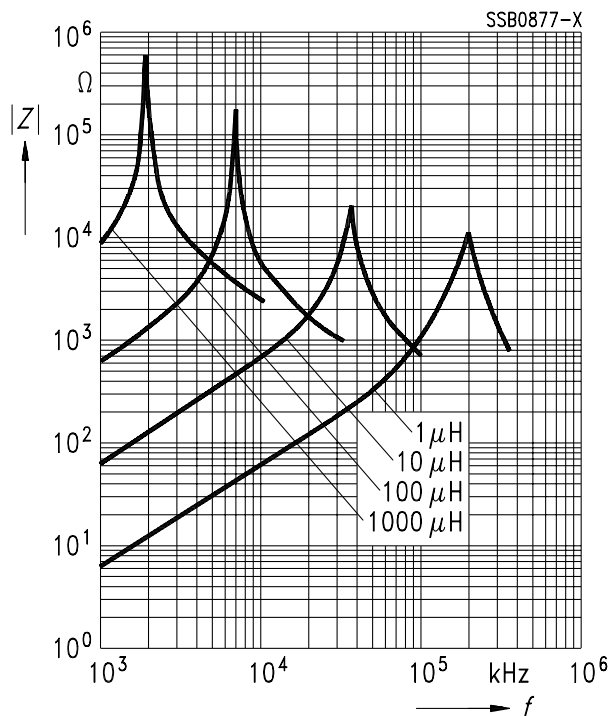

Inductance  $L$   
versus dc load  $I_{DC}$   
measured with LCR meter HP 4275A

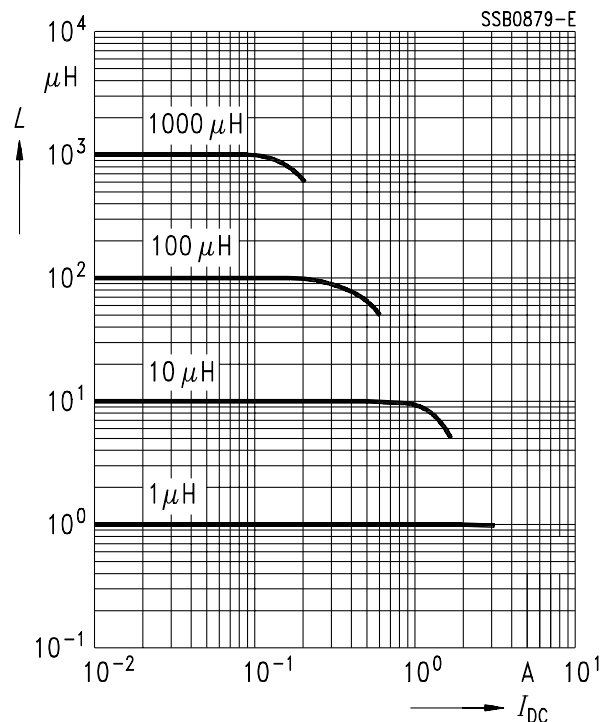

Q factor  
versus frequency  $f$   
measured with impedance analyzer HP 4194A

