



technical data

19.01.2012

elevator switch
AC/DC 2-wire
89 x 25 x 25mm

ident-no.:
75082_CO
type:
Conrad-Typ: 505369

revision index: 000

output	bistable (locking switch)
switching capacity	max. 80 W/VA
switching voltage	250 V AC/DC
switching current	max. 800 mA
switch on time	2,0 ms
switch off time	1,0 ms
switching frequency	max. 100 Hz
lifetime at nominal load	10 ⁵ to 10 ⁶ operations
operating temperature range	-25°C ... +80°C
degree of protection acc. to DIN 60 529	IP00
dielectric test voltage ac (rms.) Ui	2000 V
on/off indication	LED, south- + north pole at the side
housing material	plastics
connection	flat plug 4,8

Permissible starting torque of the housing screws (M4) max. 2 Nm

Reed switches are not suitable for direct switching of lighting, power supplies, drives, etc.
(the max current often exceeded during startup/when off).

Additional coupling with protective relays use.

Applications are inadmissible when safety of persons depends on the function of the device.

SECATEC electronic GmbH reserves the right to change or discontinue these products without notice and does not assume any liability arising by use the product with non-compliance of this specifications.

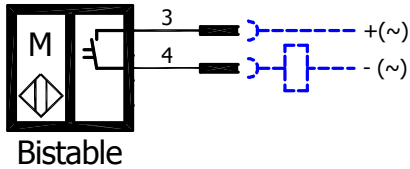
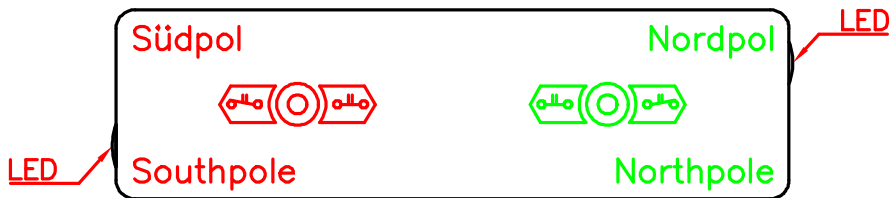
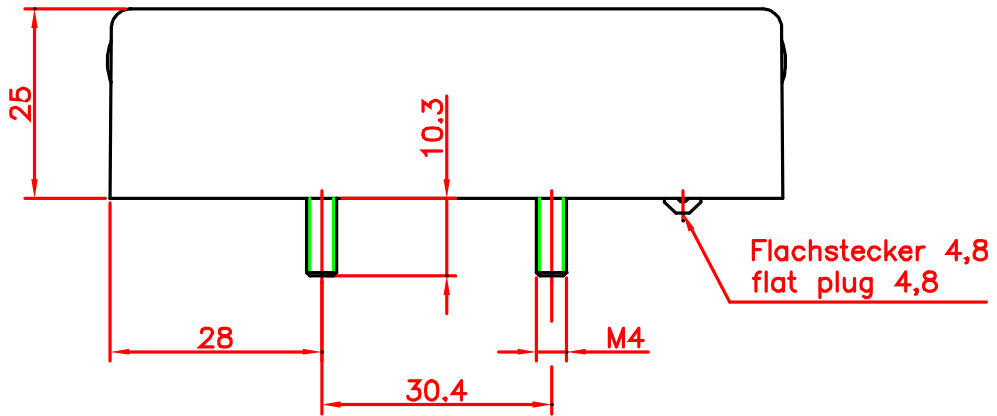
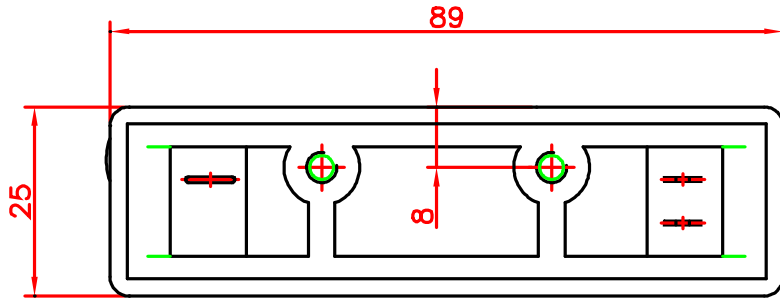

Schutzvermerk nach DIN 34 beachten	(Zul.Abw.) Allgemeintol. nach DIN ISO 2768-m	Oberfläche nach DIN 3141	Maßstab 1:1	(Gewicht)	
	2012 Bearb. Gepr.	Datum 17.01.	Name Seifer	(Benennung) Aufzugschalter 25x25x89mm Raster	
		Secatec electronic GmbH Knappenstraße 154 D-57581 Katzwinkel (0049)02741/9460-0 www.secatec.de	(Zeichnungsnummer) 75082_CO	Blatt	
Änderungsindex	Datum		Name (Urspr.)	(Ers.f.:	(Ers.d.: