

Top View of Assembly

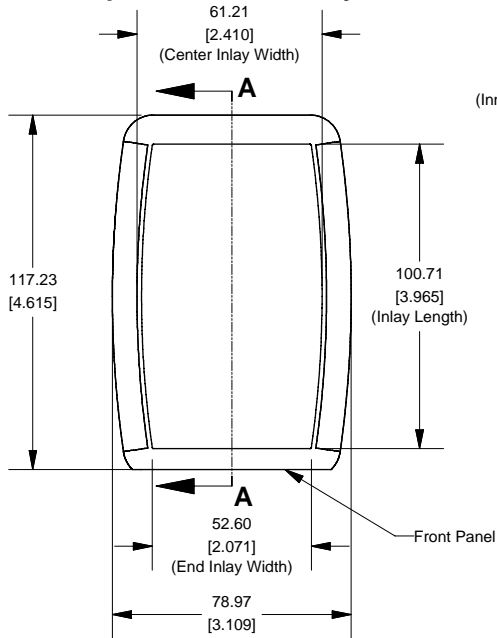

SECTION A-A (Side View Inside Assembly)

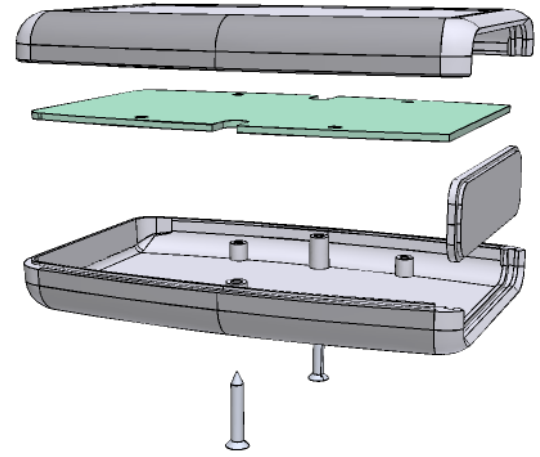
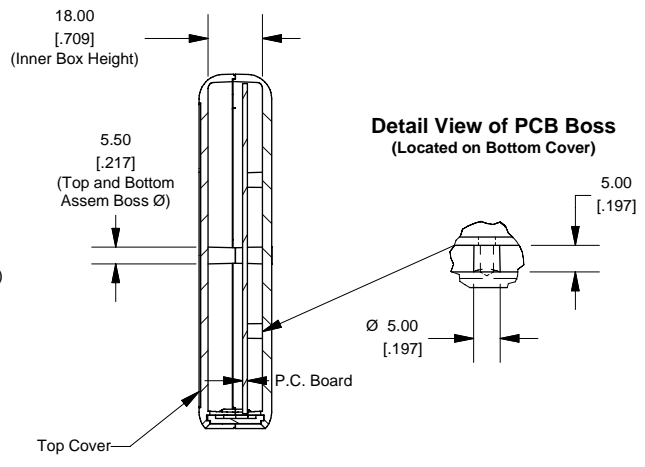

End View of Assembly

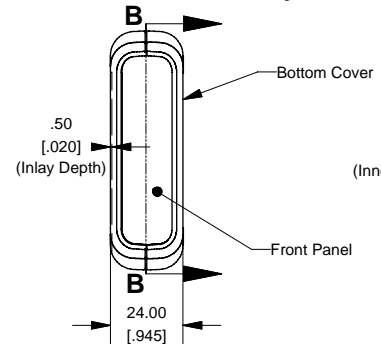

SECTION B-B (Inside of Bottom Cover)

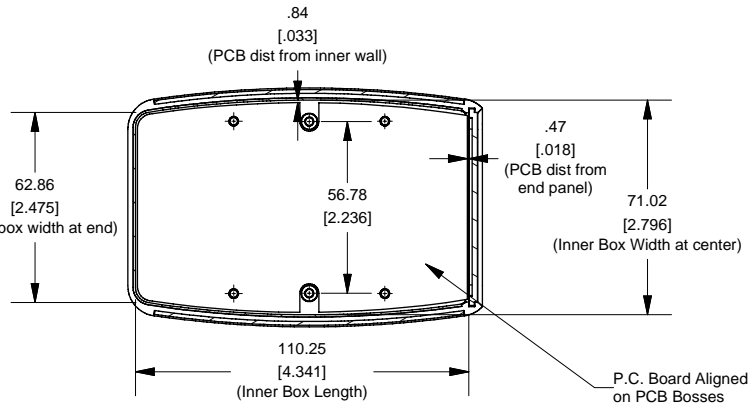

Enclosures can be Factory Modified (Milling, Drilling, Printing etc.)
 Solid models of this enclosure available in STEP or IGES.
 Contact Factory mjm@hammondmfg.com

| NOTE | |
|---|--|
| Enclosure molded from GP ABS (UL94-HB) plastic. | |
| Purchased assembly includes top and bottom cover, front plastic panel and 2 cover screws. | |

PART NUMBERS

| 1553B Enclosure | |
|--|------------|
| Black Enclosure/Grey Over-mold | 1553BBK |
| Red Enclosure/Black Over-mold | 1553BGY |
| Translucent Blue Enclosure/Black Over-mold | 1553BTBUBK |
| Yellow Enclosure/Black Over-mold | 1553BYLBK |
| Grey Enclosure/Grey Over-mold | 1553BGYBAT |

ACCESSORIES

| | |
|---|---------------------------------------|
| Cover Screws (Pkg 100) | 1593MS100 (Silver) |
| [#4 x 5/8" self-tapping oval head (15.9mm)] | 1593MS100BK (Black) |
| P.C. Board Screws | 1593ATS50 (Pkg 50) |
| [#4 x 1/4" self-tapping (6.4mm)] | 1593ATS100 (Pkg 100) |
| Belt or Pocket Clip | 1599CLIP (Black) 1599CLIPGY (Grey) |

Front/Rear Panel (Dashed Line Indicates Viewing Area)

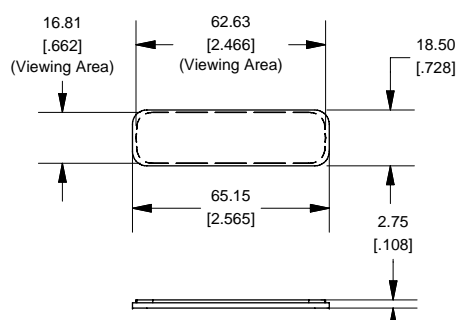

Maximum P.C. Board Size

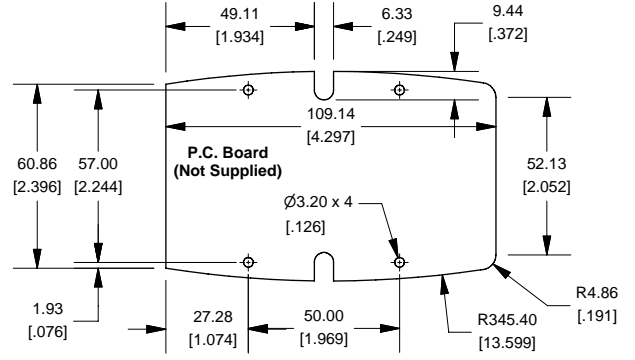

HAMMOND MANUFACTURING™
1553B
www.hammondmfg.com