



Screw Fixing Mounts

- MB with flat design
- TY with compact curved design

Features and Benefits

Simple to install with a screw or bolt they give excellent security, particularly in areas of high vibration. MB1 and MB2 offer a single hole fixing with two-way entry for the cable tie.

Application

These products are designed for simple, yet robust, installation in a wide variety of applications - particularly used in telecoms equipment, switchgear and control cabinets.

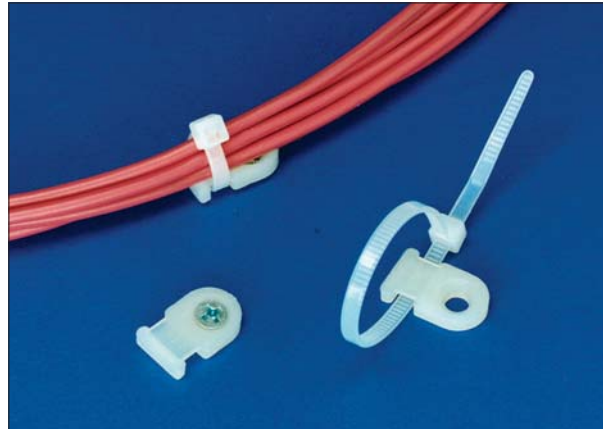

Screw fix cable tie mounts MB1.

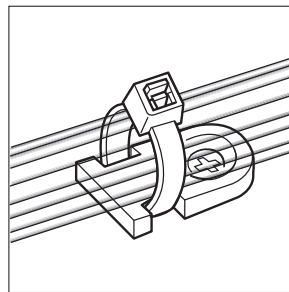

Cable Tie Mounts MB1/MB2

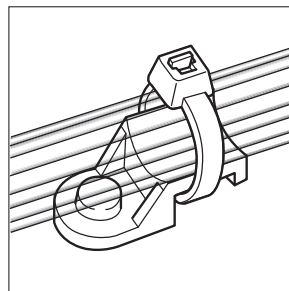
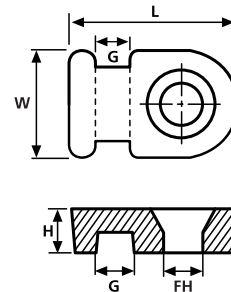

Cable Tie Mounts TY3/TY8

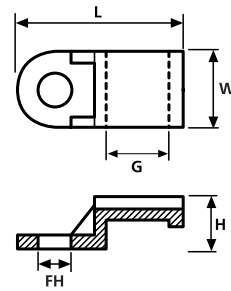

Material Data

Material	Polyamide 6.6 (PA66)
Operating Temperature	-40 °C to +85 °C Continuous, (+105 °C for 500 h)
Flammability	UL94 V2



Technical Table

Article-No.	Type	Length (L)	Width (W)	Height (H)	Fixing Hole Ø (FH)	Strap Width max. (G)	Material	Colour
151-28119	MB1	12.5	8.0	3.5	2.9	2.6	PA66	Natural (NA)
151-28110	MB1	12.5	8.0	3.5	2.9	2.6	PA66	Black (BK)
151-28219	MB2	20.5	12.5	3.3	5.0	5.0	PA66	Natural (NA)
151-28210	MB2	20.5	12.5	3.3	5.0	5.0	PA66	Black (BK)
151-23319	TY3F1	19.0	8.0	5.8	3.5	5.0	PA66	Natural (NA)
151-23819	TY8F1	22.4	10.0	5.8	4.5	8.0	PA66	Natural (NA)

All dimensions in mm. Subject to technical changes.



Please note! Not all products listed on this page may have this approval. For product specific approvals please refer to the Appendix.