

**HEADER RIGHT ANGLE SOLDER PIN,  
1 X 1 MM / 0.039 X 0.039 IN PIN  
SPACING 3.81 MM / 0.15 IN 100%  
PROTECTED AGAINST MISMATING**

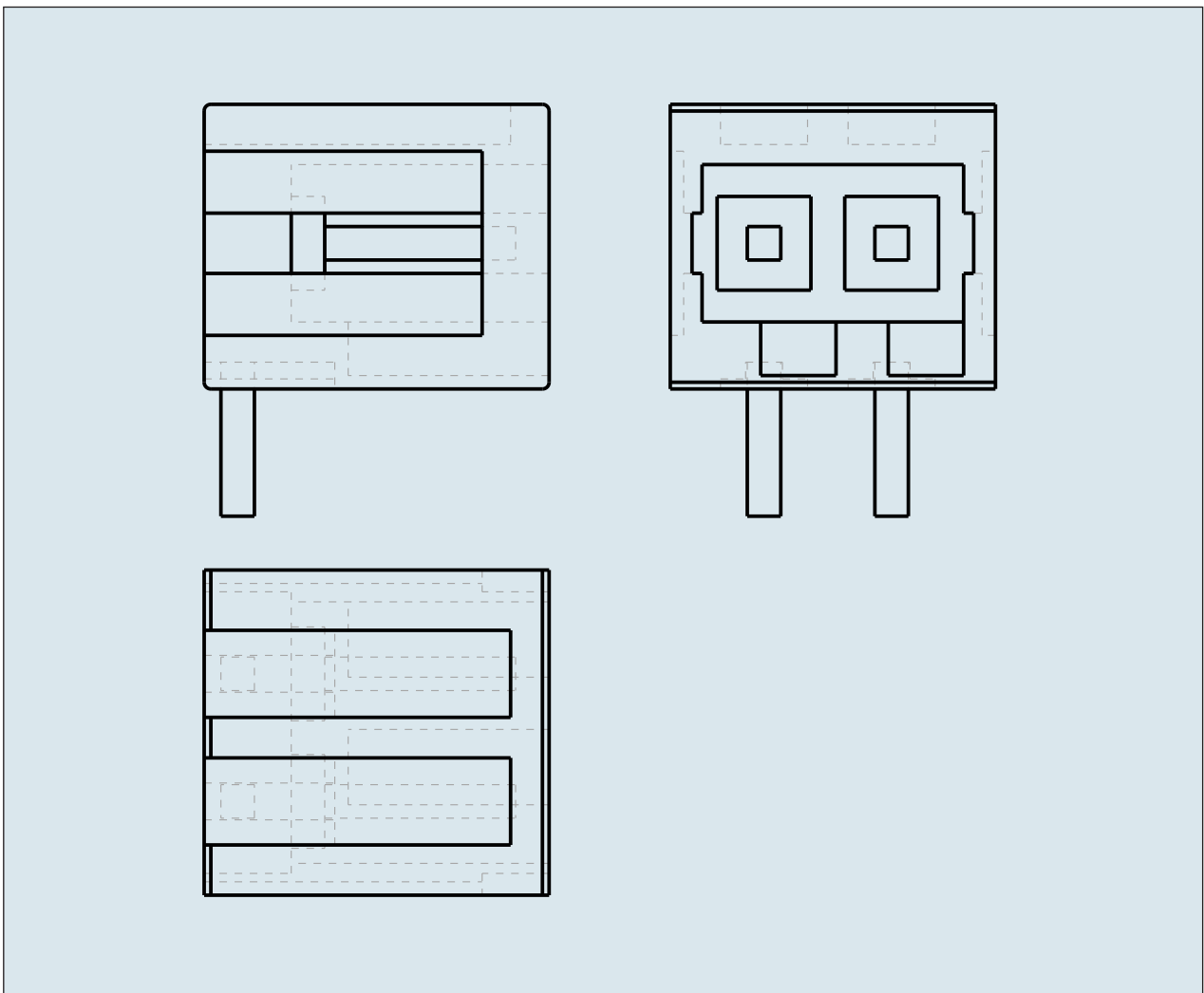
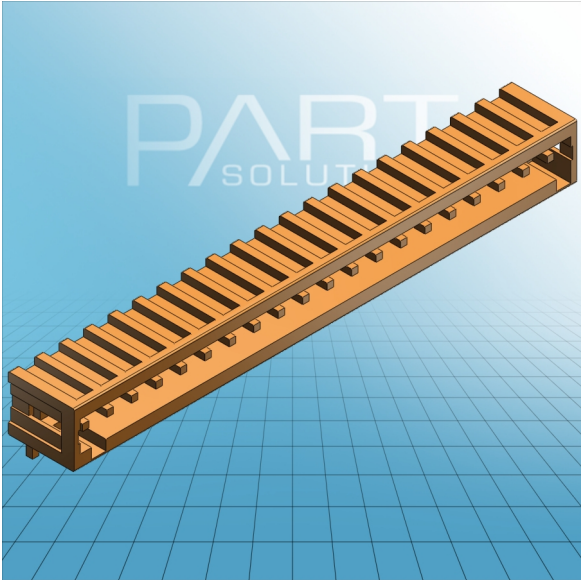

**HEADER RIGHT ANGLE SOLDER PIN,  
1 X 1 MM / 0.039 X 0.039 IN PIN  
SPACING 3.81 MM / 0.15 IN 100%  
PROTECTED AGAINST MISMATING  
734-262 TO 734-280**

<b>ITEM-NO. (ITEM-NO.)</b>	734-280
<b>Measured voltage (Measured voltage / V)</b>	160
<b>Measured shock voltage (Measured shock voltage / kV)</b>	2.5
<b>Pollution degree (Pollution degree)</b>	2
<b>Current intensity (Current intensity / A)</b>	10
<b>RM (PIN SPACING / mm)</b>	3.81
<b>P (NO. OF POLES)</b>	20
<b>Height (Height / mm)</b>	8.5
<b>Width (Width / mm)</b>	78.29
<b>Depth (Depth / mm)</b>	10.3
<b>COLOR (COLOR)</b>	orange
<b>WEIGHT (WEIGHT / g)</b>	5.58
<b>Comment (Comment)</b>	L = (No. of poles - 1) x Pin Spacing + 5,9 mm
<b>Dimensions (Dimensions)</b>	1,4 +0,1 mm