

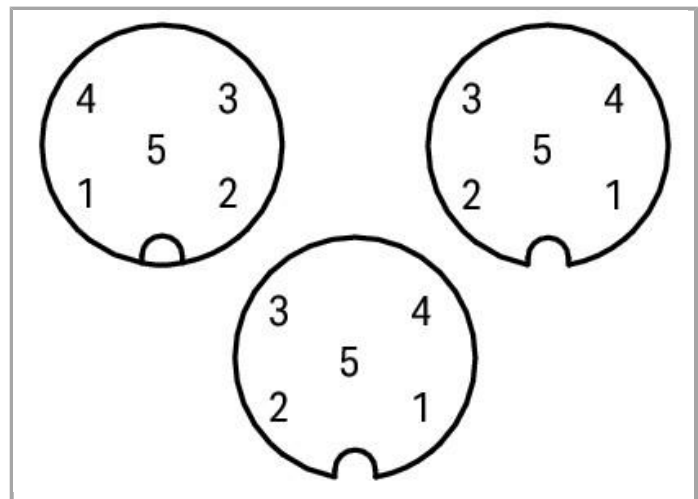

RoHS Compliant [BOMcheck.net](https://www.bomcheck.net)

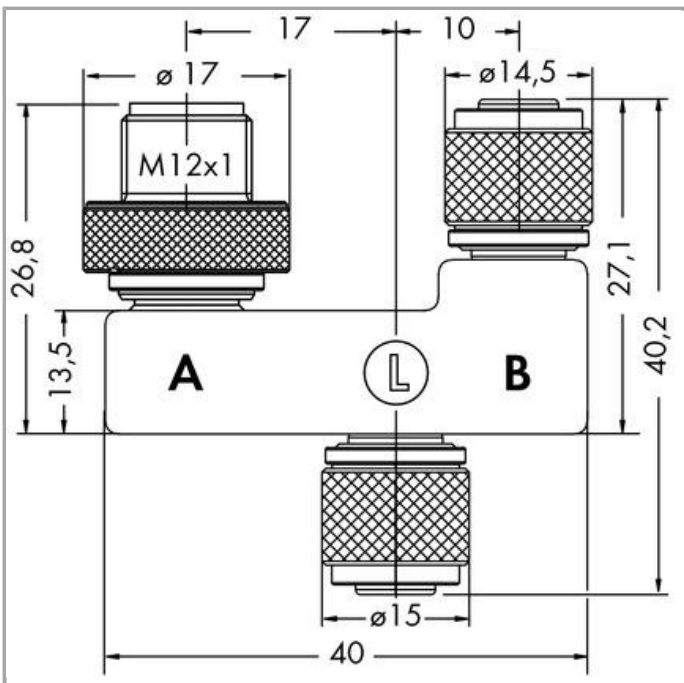
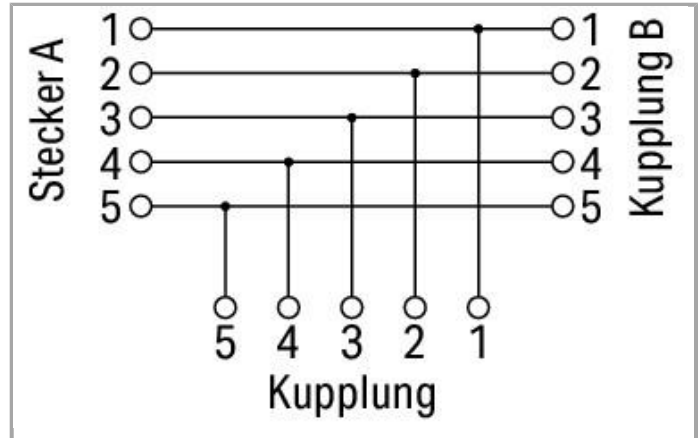

1 = Drain
2 = +24 V
3 = GND (0 V)
4 = CAN_H
5 = CAN_L

Data

Technical Data

Connection type	M12 plug; M12 socket
No. of poles	5
Steckgesichtskodierung Leitung/Adapter 1 1	A coded
Steckgesichtskodierung Leitung/Adapter 2 1	A coded
Steckgesichtskodierung Leitung/Adapter 1 2	A coded
Communication/Fieldbus	DeviceNet

Mechanical data

Weight	32.6 g
--------	--------

Environmental Requirements

Degree of protection	IP67
----------------------	------

Commercial data

Packaging type	BOX
Country of origin	CZ
GTIN	4050821705161



Customs Tariff No.

85366990990

Downloads

Documentation

System Description

767 Series, SPEEDWAY accessories, data sheet

May 16, 2018

1.0 MB

[Download](#)

Subject to changes.

WAGO Kontakttechnik GmbH & Co. KG

Hansastr. 27

32423 Minden

Phone: +49571 887-0 | Fax: +49571 887-169

Email: info.de@wago.com | Web: www.wago.com

Do you have any questions about our products?

We are always happy to take your call at +49 (571) 887-44222.