

254/TS
254/TS-SN

254/TC
254/TC-SN

G13

2A-250V

T130
Tm110

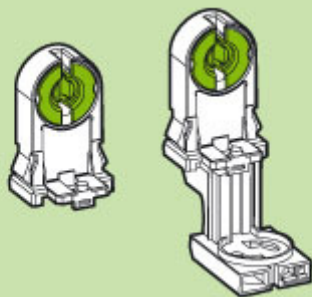

IP20 LAMPHOLDERS

- Polycarbonate body
- Copper alloy/brass contacts

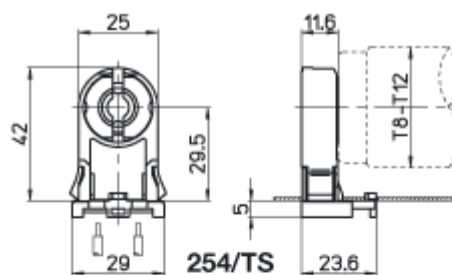

254/TS

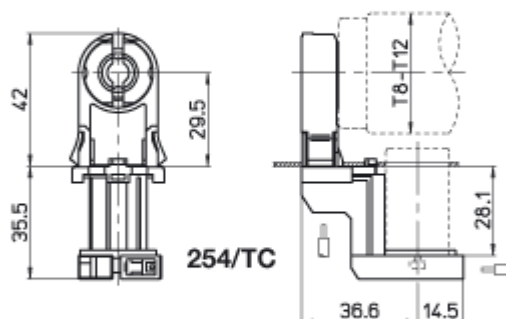

254/TC

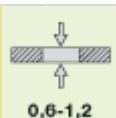
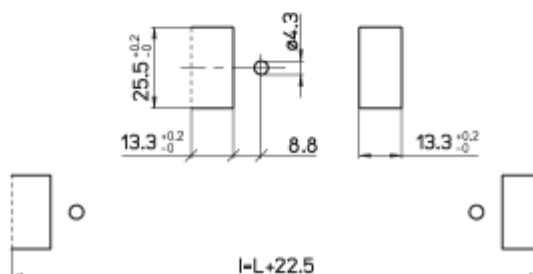

.../T

...-SN

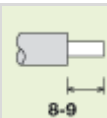
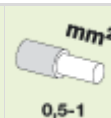

Legend

AUTOMATIC FIXING

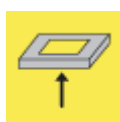

push-through fixing

CHARACTERISTICS

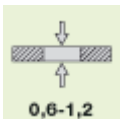

metal plate thickness

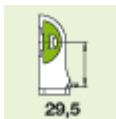

lamp centre height (from the bottom of the metal plate)



suitable only for fixing into 13,3x25,5 mm holes

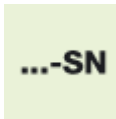

without stop nib



PBT green rotor with position of...

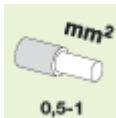

rigid conductor section

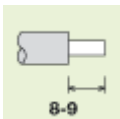

rigid wires stripping

TERMINALS



push-wire terminals with 2 holes