

**Low pressure drop**  
**Small diameter coupling**  
**High flow rates**

**Technical data**

Operating pressure:  
0 to 35 bar

Operating temperature:  
-20 to +100°C

(consult our Technical Service for use below +2°C)

Air flow:  
Cv = 0,21

**Materials:**

Coupler back, body & sleeve: nickel plated brass

Valve: brass

Spring & balls: stainless steel

Seals: Buna N (Nitril)

Plug: nickel plated brass

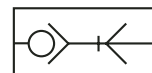

### Sockets



### Plugs



### Flow characteristics

Air,  
inlet pressure 6 bar

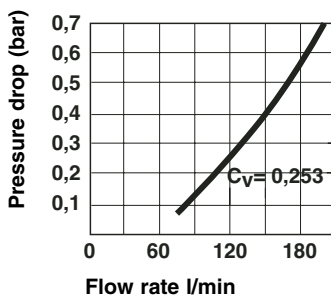

Water

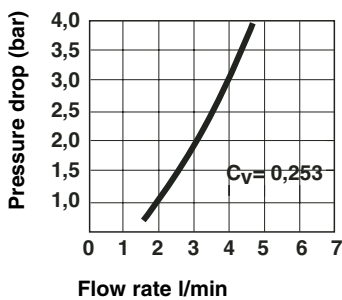

### Warning

These products are intended for use in industrial compressed air systems only. Do not use these products where pressures and temperatures can exceed those listed under 'Technical Data'.

Before using these products with fluids other than those specified, for non-industrial applications, life-support systems, or other applications not within published specifications, consult NORGREN.

Through misuse, age, or malfunction, components used in fluid power systems can fail in various modes.

The system designer is warned to consider the failure modes of all component parts used in fluid power systems and to provide adequate safeguards to prevent personal injury or damage to equipment in the event of such failure.

**System designers must provide a warning to end users in the system instructional manual if protection against a failure mode cannot be adequately provided.**

System designers and end users are cautioned to review specific warnings found in instruction sheets packed and shipped with these products.

**Socket – male thread**

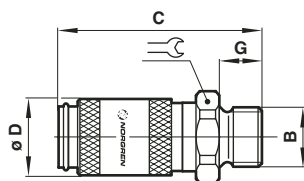

B	C	Ø D	G	⌀	Type
M5	26	10	5	9	2322A0005
G1/8	28	10	7	11	232210018

**Socket – female thread**

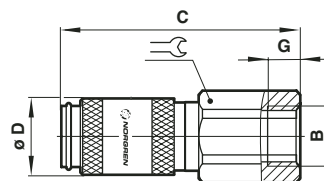

B	C	Ø D	G	⌀	Type
M5	26	10	5	9	2322D0005
G1/8	28	10	7	12	232220018

**Socket – hose barb**

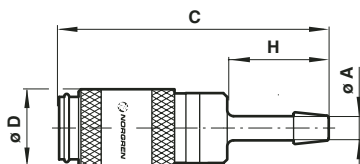

Ø A	C	Ø D	H	Type
3	35	10	13	232230300
4	35	10	13	232230400

**Plug – male thread**

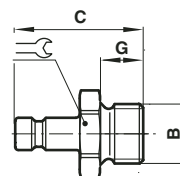

B	C	G	⌀	Type
M5	18	5	7	2321A0005
G1/8	20	7	11	232110018

**Plug – female thread**

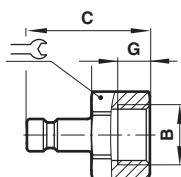

B	C	G	⌀	Type
M5	17	5	7	2321D0005
G1/8	19	7	12	232120018

**Plug – hose barb**

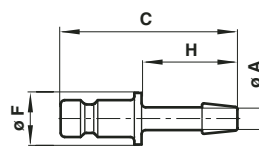

Ø A	C	Ø F	H	Type
3	24	7	13	232130300
4	24	7	13	232130400