

## R Mini Series

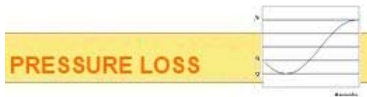
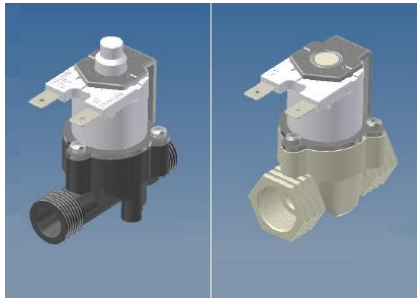
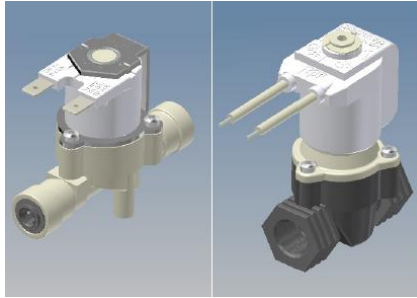

### PHYSICAL CHARACTERISTICS

Valve body:	Nylon 66 30% fibra vetro
Diaphragm:	NBR (buna); EPDM; Silicone (MVQ)
Core::	Stainless steel
Coil:	Classe F (155°)
Assembly:	Self-tapping screws

### WORKING CHARACTERISTICS

Working pressure:	0.2 - 10 bar
Room temperature:	Tu 60 °C
Fluid temperature:	Tm 25°C - Tm 60°C - Tm 90°C

Orifice:	DN 8mm; DN 9mm; DN 10mm; DN 11mm;
----------	--

Electropilot/control:	Normally Closed (NC); Normally Open (NO); Latching
-----------------------	--

### INSTALLATION

In all positions
------------------

### APPLICATIONS

All automatic water control applications
--

### WATER CONNECTIONS

Male thread:	1/4"; 3/8"; 1/2"; 3/4"
--------------	---------------------------------

Female thread:	1/8"; 1/4"; 3/8"; 1/2"; 3/4"
----------------	--

Hose tail:	10mm
------------	------

Quick coupling John Guest:	1/4"; 3/8"; 6mm; 8mm; 10mm; 15mm; Inlet 8mm - Outlet 1/4"; Inlet 10mm - Outlet 8mm
----------------------------	---