

D-SUB combination contact insert - VS-25-BU-DSUB-4P-5S - 1655373

Please be informed that the data shown in this PDF Document is generated from our Online Catalog. Please find the complete data in the user's documentation. Our General Terms of Use for Downloads are valid (<http://download.phoenixcontact.com>)



D-SUB contact insert, shell size 3, with five signal contacts, with solder cup, straight, accommodation for four combined contacts, contact type socket, fixing with a 3 mm hole, for panel mounting frame and sleeve housing VS-25-...

Key commercial data

| | |
|------------------|---------------|
| package_quantity | 10 |
| GTIN | 4046356029308 |

Technical data

Mechanical characteristics

| | |
|-------------------------------------|---------------------|
| Number of positions | 9 |
| Connection profile | 25-pos. D-SUB |
| Insertion/withdrawal cycles | ≥ 200 |
| Connection method | Solder cup |
| Conductor cross section | 0.5 mm ² |
| Connection cross section AWG | 20 |
| Insertion force per signal contact | ≤ 3.40 N |
| Extraction force per signal contact | ≥ 0.2 N |

Ambient conditions

| | |
|---------------------------------|-------------------|
| Ambient temperature (operation) | -55 °C ... 125 °C |
|---------------------------------|-------------------|

Material data

| | |
|---|-------------------------|
| Inflammability class according to UL 94 | V0 |
| Housing material | Steel, yellow chromated |
| Contact carrier material | PBTP |
| Contact material | Copper alloy |
| Contact surface material | Gold over nickel |

Electrical characteristics

| | |
|-------------------------------------|----------|
| Rated voltage (III/3) | 250 V |
| Rated surge voltage | 1 kV |
| Rated current | 5 A |
| Contact resistance per contact pair | ≤ 2.7 mΩ |
| Insulation resistance | ≥ 5 GΩ |

D-SUB combination contact insert - VS-25-BU-DSUB-4P-5S - 1655373

Technical data

classifications

eCl@ss

| | |
|------------|----------|
| eCl@ss 4.0 | 27140816 |
| eCl@ss 4.1 | 27260701 |
| eCl@ss 5.0 | 27260701 |
| eCl@ss 5.1 | 27260701 |
| eCl@ss 6.0 | 27260705 |
| eCl@ss 7.0 | 27440309 |
| eCl@ss 8.0 | 27440309 |

ETIM

| | |
|----------|----------|
| ETIM 2.0 | EC000438 |
| ETIM 3.0 | EC000438 |
| ETIM 4.0 | EC000438 |
| ETIM 5.0 | EC000438 |

UNSPSC

| | |
|---------------|----------|
| UNSPSC 6.01 | 30211923 |
| UNSPSC 7.0901 | 39121522 |
| UNSPSC 11 | 39121522 |
| UNSPSC 12.01 | 39121522 |
| UNSPSC 13.2 | 39121522 |

approvals

GOST /

Approval details



accessories

Screw contact

D-SUB combination contact insert - VS-25-BU-DSUB-4P-5S - 1655373

accessories

VS-BU-SC-2,6 - 1655470



Solder contact

VS-BU-KX-50-RG178 - 1655496



VS-BU-KX-50-RG174 - 1655535



VS-BU-KX-50-RG58 - 1655577



VS-BU-KX-75-RG179/187 - 1655616



D-SUB combination contact insert - VS-25-BU-DSUB-4P-5S - 1655373

accessories

VS-BU-LK-3,6/22,8/2,6 - 1688256



VS-BU-LK-3,6/22,8/4,6 - 1688272



Drawings

Dimensioned drawing

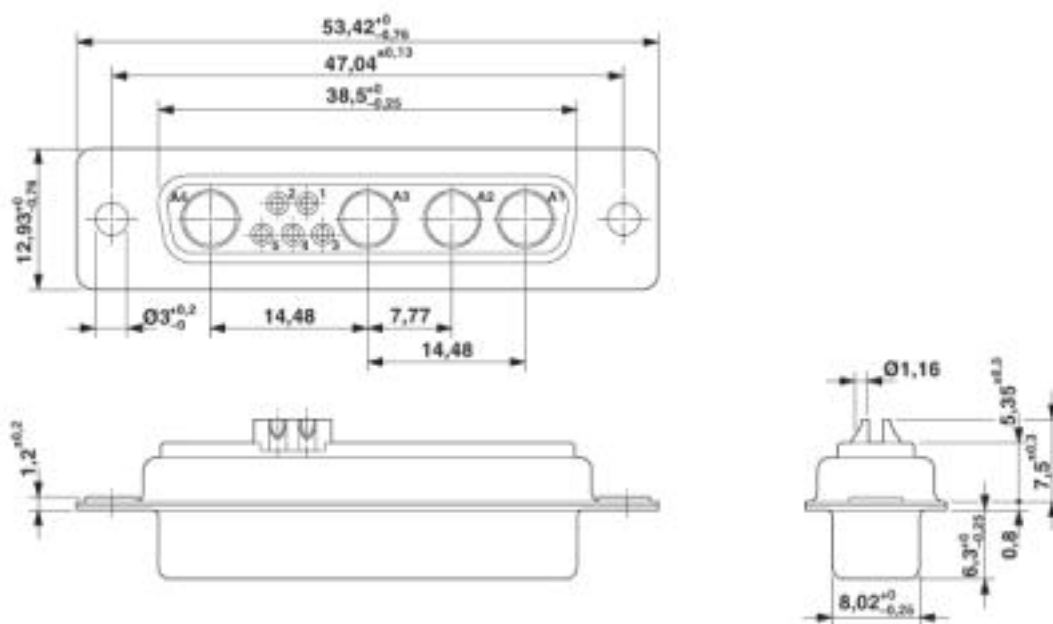

D-SUB contact insert

Schematic diagram

