

Datasheet

Item no. 647930/ 647934/ 647941/ 647902/ 647938/
649957/ 649955

V1_0717_01_en

Piezoelectric switch

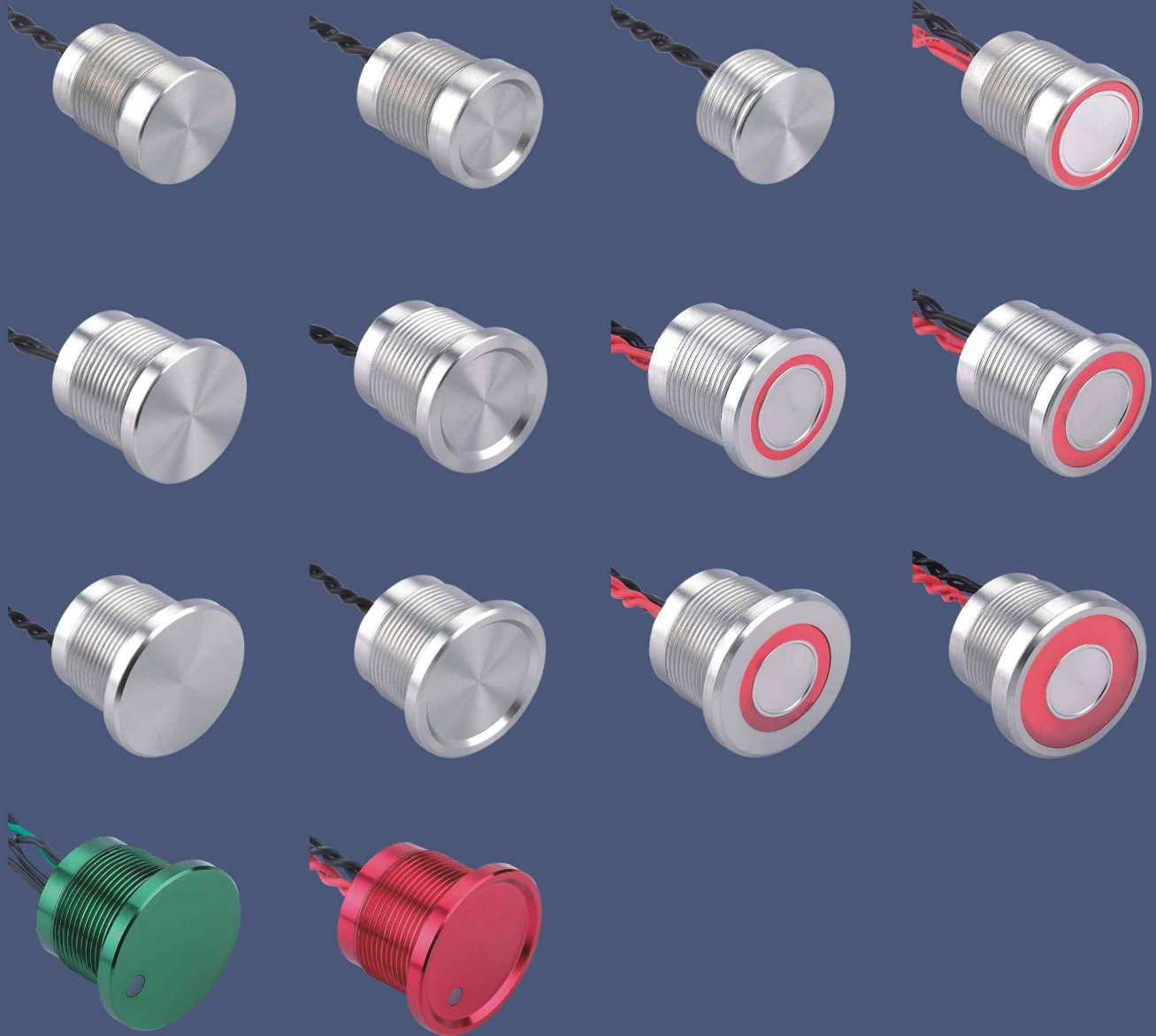

Environmental specifications

- Sealing : IP68
- Vibration resistance : 10–500 Hz / 10 g
- Operating temperature : –40°C to +75°C

Materials

- Case : aluminium, anodized
- Multi-wire leads section 0,22 mm² length 300 mm, twisted by pair
- Cable, length 300 mm, section depending on switch model
- PC terminals : bronze, tin plated

Electrical and general specifications

- Max. current/voltage rating : 1A 24VAC/DC or 200mA 24VAC/DC depending on version
- Switch resistance ON : 10 max.
- Switch resistance OFF : 5M min.
- Operating force : 2 to 6N
- Life expectancy : 50 million cycles
- LED consumption : Illuminated dot : 10mA – Illuminated ring : 20mA

Datasheet

Item no. 647930/ 647934/ 647941/ 647902/ 647938/
649957/ 649955

V1_0717_01_en

Piezoelectric switch Overview

Finger pressure applied to switch

1 = pressure
0 = no pressure

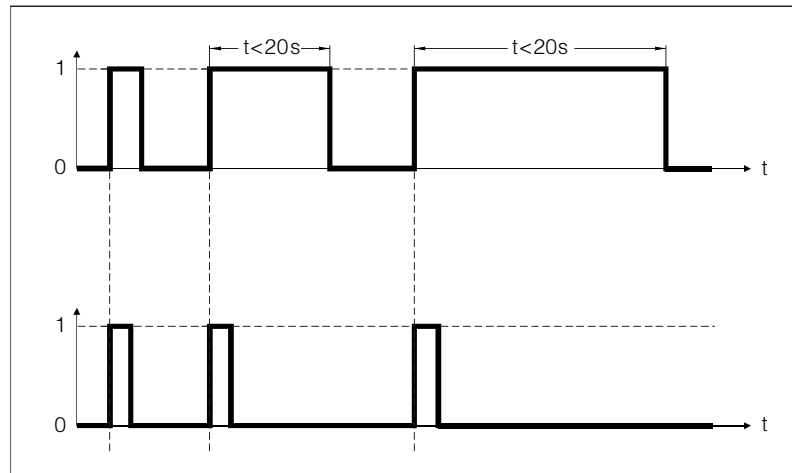

Output

– Momentary NO (pulse)
No external power supply required

Wiring diagrams

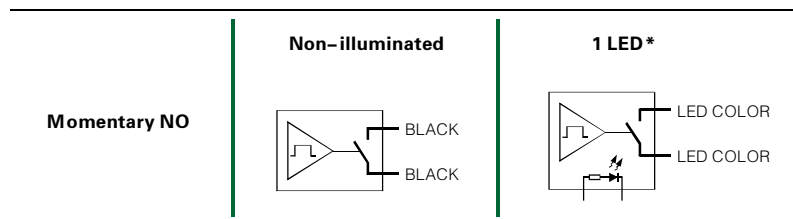

Datasheet

Item no. 647930/ 647934/ 647941/ 647902/ 647938/
649957/ 649955

V1_0717_01_en

Piezoelectric switch $\Phi 19$ Options

Non-illuminated – operator height 3mm, flat



647930 : Piezo switch, flux 19mm, 3.0mm flat operator, Aluminium, 200mA, 24 V AC/DC

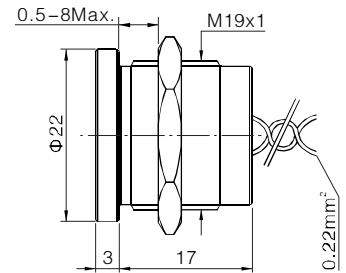

Non-illuminated – operator height 3mm, with finger location



647934 : Piezo switch, flux 19mm, 3.0mm fringer location operator, Aluminium, 200mA, 24 V AC/DC

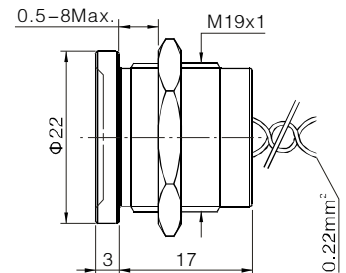

With thin illuminated ring, operator height 3mm, flat



647941 : Piezo switch, flux 19mm, 3.0mm flat operator, Aluminium, 200mA, 24 V AC/DC, thin ring w/ Blue LED

647902 : Piezo switch, flux 19mm, 3.0mm flat operator, Aluminium, 200mA, 24 V AC/DC, thin ring w/ Green LED

647938 : Piezo switch, flux 19mm, 3.0mm flat operator, Aluminium, 200mA, 24 V AC/DC, thin ring w/ Red LED

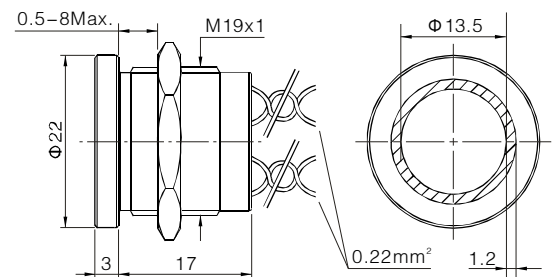

With large illuminated ring, operator height 3 mm, with chamfer



649957 : Piezo switch, flux 19mm, 3.0mm flat operator, Aluminium, 200mA, 24 V AC/DC, large ring w/ Blue LED

649955 : Piezo switch, flux 19mm, 3.0mm flat operator, Aluminium, 200mA, 24 V AC/DC, large ring w/ Red LED

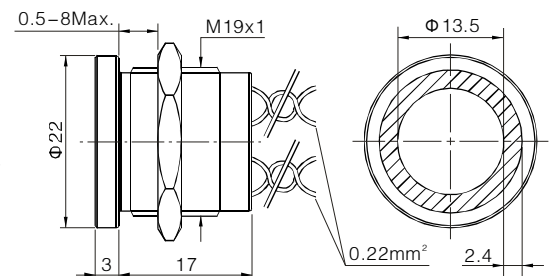

Datasheet

Item no. 647930/ 647934/ 647941/ 647902/ 647938/
649957/ 649955

V1_0717_01_en

Piezoelectric switch Specifications



Shower
(IP68 sealing)



Home automation
(design, customization)



Bath
(IP68 sealing, customization)



Car wash
(IP68 sealing, long life)



Matine
(IP68 sealing, design)



Medical
(easy to clean surface, no retention area)



Food processing
(IP68 sealing)



Mining
(IP68 sealing)

This is a publication by Conrad Electronic SE, Klaus-Conrad-Str. 1, D-92240 Hirschau (www.conrad.com).

All rights including translation reserved. Reproduction by any method, e.g. photocopy, microfilming, or the capture in electronic data processing systems require the prior written approval by the editor. Reprinting, also in part, is prohibited. This publication represents the technical status at the time of printing.

© Copyright 2017 by Conrad Electronic SE.