

Data Sheet

Type Number 394
 Designation IEC SR 45
 System Silver oxide / Zinc /
 NaOH - Electrolyte

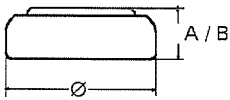

Nominal Voltage 1,55 V
 Typical Capacity C 67 mAh
 Load 13 kOhm, at 20°C down to 1.3 V

Weight (approx.) 1,04 g
 Volume 0,24 ccm
 Coding..... Manufacturing Month/Year by
 Letter Code

Temperature Ranges min max.
 Storage -10°C 65 °C
 Discharge -10°C 65°C

Dimensions min max.
 Diameter 9,5 9,3
 Height (A/B) 3,3 3,6

Segment Watch

Main Applications Watch
 Photo
 Electronic

Typical Capacities (at 20°C)

Discharge Type	Load	End Voltage:	1.3 V
Continuous	13000 Ω	Time:	560 h
24h/d,7d/w		Capacity [mAh]:	67
Current [μA]:	120	Energy [MWh]:	104