

## Data Sheet

Type Number ..... 397  
 Designation IEC ..... SR 59  
 System ..... Silver oxide / Zinc /  
 NaOH - Electrolyte

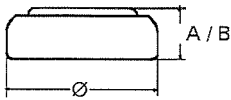

Nominal Voltage ..... 1,55 V  
 Typical Capacity C ..... 30 mAh  
 Load 20 kOhm, at 20°C down to 1.3 V

Weight (approx.) ..... 0,5 g  
 Volume ..... 0,11 ccm  
 Coding..... Manufacturing Month/Year by  
 Letter Code

### Temperature Ranges

Storage .....	min	max.
Discharge .....	-10°C	65 °C
	-10°C	65°C

### Dimensions

Diameter ... ..	min	max.
Height (A/B) .....	7,55	7,9
	2,3	2,6

Segment .....

Watch

Main Applications .....

Watch

Photo

Typical Capacities (at 20°C)

Electronic

Discharge Type	Load	End Voltage:	1.3 V
Continuous	20000 Ω	Time:	385 h
24h/d, 7d/w		Capacity [mAh]:	30
Current [µA]:	78	Energy [MWh]:	46