

## User Instructions Tour Guide (Transmit) Radio ATT 100

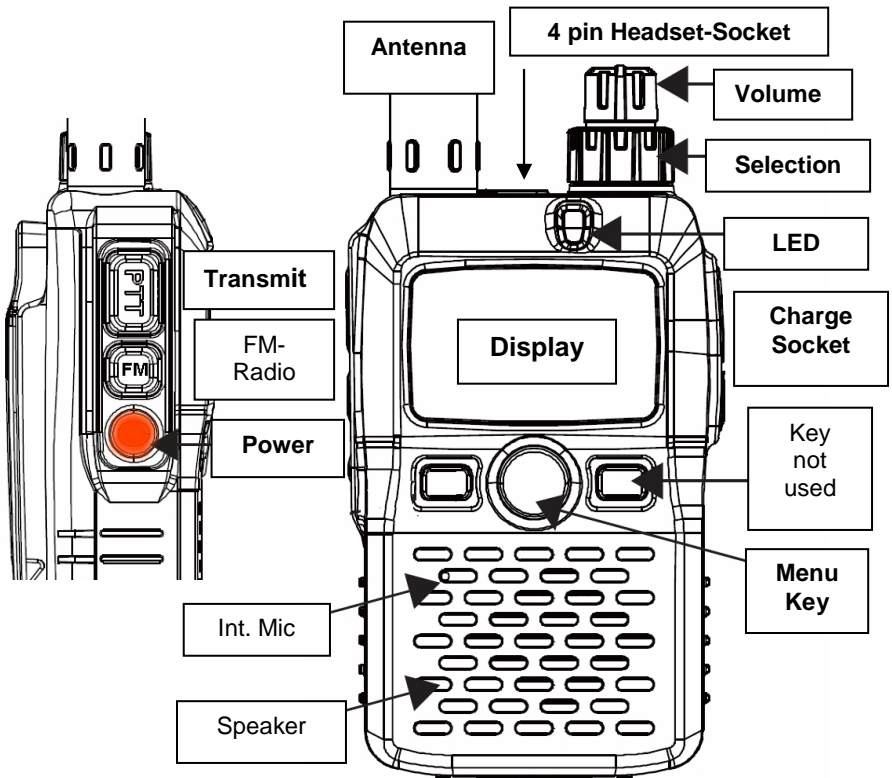

- **Volume:** Listen to channel radio traffic (smaller rotary button)
- **Channel Selection:** larger rotary button
- **Channels 001- 010:** normal talking to tourists in the group (with normal power & communication range, energy saving)
- **Channels 011- 020:** same as 001-010, but with increased (10 x) power & range (**Note:** increased battery current consumption)
- **Receiver side:** Display **1 - 9** at tourist radio corresponds to **CH-001** bis **CH-009** und **CH-011** to **CH-019** at tour guide radio. Display **0** at tourist radio corresponds to **CH-010 / CH-020** at tour guide radio.
- **Check for free Channel:** Tour guides should check and listen in their environment for busy or free channels. Check is recommended before each use of the system. If necessary, search for a free channel and tell the number to all your group members.

- **Busy LED:** **Green** LED shows that channel is free and can be used, **red** LED shows that the channel is already in use by another group.
- **Key Lock:** press medium key (**Menu** key) longer

## Information for Tour Guests with hearing problems

It is possible to use **2 different base volume settings** (normal and high) at ATR 100.

The factory default setting is to normal volume. Persons with hearing problems can use the high volume setting. To change base setting to high, keep **UP** button pressed **while switching the radio on**. To return to normal volume, keep **DOWN** button pressed **during Power on**. The systems keeps each setting stored until next change.

## Announcements to Tourist Group Members

### Announcements via internal Microphone

Press Transmit button (PTT), talk into microphone (up to 20..30 cm distance is ok) und release button after announcement. Other system's typical disturbing squelch switching noise after releasing the PTT button is eliminated by a special circuit. **So it is not necessary to keep the transmit button longer pressed than necessary.** This saves battery energy and keeps the channel free when not used! During transmit mode the LED will be red. In outdoor operation, you should consider to use the GHS 02 headset, if wind and environment noise should be too loud for the internal microphone.

### Announcement with Headset Microphone

With Tour Guide headset GHS 02 inserted you can either talk to your tourist group or you can transmit a pre-recorded announcement from any MP 3 player to the tourists. Plug the **4 pole** plug into the yellow marked **Mic** socket besides the antenna. Press **PTT** button at headset control unit to transmit. **Only where necessary and justified**, you can also transmit longer time continuously by shifting the transmit button into the LOCK position (see photo). **Do not forget to release PTT button or to switch slide switch back to PTT position after finishing the announcement.**

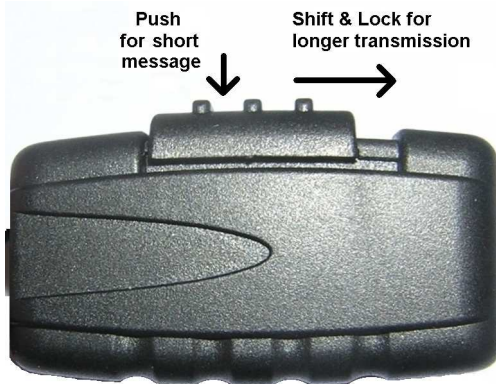

### Transmission of pre-recorded Tourist Information to the Group Members

Use the **3 pole** plug for the MP 3 player. You can listen the recorded information via your headset. To transmit this information, just press **PTT** button (or use lock slide switch). Simply adjust the MP 3 volume at your player to obtain a convenient volume at your own headset. (We recommend to test for best volume before use). You can also speak at the same time via your microphone to the tourist group! The sound is automatically mixed.

### Battery Charging

At every power-on procedure the tour guide can read the actual battery voltage in the display for a short moment. (for example **3.8V** means half charged, **~ 4 V** is fully charged and **~3.4 V** means nearly discharged)

The charge socket **DC IN** is below the rubber cap on the right side. Here you can connect the supplied USB charging cable. It is possible to re-charge the 1400 mAh Lithium Ion battery from **any** USB wall adaptor or from **any** computer via USB socket. A totally discharged battery will need about 5-6 hours charging time. Charging terminates automatically. During charging, you will see **CHGING** in the display.

We recommend to switch the radio off during charge, then you will see the LED red, until the battery will be fully charged.

The wall adapters of ATR 100 and ATT 100 are the same type and can be used for each other radio. Please respect the Safety Rules for the correct treatment of Lithium Ion batteries. Air transport rules may regard such batteries as „exempted“ dangerous goods (IATA DGR 52) Please see and read the summary of air transportation rules in the carrying bag window.

**Most airlines may request to transport the replaceable and the spare battery of the ATT 100 in your personal cabin luggage and not in the checked in luggage!** Never open a Lithium battery, never use not qualified chargers and never make any short circuit of the bottom contacts. Best is to carry batteries in plastic bags or strong paper boxes.

### **Change Battery**

You can unlock the battery door cover with a finger nail or with the tip of a ball point pen as shown here:

Please take care that you use the correct positioning of the battery. If you place the battery so, that you can read the label, it will be automatically correct inserted.

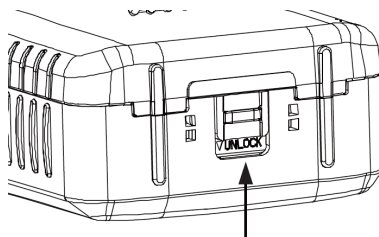

### **Additional Radio Functions (not necessary for Tour Guide use)**

#### **Use as Walkie Talkie between the Tour Guides**

The ATT 100 represents additionally a standard 2-way radio in the UHF PMR 446 frequency range for internal communications. Please take care that all radios used for the communication are switched to the same channel number.

#### **Additional Broadcast Radio Reception**

You can receive FM broadcast stations with the ATT 100 as well (via internal speaker only).

Activation: Press 2 seconds on the **FM** button on the left side.

The radio receives now FM broadcast and shows a typical radio frequency e.g. 88.0 MHz.

With the outer rotary knob (channel selector) you can now select the radio stations.

The 2 way radio signals have still priority: As soon as a signal is received, or as soon as you press your PTT button, the radio will return to your last used communication channel.

#### **Additional Functions via Menu Button (middle key)**

After pressing Menu, following Menu functions can be reached via rotary channel selector:

#### **TX Code and TX Code**

Shows the actually used CTCSS / DCS Codes – Modifications only via PC programming kit possible.

#### **SQL**

Shows the setting of the squelch level. Can be selected between **0** (open, you hear everything on the channel, including background noise) und **4** (fully closed squelch) For use as Tour Guide we recommend to select **values not below 2**.

#### **BCLO**

Busy Channel Lock Out – Transmit blocking at busy channel. Normally = off. In future regulatory administrations intend to request channel survey before talking (“Listen before talk, LBT)

If BCLO is on, you cannot transmit as long as someone else is using the selected channel. Default setting: BCLO OFF.

#### **LIGHT**

Background illumination on/off (automatically) or always on. Recommended setting: OFF.

## **SAVE**

Battery saver circuit. Should be ON.

## **K TONE**

Key tone on/off. Recommended: OFF

## **APO (Auto Power Off)**

Automatic Power off, when radio is not used for some time. Recommended: OFF

## **TOT (Recommended : OFF)**

Time-Out-Timer: maximum allowed transmit time. Disables transmitter after selected transmit time. To continue transmitting, it is necessary to release 1 x the PTT button for a moment, before you can start a new transmission period.

## **VOX (Recommended: OFF)**

Automatic Voice control (handsfree). Selections: OFF-1,2,3,4. In position 4 the voice detection has the highest sensitivity. We do not recommend to use VOX operation, because it is necessary to perform a personal training process to learn a speech behaviour which avoids lost syllables or words at the beginning of talking.

## **FM RET (Recommended: OFF)**

Automatic restart of Broadcast radio after radio communications have been finished. Not recommended to use by tour guides, because increased power consumption (no power save in silent periods)!

## **PC Programming (only for Service)**

A programming kit can be connected to the radio and allows activation / deactivation of certain functions as well as other channel frequencies within the range 400...470 MHz (national regulations may request license application). Connection of PC programmer via MIC socket and Modem cable (optional accessory item)

## **Conformity to European Standards and Directives**



Alan Electronics declares the conformity with European Directives and harmonized technical standards EN 300 296 V 1.3.1, EN 301 489-1 V 1.8.1, EN 301 489-3 V.1.3.1 und EN 60 950-1: 2006 Ed 2 for PMR 446 radio communication. The radios carry the CE mark and may be used in all EU member states and other states where the R&TTE regulations are applied (incl. IS, N, CH, FL) and TR .

Radios which are defective or not used any more must be recycled properly according to European rules, not any more via household trash, but only via public recycling stations.

All original documents are provided for download any time from <http://service.alan-electronics.de>