

|        |      |         |          |       |
|--------|------|---------|----------|-------|
| Symbol | Date | Correct | Approved | Drawn |
|        |      |         |          |       |

| Specification         |                                                                                                                     |  |  |
|-----------------------|---------------------------------------------------------------------------------------------------------------------|--|--|
| Rating                | 6A.125V.AC                                                                                                          |  |  |
| Circuit               | SPDT ON-ON                                                                                                          |  |  |
| Contact Resistance    | 20mΩ or less, initial characteristics.                                                                              |  |  |
| Insulation Resistance | 500V DC. Megger. 100MΩ or more.                                                                                     |  |  |
| Voltage Breakdown     | (1000V AC) (Between terminals),<br>(1500V AC) (Between Live metal parts and dead metal parts) 50/60Hz for 1 minute. |  |  |
| Durability            | Rated load with Resistance, 5,000 cycles,<br>Non-load, 30,000 cycles.                                               |  |  |

UNIT: mm

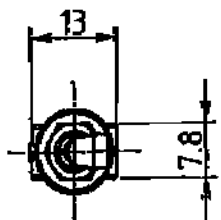

DATA SHEET For B/N 700932  
(MS-500-A-MF BLACK)

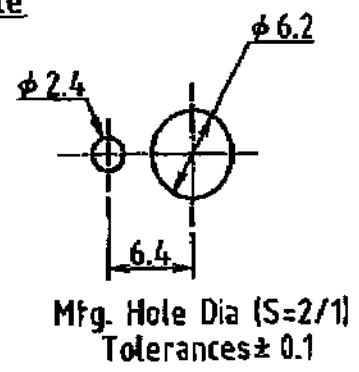
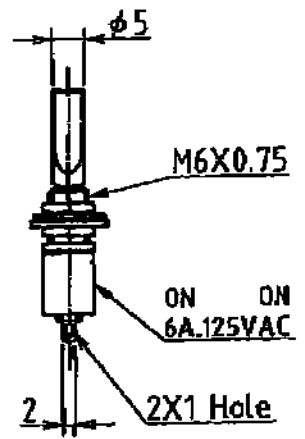
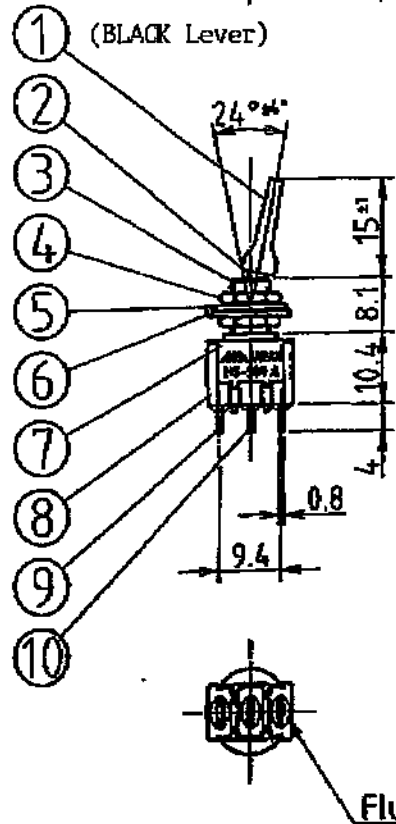

| Construction |                 |                         |                                   |
|--------------|-----------------|-------------------------|-----------------------------------|
| 13           |                 |                         |                                   |
| 12           |                 |                         |                                   |
| 11           |                 |                         |                                   |
| 10           | Common Terminal | Copper                  | 1 Silver Plated                   |
| 9            | Terminal        | Silver-clad copper      | 2 Silver Plated                   |
| 8            | Body            | Melamine Phenolic Resin | 1 Blue                            |
| 7            | Frame           | Stainless Steel         | 1 Cleaning                        |
| 6            | Locking Ring    | Steel                   | 1 Unichromate                     |
| 5            | Lock Washer     | Steel                   | 1 Unichromate                     |
| 4            | Hex Nut         | Steel                   | 2 Nickel Plated                   |
| 3            | Metal           | Brass                   | 1 Nickel Plated                   |
| 2            | Lever           | Brass                   | 1 Chrome Plated                   |
| 1            | Lever           | ABS Resin               | 1 Red, Black, White, Yellow, Blue |
| Spa          | Part Name       | Material                | Qty. Finish                       |

|                                   |                                             |
|-----------------------------------|---------------------------------------------|
| Designed date                     | Checked J. Tsujimura date December 14, 1997 |
| Drawn K.E. dot date Dec. 16, 1997 | Approved J. Tsujimura date '97 Dec 17       |

|          |                          |                               |  |
|----------|--------------------------|-------------------------------|--|
| Name     | MS-500A-MF Toggle Switch |                               |  |
| Plan No. | MS500A-MF-J11            |                               |  |
| Scale=   | 1/1                      | All dimensions in millimeters |  |

Unless otherwise specified tolerances ± 0.5

| Specification         |                                                                                                                    |
|-----------------------|--------------------------------------------------------------------------------------------------------------------|
| Rating                | 6A.125V.AC                                                                                                         |
| Circuit               | SPDT ON-ON                                                                                                         |
| Contact Resistance    | 20mΩ or less, initial characteristics.                                                                             |
| Insulation Resistance | 500V.DC. Megger. 100MΩ or more.                                                                                    |
| Voltage Breakdown     | 1,000V.AC(Between terminals),<br>1,500V.AC(Between Live metal parts and<br>dead metal parts) 50/60Hz for 1 minute. |
| Durability            | Rated load with Resistance, 5,000 cycles,<br>Non-load, 30,000 cycles.                                              |

| Construction |                 |                         |      |                                    |
|--------------|-----------------|-------------------------|------|------------------------------------|
| 13           |                 |                         |      |                                    |
| 12           |                 |                         |      |                                    |
| 11           |                 |                         |      |                                    |
| 10           | Common Terminal | Copper                  | 1    | Silver Plated                      |
| 9            | Terminal        | Silver-clad copper      | 2    | Silver Plated                      |
| 8            | Body            | Melanine Phenolic Resin | 1    | Blue                               |
| 7            | Frame           | Stainless Steel         | 1    | Cleaning                           |
| 6            | Locking Ring    | Steel                   | 1    | Unichromate                        |
| 5            | Lock Washer     | Steel                   | 1    | Unichromate                        |
| 4            | Hex Nut         | Steel                   | 2    | Nickel Plated                      |
| 3            | Metal           | Brass                   | 1    | Nickel Plated                      |
| 2            | Lever           | Brass                   | 1    | Chrome Plated                      |
| 1            | Lever           | ABS Resin               | 1    | Red, Black, White,<br>Yellow, Blue |
| Syn.         | Part Name       | Material                | Qty. | Finish                             |

Black

|                                             |                                                 |
|---------------------------------------------|-------------------------------------------------|
| Designed date                               | Checked J. Tsujimura<br>date December. 16. 1997 |
| Drawn K. Endoh<br>date December. 16. 1997   | Approved J. Sarumi<br>date '97. Dec. 17         |
| Name                                        | MS-500A-MF Toggle Switch                        |
| Plan No.                                    | MS500A-MF-J11                                   |
| Scale= 1/1                                  | All dimensions in millimeters                   |
| Unless otherwise specified tolerances ± 0.5 |                                                 |