

SERIES 5000 - ROUND PUSHBUTTON SWITCHES

FOR AT LEAST 200 000 MECHANICAL SWITCHING CYCLES





PRODUCT FEATURES

- ◆ Attractive, round pushbutton switch
- ◆ Efficient contact system at least 200 000 mechanical switching cycles
- ◆ Variants with sealing cap for IP 54 dust and water protection
- ◆ Appliance cut-out with diameter 16 mm, alternatively with fixing pin

ON REQUEST

- ◆ Other colors
- ◆ Actuator printing
- ◆ Snap fastening for greater wall thickness
- ◆ Cable assembly

Mechanical life endurance	20E4
Proof tracking	250 PTI
Insulation spacing	acc. to EN 61058 for reinforced or double insulation
Protection type	IP 40 IP 54 (in variants with sealing cap)
Ambient temperature	connection side -20 °C ... +85 °C actuating side -20 °C ... +55 °C
Flammability	UL 94 V-2
Heat and fire resistance	850 °C (category D)
Material	actuator PA glass fiber-reinforced housing PA glass fiber-reinforced connections silver-plated
Type of fastening	snap fastening material thickness 1.4 - 1.7
Plug force of the terminals	≤ 64 N
Approval marks	 /  / 
Suitable for appliances of protection class II	



ROCKER SWITCHES

PUSHBUTTON SWITCHES

TOGGLE SWITCHES

SLIDE SWITCHES

ROTARY SWITCHES

FOOT SWITCHES

POWER TOOL SWITCHES

TACT AND KEY SWITCHES













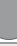

SNAP-ACTION SWITCHES

MICRO-SIGNAL SWITCHES

SENSORS

SERIES 5000 - ROUND PUSHBUTTON SWITCHES

FOR AT LEAST 200 000 MECHANICAL SWITCHING CYCLES

	Actuator color / printing	Housing color	4 (2) A 250 V AC 5E4	4 A 125 V AC 1/10 HP	2 A 250 V AC 1/10 HP	Connection type	Connection description	Contact distance in mm	Contact material	Pretravel max. in mm	Total travel / stroke in mm	Miscellaneous	Stock version
Normally open contact (SPNO)													
5000.0101			●	●	●		2.8	≈ 3	Ag	2.0 ± 0.4	4.0		●
5000.0103			●	●	●		2.8	≈ 3	Ag	2.0 ± 0.4	4.0		●
5000.0104			●	●	●		2.8	≈ 3	Ag	2.0 ± 0.4	4.0		●
5000.0212			●	●	●		2.8	≈ 3	Ag	2.0 ± 0.4	4.0		
5000.0501			●	●	●		2.8	≈ 3	Ag	2.0 ± 0.4	4.0	with IP 54 sealing cap	



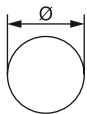

Basic type 5000



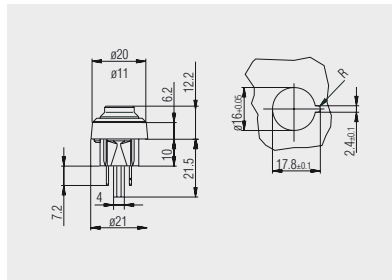

X = Wall thickness

X	Ø
1.4 ... 1.7	16.0 ^{+0.05}

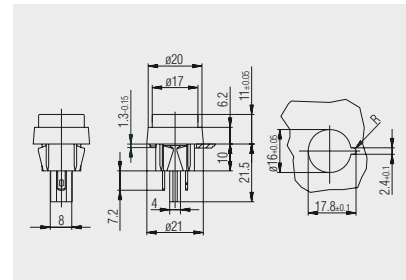

 Quick-connect terminal 2.8 (with fixing pin and IP 54 sealing cap), 5000.0501



 Quick-connect terminal 2.8 (with fixing pin) 5000.0212

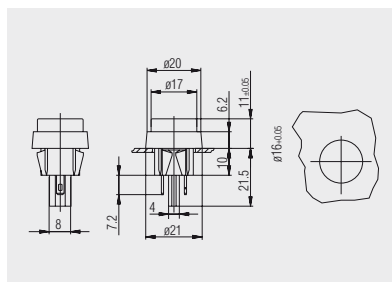

 Quick-connect terminal 2.8 5000.0101, 5000.0103 and 5000.0104