

SERIES 1010 - OPEN SNAP-ACTION SWITCHES

TO 10 (3) A 250 V DC



PRODUCT FEATURES

- ◆ Powerful snap-action switch with C-spring contact system according to design DIN 41635C
- ◆ High switching reliability due to large contact forces directly after switching
- ◆ Small size, large travel and difference travel
- ◆ Short bounce time
- ◆ Contact system insensitive to vibrations

ON REQUEST

- ◆ Extended overtravel
- ◆ Special base forms
- ◆ Special actuating cams
- ◆ In addition to a wide range of normally closed contacts, normally open contacts and changeover switches, bistable changeover switches (basic type 1011) and spring sets without snap function (basic type 1017) are available

Design	DIN 41635 C
Contact resistance (new condition)	< 100 mOhm (1 A 12 V DC)
Insulation resistance (new condition)	> 100 MOhm (500 V DC)
Voltage strength at 250 V	1 500 V function insulation / basic insulation 3 000 V reinforced insulation (depending on installation situation) 500 V small contact distance
Proof tracking	250 PTI
Insulation spacing	acc. to EN 61058 for reinforced or double insulation
Protection type	IP 00
Ambient temperature	-20 °C ... +85 °C ... +120 °C (basic type 1014 brief)
Flammability	UL 94 V-2
Heat and fire resistance	850 °C (category D)
Material	actuator: spring steel / PA glass fiber-reinforced / PA / metal (only 1017.0153) housing: PA glass fiber-reinforced / PA connections: silver-plated
Bounce time	< 5 ms
Approval marks	
Suitable for appliances of protection class II under compliance with the installation conditions required on the equipment side	



ROCKER SWITCHES

PUSHBUTTON SWITCHES

TOGGLE SWITCHES

SLIDE SWITCHES

ROTARY SWITCHES

FOOT SWITCHES

POWER TOOL SWITCHES

TACT AND KEY SWITCHES

SNAP-ACTION SWITCHES

MICRO-SIGNAL SWITCHES

SENSORS

SERIES 1010 - OPEN SNAP-ACTION SWITCHES

TO 10 (3) A 250 V DC

	10 (3) A 250 V AC 1E4	6 (2) A 250 V AC 25E3	2 (0.5) A 250 V AC 20E4	2 (0.5) A 250 V AC 5E4	2 A 12 V DC 10E4	1 A 24 V DC 10E4	0.5 A 15 V 5E4	0.1 A 24 V DC 50E4	Connection type	Connection description	Contact material	Operating force in N	Operating position (OP) in mm	Difference travel max. in mm	Free position (FP) max. in mm	Permissible total travel position (TP) in mm	Actuator description	Mechanical life endurance	Miscellaneous	Stock version
Normally closed contact (SPNC)																				
1010.7601			●							9.5 long	Ag	0.25 - 0.6	2.2 ±0.6	0.9	0.4	3.5		1E6		
Normally open contact (SPNO)																				
1010.7401			●							9.5 long	Ag	0.25 - 0.6	2.2 ±0.6	0.9	0.4	3.5		1E6		
1010.7402			●							9.5 long	Ag	0.45 - 1.05	2.2 ±0.6	0.9	0.4	3.5		1E6		
1017.0801							●			9.2 long	Ag	0.15 - 0.5	2.2 ±0.6		0	3.2		1E6	without approval mark	●
1017.0851							●			9.2 long	Au	0.15 - 0.5	2.2 ±0.6		0	3.2		1E6	without approval mark	
1017.5701							●				CuSn silver-plated	0.15 - 0.5	1.4 ±0.6		3.6	0.4		1E6	without approval mark	
Switch (SPDT)																				
1011.5101	●										Ag	0.2 - 0.7						20E4	bistable snap-action switches without approval mark	
Changeover switch (SPDT momentary)																				
1010.7332	●									9.5 long	Ag	0.45 - 1.05	2.2 ±0.6	0.9	0.4	3.5		10E4		
1010.9705		●	●								Au	0.45 - 1.05	3.8 ±0.6	0.9	6.6	2		10E4		
1010.9752		●	●								Ag	0.45 - 1.05	6.9 ±0.6	0.9	9.7	5.1		10E4		●
1010.9802		●	●								Ag	0.45 - 1.05	3.8 ±0.6	0.9	6.6	2		10E4		
1010.9852		●	●								Ag	0.45 - 1.05	6.9 ±0.6	0.9	9.7	5.1		10E4		●
1010.0101			●							6.5 long	Ag	0.25 - 0.6	2.2 ±0.6	0.9	0.4	3.5		1E6	without approval mark	●
1010.4103			●							straight	Au	0.25 - 0.6	2.2 ±0.6	0.9	0.4	3.5		1E6	without approval mark	
1010.4402			●							straight	Ag	0.25 - 0.6	1.3 ±0.6	0.9	4.1	0		1E6	without approval mark small base	●
1010.7102			●							6.5 long	Ag	0.45 - 1.05	2.2 ±0.6	0.9	0.4	3.5		1E6	without approval mark	●
1010.7172			●							6.5 long	Au	0.45 - 1.05	0.9 ±0.6	0.9	3.6	0.2		1E6	without approval mark	
1010.8102			●							straight	Ag	0.45 - 1.05	2.2 ±0.6	0.9	0.4	3.5		1E6	without approval mark	●
1010.0304			●							9.5 long	Ag	0.25 - 0.6	2.2 ±0.6	0.9	0.4	3.5		1E6		●
1010.2003			●							9.5 long	Au	0.45 - 1.05	2.2 ±0.6	0.9	0.4	3.5		1E6		
1010.3901			●							9.5 long	Ag	0.25 - 0.6	0.9 ±0.6	0.9	3.6	0.2		1E6		
1010.6002			●							standing	Au	0.45 - 1.05	11.2 ±0.6	0.9	13.8	9.9		1E6		●
1010.6003			●							standing	Ag	0.25 - 0.6	11.2 ±0.6	0.9	13.8	9.9		1E6		●
1010.7302			●							9.5 long	Ag	0.45 - 1.05	2.2 ±0.6	0.9	0.4	3.5		1E6		
1010.7352			●							9.5 long	Ag	0.45 - 1.05	0.9 ±0.6	0.9	3.6	0.2				

ROCKER SWITCHES

PUSHBUTTON SWITCHES

TOGGLE SWITCHES

SLIDE SWITCHES

ROTARY SWITCHES

FOOT SWITCHES

POWER TOOL SWITCHES

TACT AND KEY SWITCHES



SNAP-ACTION SWITCHES

MICRO SIGNAL SWITCHES

SENSORS

SERIES 1010 - OPEN SNAP-ACTION SWITCHES

TO 10 (3) A 250 V DC

	10 (3) A 250 V AC 1E4	6 (2) A 250 V AC 25E3	2 (0.5) A 250 V AC 20E4	2 (0.5) A 250 V AC 5E4	2 A 12 V DC 10E4	1 A 24 V DC 10E4	0.5 A 15 V 5E4	0.1 A 24 V DC 50E4	Connection type	Connection description	Contact material	Operating force in N	Operating position (OP) in mm	Difference travel max. in mm	Free position (FP) max. in mm	Permissible total travel position (TP) in mm	Actuator description	Mechanical life endurance	Miscellaneous	Stock version
Changeover switch (SPDT momentary)																				
1014.6151					● ●				⌋	standing	Au	0.3 - 0.8	6.6 ±0.5	0.6	8.6	5.3		50E4	without approval mark	
Changeover switch with OFF position in the center (SPDT momentary - Center OFF)																				
1017.0153						●				9.2 long	Au		≤ 2.1		0	2.6		1E6	operating range max. 4.2	

Further information under

WWW.MARQUARDT.DE

ROCKER SWITCHES

PUSHBUTTON SWITCHES

TOGGLE SWITCHES

SLIDE SWITCHES

ROTARY SWITCHES

FOOT SWITCHES

POWER TOOL SWITCHES

TACT AND KEY SWITCHES

SNAP-ACTION SWITCHES

MICRO-SIGNAL SWITCHES

SENSORS

SERIES 1010 - OPEN SNAP-ACTION SWITCHES

TO 10 (3) A 250 V DC



Basic type 1010

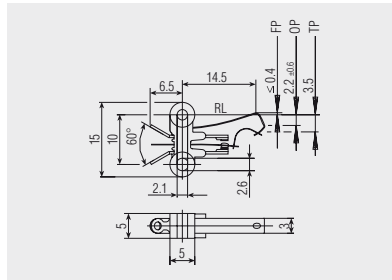

Solder terminal 30° angled
6.5 long

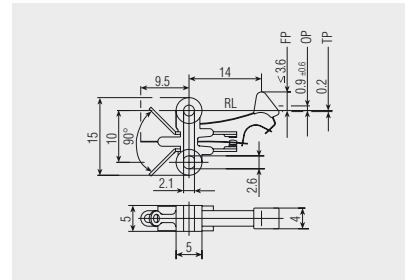

Solder terminal 45° angled
9.5 long

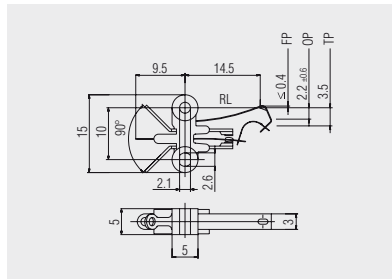

Solder terminal 45° angled
9.5 long

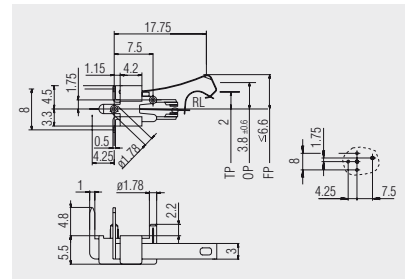

PCB terminal left angled

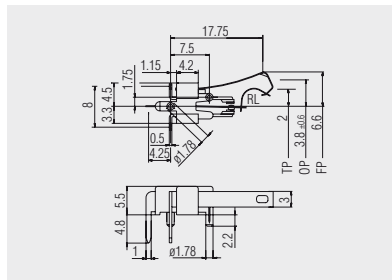

PCB terminal right angled
1010.9802

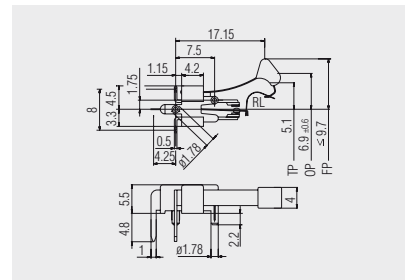

PCB terminal right angled
1010.9852

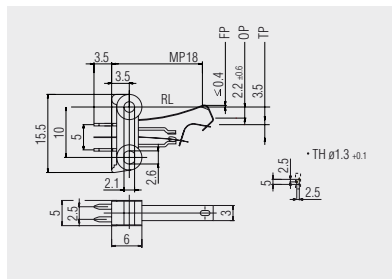

PCB terminal straight

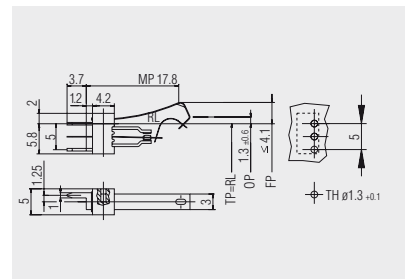

PCB terminal straight



Basic type 1010

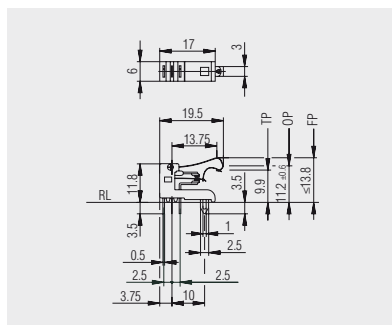

PCB terminal vertical:
A switch actuation vertical to the PCB
can be implemented in a confined
space with this version.

ROCKER SWITCHES

PUSHBUTTON SWITCHES

TOGGLE SWITCHES

SLIDE SWITCHES

ROTARY SWITCHES

FOOT SWITCHES

POWER TOOL SWITCHES

TACT AND KEY SWITCHES

SNAP-ACTION SWITCHES

MICRO SIGNAL SWITCHES

SENSORS

