

Separate units: Blocks

IP 20
To be combined with a 1, 3 or 5 position clip (p. 65)

 Characteristics (p. 94)
Cross reference list (p. 311)

► SPECIFIC BLOCKS

FOR JOYSTICKS (SCREW TERMINALS)

Cat. No.

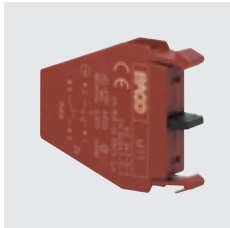

LM11

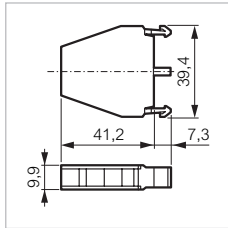

Joysticks (p. 36)

NO - NC



LM11

LAMP-TEST BLOCKS (SCREW TERMINALS)



33ET

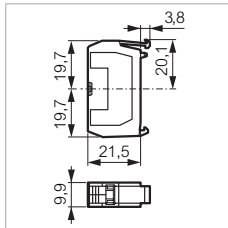

For 24 and 48 V

1 diod

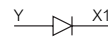

33ET

2 diods

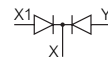

33ETT

For 130 and 230 V (form p. 79)

TRANSFORMER BLOCKS (SCREW TERMINALS)



33EHC

230/24 V
400/24V

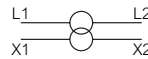

33EHC
33ELC

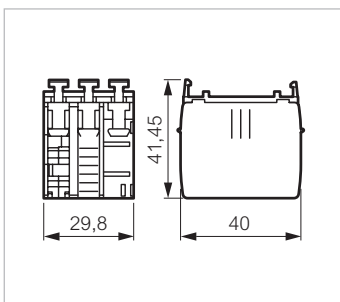

Catalogue No. in bold: normally in stock at distribution outlets