

Technical datasheet: KPI-G4510L-K6311

Specifications:

Operating Temperature	-20°C to +60°C
Storage Temperature	-30°C to +70°C
Rated Voltage	12VDC
Allowable Voltage	3 V-16VDC
Sound Pressure Level	100dB at 12VDC/30cm
Resonant Frequency	3.2KHz±0.KHz
Max Rated Current	35mA at 12VDC
Weight	21g
Case Material/Color	ABS/White
Tone Nature	Continues

Dimensions:

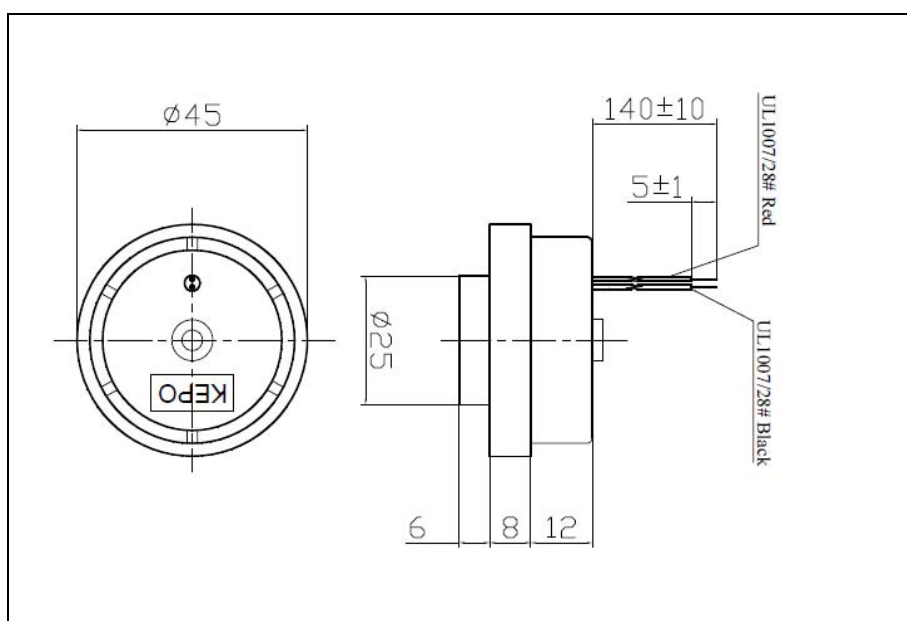

Frequency Response:

