

Technical datasheet: KP2848SP1F-5836

Specifications:

Input power	Rated 0.5W / Max. 1.0W
Impedance	$8\Omega \pm 15\% \Omega$ (1Vrms at 1KHz)
Frequency Range	0Hz to 6.5kHz
Resonant Frequency	$650\text{Hz} \pm 104\text{Hz}$
Distortion	<5% Max. at 1kHz/1Vrms
Out-diameter	$\varnothing 28\text{mm}$
Height	4.8mm
Weight	5.4g
SPL	$80\text{dB} \pm 3\text{dB}$ (0.25W,0.5M; at 800,1000,1200,1500Hz)
Buzz and Rattle	No audible buzzes, rattles when 2.0V sine wave signal is swept at frequency range.

Dimensions:

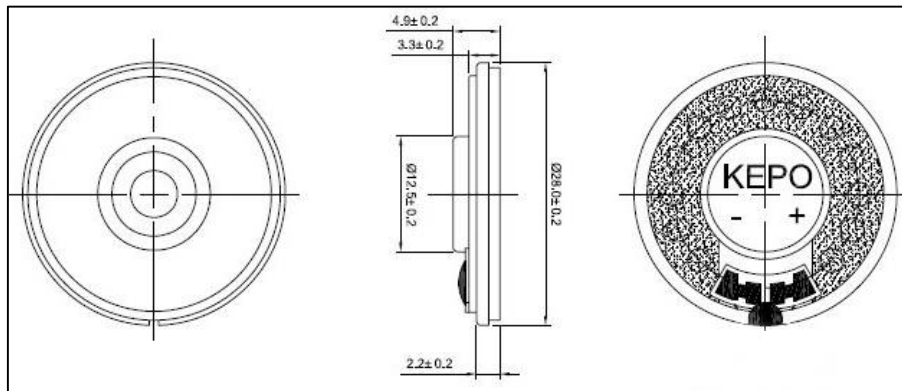

Frequency Response:

