

# Datasheet

Item no. 718117

V1\_0717\_01\_en

## Pushbutton Switches

### Characteristic

#### Specs

Having three head shape: round ( $\Phi 18\text{mm}$ ), square ( $18 \times 18\text{mm}$ ) and rectangular ( $18 \times 24\text{mm}$ ), containing pilot lamps, pushbuttons, illuminated push buttons, selector switches, key-lock switches, buzzer and emergency switches. The normal diameter of the installation hole is  $\Phi 16\text{mm}$ , and some type can be installed in  $\Phi 22\text{mm}$  hole easily with the diameter changing circle.

#### Functions

The product has stable property, small contact resistance, strong insulation resistance, anti-vibration and so on. It meets to standards of IEC60947-5-1, GB14048.5 etc.

#### Structure

The switch have the advantage of fast-break and self-cleaning, and each of them contains 1NO and 1NC terminal. Every pushbutton also can possess from one to two switch units.

#### Protective Degree

Its protective degree is IP40, IP65, some of type can reach IP67 with the seal cover.

### Lamp Ratings

Lamp Type	AC LED Lamp (Standard)			Neon Lamp	
Rated Voltage	AC/DC6V	AC/DC12V	AC/DC24V	AC110V	AC230V
	AC/DC110V		AC/DC230V		
Cover Color:	<div><div>R</div><div>G</div><div>Y</div><div>O</div><div>B</div><div>W</div></div>			<div><div>R</div><div>G</div></div>	
Life	About 40,000 hours			About 20,000 hours	

Note: the lamp contains a current-limiting resistor inside and doesn't need external connection.

DC LED lamp, dual-color LED lamp and other voltages can be customized.

### Switch Ratings

Thermal Current I <sub>th</sub>		5A		
Rated Voltage		24V	125V (110V)	250V (230V)
Direct Current		1A	0.2A	0.1A
Alternating Current	P.F=1		5A	3A
	P.F=0.7		3A	2A

### Specifications

Operating Temperature			- 25℃ ~ +55℃(no freezing)
Operating Humidity			45 ~ 85%RH(no condensation)
Contact Material			- silver - silver alloy - gold -clad silver, cladding thickness is 3 μm
Contact Resistance			≤50MΩ
Insulation Resistance			≥100MΩ
Dielectric strength	Between contact and lamp terminals :		2000V, A C 50Hz, 1 min
	Between terminal of the same pole:		1000V, A C 50Hz, 1 min
	Between terminal of different pole:		2000V, A C 50Hz, 1 min
Vibration Resistance			50Hz, Amplitude 1.2mm p - p
Shock Resistance			≥10g
Life	Mechanical	Momentary Type	1,000,000times
		Alternate and Selector Type	500,000 times
		Key-lock and Emergency Type	200,000 times
	Electrical		≥50,000times
Terminal			Diameter of welded wire:2×0.8mm Area of copper wire: 0.75 mm2 max Connecting link: 2.8×0.5 mm
Solder Heat Resistance			230℃(no more than 3 second)
Operating Travel			(Pushbuttons) about 3mm

### Installation Dimensions

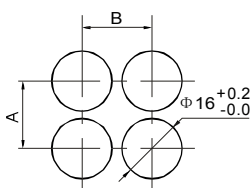

Category	A	B
Round	≥18mm	≥18mm
Square	≥18mm	≥18mm
Rectangular	≥18mm	≥24mm
Mushroom	≥24mm	≥24mm
Big square	≥24mm	≥24mm
Big rectangular	≥18mm	≥24mm

### Bottom View

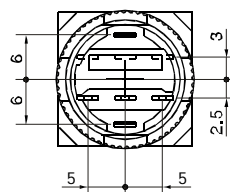

### Terminal Arrangement

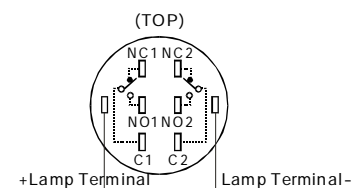

## Buzzer Units

## Specifications

<b>Operating Temperature</b>	- 25°C ~ 55°C
<b>Operating Humidity</b>	45 ~ 85%RH
<b>Dielectric Strength</b>	1000V
<b>Sound Duration</b>	Continuous, Discontinuous
<b>Rated Sound Pressure &amp; Frequency</b>	75dB(1m)(Rated Voltage) 2300 ± 300Hz
<b>Operating Voltage</b>	6VDC;12VDC;24VDC; 110VAC;230VAC
<b>Rated Operating Current:</b>	≤28 mA

## Shape and Dimensions

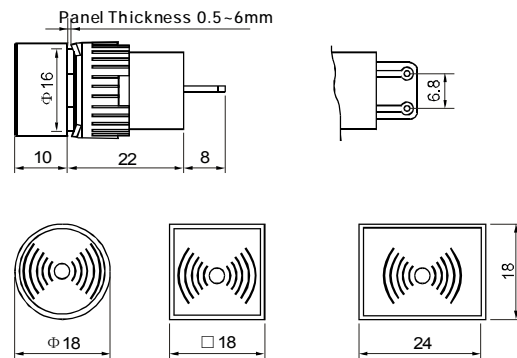

## Product Cutline

Type Number	718117
Shape	

718117 : Round Buzzer, 12V/DC, 6.75g (included rubber ring), Ø 18.4 x 39.6 mm, Ø 15.7mm (at the screw thread), 33 mA (at DC12V), IP40

This is a publication by Conrad Electronic SE, Klaus-Conrad-Str. 1, D-92240 Hirschau ([www.conrad.com](http://www.conrad.com)).

All rights including translation reserved. Reproduction by any method, e.g. photocopy, microfilming, or the capture in electronic data processing systems require the prior written approval by the editor. Reprinting, also in part, is prohibited. This publication represents the technical status at the time of printing.

© Copyright 2017 by Conrad Electronic SE.